

WATER WELL PLUGGING RECORD Form WWC-5P KSA 82a-1212 ID NO

0041729

1 LOCATION OF WATER WELL: Fraction ¼ NW ¼ SW ¼ NE ¼ Section Number 28 Township Number T 7 S
 County: Riley Range Number 6 E W

Street/Rural Address of Well Location; if unknown, distance & direction from nearest town or intersection: If at owner's address, check here
13700 Tuttle Creek Blvd., Randolph
Global Positioning Systems (GPS) information:
 Latitude: _____ Longitude: _____
 Elevation: _____ Datum: WGS84, NAD83 NAD27
 Collection Method: GPS unit (Make/Model: _____)
 Digital Map/Photo, Topographic map, Land Survey

2 WATER WELL OWNER: Leiszler Oil Company
 RR#, St. Address, Box #: 635 W. Crawford
 City, State ZIP Code: Clay Center, KS 67432
 Est. Accuracy: < 3 m, 3-5 m, 5-15 m, > 15 m

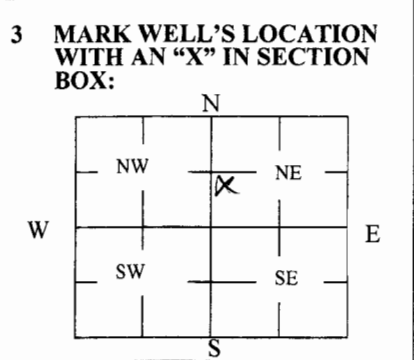

4 DEPTH OF WELL 73 ft.
 WELL'S STATIC WATER LEVEL 52.65 ft
 WELL WAS USED AS:
 Domestic Public Water Supply Drilling
 Irrigation Oil Field Water Supply Monitoring
 Feedlot Domestic (Lawn & Garden) Injection Well
 Industrial Air Conditioning Other _____
 Was a chemical/bacteriological sample submitted to Department of Health and Environment? Yes No

5 TYPE OF BLANK CASING USED:
 Steel RMP (SR) Wrought Fiberglass Other (Specify below)
 PVC ABS Asbestos-Cement Concrete Tile
 Blank casing diameter 2 in. Was casing pulled? Yes No If yes, how much 3'
 Casing height above or below land surface 0 in.

6 GROUT PLUG MATERIAL: Neat cement Cement grout Bentonite Other _____
 Grout Plug Intervals: From 3 ft. to 73 ft., From _____ ft. to _____ ft., From _____ to _____ ft.

What is the nearest source of possible contamination:
 Septic tank Sewage pit Fuel Storage Other (specify below)
 Sewer lines Pit privy Fertilizer storage
 Watertight sewer lines Sewage lagoon Insecticide storage
 Lateral lines Feedyard Abandoned water well Direction from well? _____
 Cess pool Livestock pens Oil well/Gas well How many feet? _____

FROM	TO	PLUGGING MATERIALS	FROM	TO	PLUGGING MATERIALS
0	3	Native soil			
3	73	Bentonite (2')			
					MW6

7 CONTRACTOR'S OR LANDOWNER'S CERTIFICATION: This water well was plugged under completed on (mo/day/year) 4/28/2010 and this record is true to the best of my knowledge
 Well Contractor's License No. 527. This Water Well Record was completed on (mo/day/year) 3/2010
 business name of GeoCore Inc. by (signature) [Signature]

INSTRUCTIONS: Use typewriter or ballpoint pen. Please press firmly and print clearly. Please fill in blank correct answers. Send top three copies to Kansas Department of Health and Environment, Bureau of Water, Geology Section, 1000 SW Jackson St., Ste. 420, Topeka, Kansas 66612-1367. Telephone: 785/296-5524. Send one to Water Well Owner and retain one for your records. Visit us at <http://www.kdheks.gov/waterwell/index.html>.

Check one: White Copy Blue Copy Pink Copy