

WATER WELL PLUGGING RECORD Form WWC-5P

KSA 82a-1212 ID NO.

MW5

1 LOCATION OF WATER WELL: Fraction NW 1/4 NW 1/4 SW 1/4 NE 1/4 Section Number 23 Township Number T 07 S Range Number 07 E W
 County: Pottawatomie

Street/Rural Address of Well Location; if unknown, distance & direction from nearest town or intersection: If at owner's address, check here Along alley west of Northwest corner of 2nd & Elm, Olsburg, KS

Global Positioning Systems (GPS) information:
 Latitude: 39.43209 (in decimal degrees)
 Longitude: 96.61567 (in decimal degrees)
 Elevation: 1426.42 TOC
 Horizontal Datum: WGS84, NAD83, NAD27
 Collection Method:

2 WATER WELL OWNER: KDHE BER
 RR#, St. Address, Box #: 1000 SW Jackson St.
 City, State ZIP Code: Topeka, KS 66612

GPS unit (Make/Model: _____)
 Digital Map/Photo, Topographic Map, Land Survey
 Est. Accuracy: < 3 m, 3-5 m, 5-15 m, > 15 m

3 MARK WELL'S LOCATION WITH AN "X" IN SECTION BOX:

4 DEPTH OF WELL 74.97 ft.
 WELL'S STATIC WATER LEVEL 61.22 ft

WELL WAS USED AS:

<input type="checkbox"/> Domestic	<input type="checkbox"/> Public Water Supply	<input type="checkbox"/> Dewatering
<input type="checkbox"/> Irrigation	<input type="checkbox"/> Oil Field Water Supply	<input type="checkbox"/> Monitoring
<input type="checkbox"/> Feedlot	<input type="checkbox"/> Domestic (Lawn & Garden)	<input checked="" type="checkbox"/> Injection Well
<input type="checkbox"/> Industrial	<input type="checkbox"/> Air Conditioning	<input type="checkbox"/> Other _____

Was a chemical/bacteriological sample submitted to Department? Yes No

5 TYPE OF BLANK CASING USED:

<input type="checkbox"/> Steel	<input type="checkbox"/> RMP (SR)	<input type="checkbox"/> Wrought	<input type="checkbox"/> Fiberglass	<input type="checkbox"/> Other (Specify below) _____
<input checked="" type="checkbox"/> PVC	<input type="checkbox"/> ABS	<input type="checkbox"/> Asbestos-Cement	<input type="checkbox"/> Concrete Tile	

Blank casing diameter 2 in. Was casing pulled? Yes No If yes, how much 3 ft
 Casing height above or below land surface 36 in.

6 GROUT PLUG MATERIAL: Neat cement Cement grout Bentonite Other _____

Grout Plug Intervals: From 3 ft. to 74.97 ft., From _____ ft. to _____ ft., From _____ ft. to _____ ft.

What is the nearest source of possible contamination:

<input type="checkbox"/> Septic tank	<input type="checkbox"/> Seepage pit	<input type="checkbox"/> Fuel storage	<input checked="" type="checkbox"/> Other (specify below) _____
<input type="checkbox"/> Sewer lines	<input type="checkbox"/> Pit privy	<input type="checkbox"/> Fertilizer storage	<u>D&K Service U4-075-00141</u>
<input type="checkbox"/> Watertight sewer lines	<input type="checkbox"/> Sewage lagoon	<input type="checkbox"/> Insecticide storage	
<input type="checkbox"/> Lateral lines	<input type="checkbox"/> Feedyard	<input type="checkbox"/> Abandoned water well	Direction from well? <u>SE</u>
<input type="checkbox"/> Cess pool	<input type="checkbox"/> Livestock pens	<input type="checkbox"/> Oil well/Gas well	How many feet? <u>~950</u>

FROM	TO	PLUGGING MATERIALS	FROM	TO	PLUGGING MATERIALS
0	3	Compacted silt/clay			
3	74.97	Hydrated Bentonite chips			
					Former Conoco U4-075-13096

7 CONTRACTOR'S OR LANDOWNER'S CERTIFICATION: This water well was plugged under my jurisdiction and was completed on (mo/day/year) 2-21-19 and this record is true to the best of my knowledge and belief. Kansas Water Well Contractor's License No. 585. This Water Well Record was completed on (mo/day/year) 2-28-19 under the business name of Associated Environmental, Inc. by (signature) [Signature]

Send one white copy to Kansas Department of Health & Environment, Geology Section, 1000 SW Jackson Street, Ste. 420, Topeka, KS 66612-1367. Send one copy to WATER WELL OWNER and retain one for your records.
 Visit us at <http://www.kdheks.gov/waterwell/index.html> Telephone 785-296-5524.

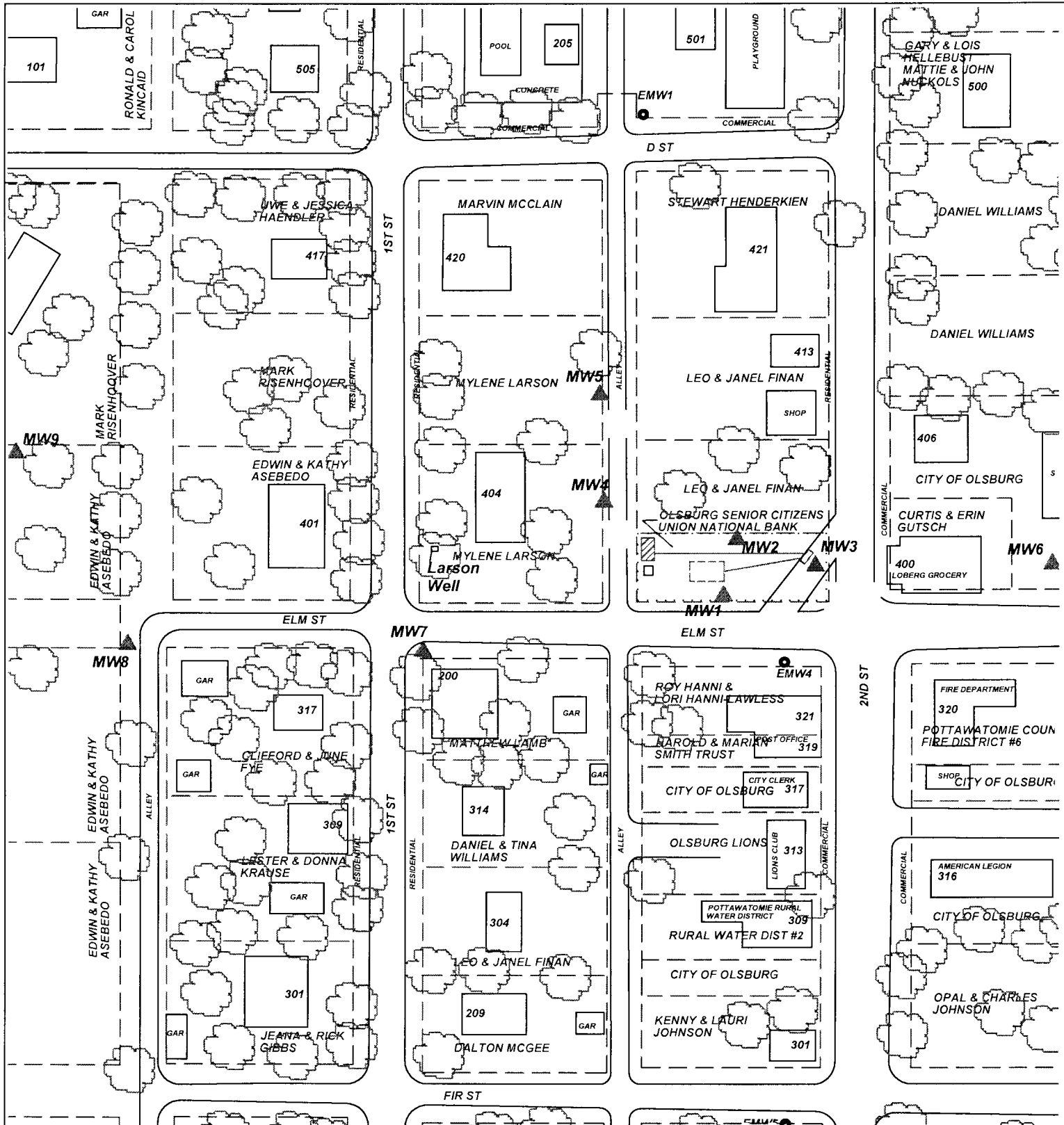

PROJECT: **FORMER CONOCO**

ADDRESS: **NW CORNER OF 2ND & ELM**

LOCATION: **OLSBURG, KANSAS**

DRAWN BY: **B. STALNAKER** DATE: **6/15/17**







REVISED BY: **B. STALNAKER** DATE: **10/25/17**

AEI JOB # **TM 228** KDHE JOB # **U4-075-13096**

TITLE:



ASSOCIATED ENVIRONMENTAL INC.

- LEGEND:
-  = FORMER 8,000 GAL. GAS AST LOCATION
 -  = FORMER 1,000 GAL. GAS UST LOCATION
 -  = FORMER PUMP ISLAND AND LINES
 -  = MONITOR WELL
 -  = EXISTING MONITOR WELL (D&K SERVICE, U4-075-00141)
 -  = SUBJECT PROPERTY
 -  = PARCEL BOUNDARY

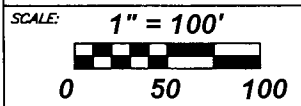

NOTES:
No basements observed within 500'.