

**WATER WELL PLUGGING RECORD Form WWC-5P**

KSA 82a-1212 ID NO.

MW8

**1 LOCATION OF WATER WELL:** Fraction NE 1/4 NE 1/4 SE 1/4 NW 1/4 Section Number 23 Township Number T 07 S Range Number 07  E  W  
 County: Pottawatomie  
 Street/Rural Address of Well Location; if unknown, distance & direction from nearest town or intersection: If at owner's address, check here  East end of Elm street, Olsburg, KS  
**Global Positioning Systems (GPS) information:**  
 Latitude: 39.43155 (in decimal degrees)  
 Longitude: 96.61697 (in decimal degrees)  
 Elevation: 1411.13 TOC  
 Horizontal Datum:  WGS84,  NAD83,  NAD27  
 Collection Method:

**2 WATER WELL OWNER:** KDHE BER  
 RR#, St. Address, Box #: 1000 SW Jackson St.  
 City, State ZIP Code: Topeka, KS 66612  
 GPS unit (Make/Model): \_\_\_\_\_  
 Digital Map/Photo,  Topographic Map,  Land Survey  
 Est. Accuracy:  < 3 m,  3-5 m,  5-15 m,  > 15 m

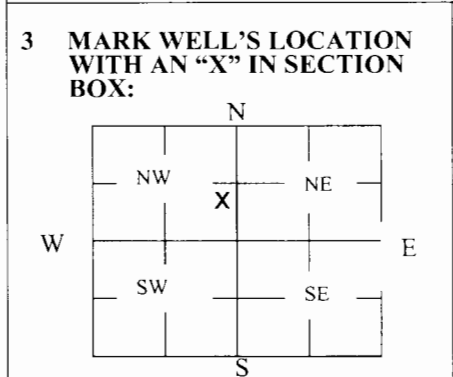

**4 DEPTH OF WELL** 74.97 ft.  
 WELL'S STATIC WATER LEVEL 46.34 ft.  
 WELL WAS USED AS:  
 Domestic  Public Water Supply  Dewatering  
 Irrigation  Oil Field Water Supply  Monitoring  
 Feedlot  Domestic (Lawn & Garden)  Injection Well  
 Industrial  Air Conditioning  Other \_\_\_\_\_  
 Was a chemical/bacteriological sample submitted to Department? Yes  No

**5 TYPE OF BLANK CASING USED:**  
 Steel  RMP (SR)  Wrought  Fiberglass  Other (Specify below) \_\_\_\_\_  
 PVC  ABS  Asbestos-Cement  Concrete Tile  
 Blank casing diameter 2 in. Was casing pulled? Yes  No  If yes, how much 3 ft  
 Casing height above or below land surface 36 in.

**6 GROUT PLUG MATERIAL:**  Neat cement  Cement grout  Bentonite  Other \_\_\_\_\_  
 Grout Plug Intervals: From 3 ft. to 74.97 ft., From \_\_\_\_\_ ft. to \_\_\_\_\_ ft., From \_\_\_\_\_ ft. to \_\_\_\_\_ ft.  
 What is the nearest source of possible contamination:  
 Septic tank  Seepage pit  Fuel storage  Other (specify below) D&K Service U4-075-00141  
 Sewer lines  Pit privy  Fertilizer storage  
 Watertight sewer lines  Sewage lagoon  Insecticide storage  
 Lateral lines  Feedyard  Abandoned water well Direction from well? SE  
 Cess pool  Livestock pens  Oil well/Gas well How many feet? ~1100

FROM	TO	PLUGGING MATERIALS	FROM	TO	PLUGGING MATERIALS
0	3	Compacted silt/clay			
3	74.97	Hydrated Bentonite chips			
					Former Conoco U4-075-13096

**7 CONTRACTOR'S OR LANDOWNER'S CERTIFICATION:** This water well was plugged under my jurisdiction and was completed on (mo/day/year) 2-21-19 and this record is true to the best of my knowledge and belief. Kansas Water Well Contractor's License No. 585. This Water Well Record was completed on (mo/day/year) 2-28-19 under the business name of Associated Environmental, Inc. by (signature) [Signature]

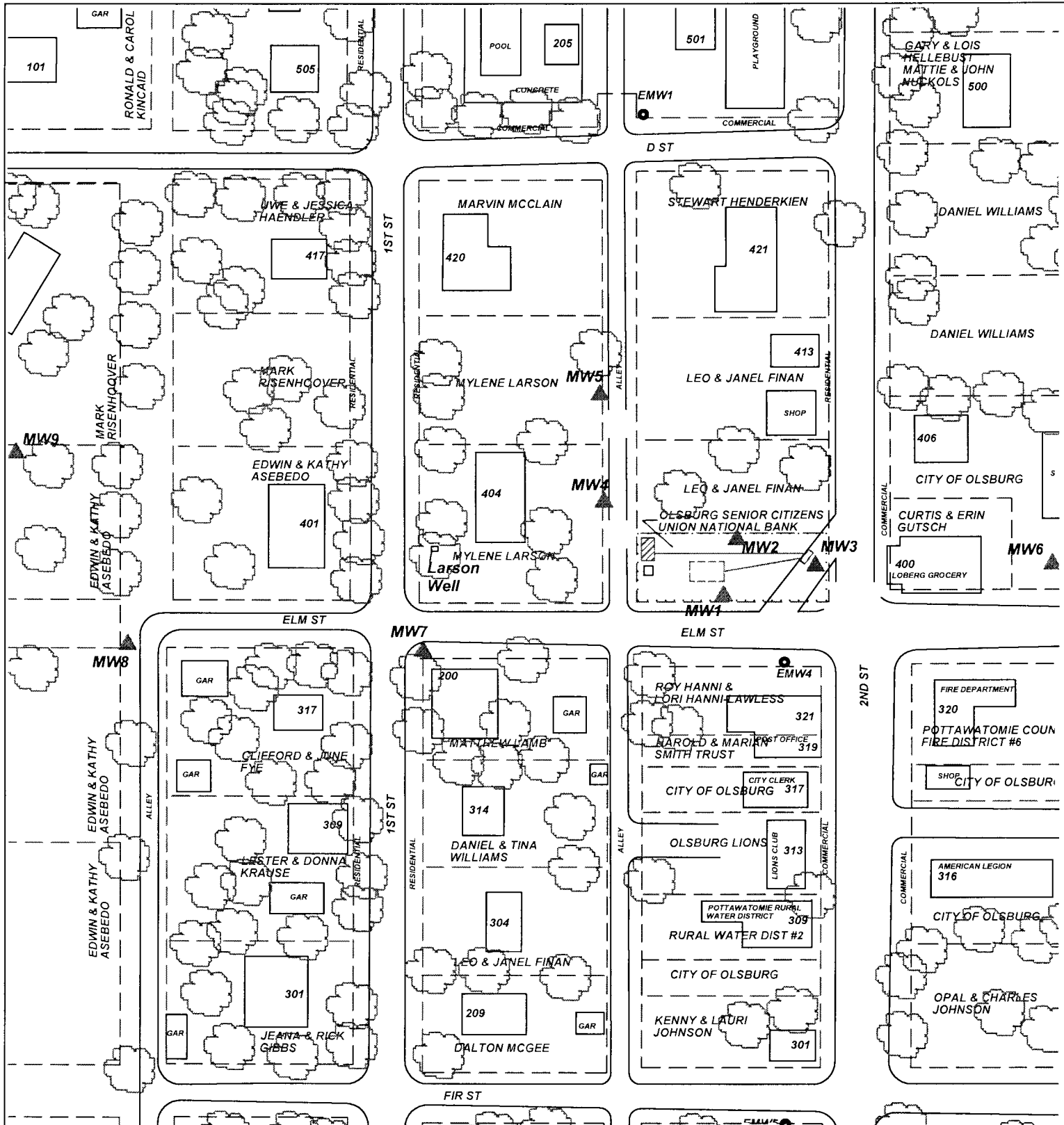

PROJECT: **FORMER CONOCO**

ADDRESS: **NW CORNER OF 2ND & ELM**

LOCATION: **OLSBURG, KANSAS**

DRAWN BY: **B. STALNAKER** DATE: **6/15/17**

REVISED BY: **B. STALNAKER** DATE: **10/25/17**

AEI JOB # **TM 228** KDHE JOB # **U4-075-13096**

TITLE:

**ASSOCIATED ENVIRONMENTAL INC.**

LEGEND:

- = FORMER 8,000 GAL. GAS AST LOCATION
- = FORMER 1,000 GAL. GAS UST LOCATION
- = FORMER PUMP ISLAND AND LINES
- = MONITOR WELL
- = EXISTING MONITOR WELL (D&K SERVICE, U4-075-00141)
- = SUBJECT PROPERTY
- = PARCEL BOUNDARY

SCALE: **1" = 100'**

NOTES:  
No basements observed within 500'.