

WATER WELL RECORD

Form WWC-5

Division of Water Resources App. No.

Empty box for application number

1 LOCATION OF WATER WELL: County: Nemaha, Fraction: 1/4 SE 1/4 SE 1/4 SE 1/4, Section Number: 16, Township No. T 8 S, Range Number R 12 E W

Street/Rural Address of Well Location; if unknown, distance & direction from nearest town or intersection: Eisenbarth Plumbing (Scott Carlson), RR#, Street Address, Box #: 13 N 2nd St, City, State, ZIP Code: Seneca, KS 66538

2 WATER WELL OWNER: Eisenbarth Plumbing (Scott Carlson), RR#, Street Address, Box #: 13 N 2nd St, City, State, ZIP Code: Seneca, KS 66538

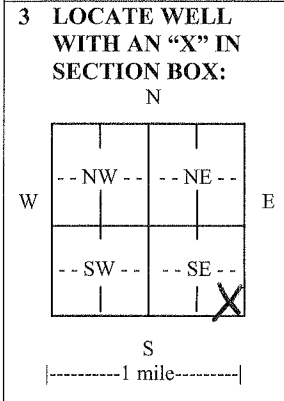

4 DEPTH OF COMPLETED WELL: 200 ft. Depth(s) Groundwater Encountered (1) 33 ft. (2) - ft. (3) - ft. WELL'S STATIC WATER LEVEL: - ft. below land surface measured on mo/day/yr. Pump test data: Well water was - ft. after - hours pumping - gpm. EST. YIELD: - gpm. Well water was - ft. after - hours pumping - gpm. Bore Hole Diameter: 6 in. to 200 ft., and - in. to - ft. WELL WATER TO BE USED AS: [ ] Public water supply [X] Geothermal [ ] Injection well [ ] Domestic [ ] Feedlot [ ] Oil field water supply [ ] Dewatering [ ] Other (Specify below) [ ] Irrigation [ ] Industrial [ ] Domestic-lawn & garden [ ] Monitoring well. Was a chemical/bacteriological sample submitted to Department? [ ] Yes [X] No. If yes, mo/day/yr sample was submitted. Water well disinfected? [ ] Yes [X] No

5 TYPE OF CASING USED: [ ] Steel [ ] PVC [X] Other: HDPE. CASING JOINTS: [ ] Glued [ ] Clamped [X] Welded [ ] Threaded. Casing diameter: 3/4 in. to 200 ft., Diameter - in. to - ft., Diameter - in. to - ft. Casing height above land surface: 60 in., Weight - lbs./ft., Wall thickness or gauge No. 5DR11

TYPE OF SCREEN OR PERFORATION MATERIAL: [ ] Steel [ ] Stainless Steel [ ] PVC [ ] Other (Specify) [ ] Brass [ ] Galvanized Steel [ ] None used (open hole). SCREEN OR PERFORATION OPENINGS ARE: [ ] Continuous slot [ ] Mill slot [ ] Gauze wrapped [ ] Torch cut [ ] Drilled holes [ ] None (open hole) [ ] Louvered shutter [ ] Key punched [ ] Wire wrapped [ ] Saw cut [ ] Other (specify). SCREEN-PERFORATED INTERVALS: From - ft. to - ft., From - ft. to - ft., From - ft. to - ft. GRAVEL PACK INTERVALS: From - ft. to - ft., From - ft. to - ft., From - ft. to - ft.

6 GROUT MATERIAL: [ ] Neat cement [ ] Cement grout [X] Bentonite [ ] Other. Grout Intervals: From 5 ft. to 200 ft., From - ft. to - ft., From - ft. to - ft. What is the nearest source of possible contamination: [ ] Septic tank [ ] Lateral lines [ ] Pit privy [ ] Livestock pens [ ] Insecticide storage [ ] Other (specify below) [ ] Sewer lines [ ] Cesspool [ ] Sewage lagoon [ ] Fuel storage [ ] Abandoned water well [ ] Watertight sewer lines [ ] Seepage pit [ ] Feedyard [ ] Fertilizer storage [ ] Oil well/gas well. Direction from well: EAST, Distance from well: 18

Table with 6 columns: FROM, TO, LITHOLOGIC LOG, FROM, TO, LITHO. LOG (cont.) or PLUGGING INTERVALS. Rows show geological layers: CLAY (0-10), SAND (10-33), GRAVEL (33-38), Shale (38-121), Limestone (121-127), Shale (127-144), Limestone (144-145), Shale (145-156), Limestone (156-175), Shale (175-188).

7 CONTRACTOR'S OR LANDOWNER'S CERTIFICATION: This water well was [X] constructed, [ ] reconstructed, or [ ] plugged under my jurisdiction and was completed on (mo/day/year) 4/22/2010 and this record is true to the best of my knowledge and belief. Kansas Water Well Contractor's License No. 760. This Water Well Record was completed on (mo/day/year) 10-15-2010 under the business name of Associated Drilling, Inc. by (signature) [Signature]

INSTRUCTIONS: Use typewriter or ball point pen. PLEASE PRESS FIRMLY and PRINT clearly. Please fill in blanks and check the correct answers. Send three copies (white, blue, pink) to Kansas Department of Health and Environment, Bureau of Water, Geology Section, 1000 SW Jackson St., Suite 420, Topeka, Kansas 66612-1367. Telephone 785-296-5522. Send one copy to WATER WELL OWNER and retain one for your records. Include fee of \$5.00 for each constructed well. Visit us at http://www.kdheks.gov/waterwell/index.html.