

County: Leavenworth Fraction NE NE SW SW Sec. 23 T 8 S R 22 EW

**CORRECTION(S) TO WATER WELL COMPLETION RECORD (WWC-5)**

(to rectify lacking or incorrect information)

Owner: U.S. Federal Bureau of Prisons

Location was listed as:

Location changed to:

Section-Township-Range: 22-52N-22E

23-8S-22E

Fraction (1/4 1/4 1/4): SE SE SE

NE NE SW SW

Other changes: Initial statements: \_\_\_\_\_

Changed to: \_\_\_\_\_

Comments: \_\_\_\_\_

Verification method: Latitude & Longitude, KGS' "LEO" conversion tool,  
and mapping tool on KGS website.

initials: ORA date: 8/29/2014

Submitted by: Kansas Geological Survey, Data Resources Library, 1930 Constant Ave., Lawrence, KS 66047-3726

to: Kansas Dept of Health & Environment, Bureau of Water, 1000 SW Jackson, Suite 420, Topeka, KS 66612-1367.

MW34

WATER WELL PLUGGING RECORD Form WWC-5P KSA 82a-1212 ID NO.

1 LOCATION OF WATER WELL: Fraction SE 1/4 SE 1/4 SE 1/4 Section Number 22 Township Number 52N Range Number 22

Distance and direction from nearest town or city street address of well if located within city? 1300 Metropolitan Ave. Leavenworth, KS

2 WATER WELL OWNER: U.S. Federal Bureau of Prisons Global Positioning Systems (decimal degrees, min. of 4 digits) Latitude: 39 20 07.92 Longitude: 94 55 56.80 Elevation: Datum: Data Collection Method: Google Earth

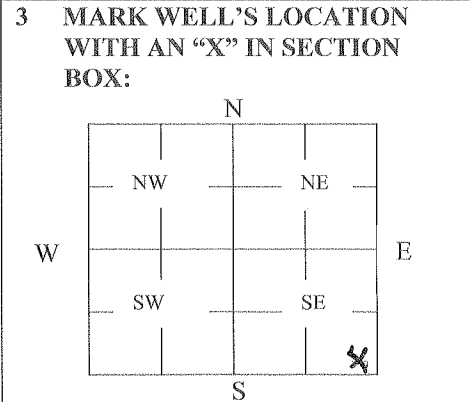

3 MARK WELL'S LOCATION WITH AN 'X' IN SECTION BOX: 4 DEPTH OF WELL 17' ft. WELL'S STATIC WATER LEVEL 15.61 ft. WELL WAS USED AS: 1 Domestic 2 Irrigation 3 Feedlot 4 Industrial 5 Public Water Supply 6 Oil Field Water Supply 7 Domestic (Lawn & Garden) 8 Air Conditioning 9 Dewatering 10 Monitoring 11 Injection Well 12 Other Was a chemical/bacteriological sample submitted to Department? Yes No X

5 TYPE OF BLANK CASING USED: 1 Steel 2 PVC 3 RMP (SR) 4 ABS 5 Wrought 6 Asbestos-Cement 7 Fiberglass 8 Concrete Tile 9 Other (Specify below) Stainless Steel 304 Blank casing diameter 2" in. Was casing pulled? Yes X No If yes, how much all 17' Casing height above or below land surface 2' in.

6 GROUT PLUG MATERIAL: 1 Neat cement 2 Cement grout 3 Bentonite 4 Other Clay Grout Plug Intervals: From 17' ft. to 1' ft., From 1' ft. to 0' ft., From to ft. What is the nearest source of possible contamination: 1 Septic tank 2 Sewer lines 3 Watertight sewer lines 4 Lateral lines 5 Cess pool 6 Seepage pit 7 Pit privy 8 Sewage lagoon 9 Feedyard 10 Livestock pens 11 Fuel Storage 12 Fertilizer storage 13 Insecticide storage 14 Abandoned water well 15 Oil well/Gas well 16 Other (specify below) Possible Landfill Direction from well? How many feet?

Table with 6 columns: FROM, TO, PLUGGING MATERIALS, FROM, TO, PLUGGING MATERIALS. Contains handwritten entries: Bentonite from 17'-1', Soil from 1'-0'.

7 CONTRACTOR'S OR LANDOWNER'S CERTIFICATION: This water well was plugged under my jurisdiction and was completed on (mo/day/year) 7/22/14 and this record is true to the best of my knowledge and belief. Kansas Water Well Contractor's License No. 732. This Water Well Record was completed on (mo/day/year) 7/26/14 under the business name of JB Environmental Drilling by (signature) James Buekel

INSTRUCTIONS: Use typewriter or ballpoint pen. Please press firmly and print clearly. Please fill in blanks, underline or circle the correct answers. Send top three copies to Kansas Department of Health and Environment, Bureau of Water, Geology Section, 1000 SW Jackson St., Ste. 420, Topeka, Kansas 66612-1367. Telephone: 785/296-5522. Send one to Water Well Owner and retain one for your records. Visit us at http://www.kdheks.gov/geo/waterwells.