

WATER WELL RECORD

Form WWC-5

Division of Water Resources App. No.

Well ID

MW2

Original Record Correction Change in Well Ust

1 LOCATION OF WATER WELL: County Jackson Fraction NW 1/4 NE 1/4 SE 1/4 Section Number 23 Township Number T 9 S Range Number R 15 E W

2 WELL OWNER: Last Name: First: Street or Rural Address where well is located (if unknown, distance and direction from nearest town or intersection): If at owner's address, check here: Business: Kansas Department of Health and Environment Address: 1000 SW Jackson, Suite 410 City Topeka State: KS ZIP: 66612

3 LOCATE WELL WITH 'X' IN SECTION BOX: NW NE SW SE

4 DEPTH OF COMPLETED WELL: 20 ft Depth(s) Groundwater Encountered: 1) 18 ft 2) ft 3) ft, or 4) Dry Well WELL'S STATIC WATER LEVEL: 14.36 ft. X below land surface, measured on (mo-day-yr) 4/26/22

5 Latitude: 39.25260 (decimal degrees) Longitude: -95.70475 (decimal degrees) Horizontal Datum: WGS 84 NAD 83 NAD 27 Source for Latitude/Longitude: GPS (unit make/model): Land Survey Topographic Map Online Mapper

7 WELL WATER TO BE USED AS: 1 Domestic: Household Lawn & Garden Livestock Irrigation Feedlot Industrial 5 Public Water Supply: well ID 6 Dewatering: how many wells? 7 Aquifer Recharge: well ID 8 Monitoring: well ID MW2 9 Environmental Remediation: well ID Air Sparge Soil Vapor Extractor Recovery Injection 10 Oil Field Water Supply: lease 11 Test Hole: well ID Cased Uncased Geotechnical 12 Geothermal: How many bores? a) Closed Loop Horizontal Vertical b) Open Loop Surface Discharge Inj. of Water Other (specify):

Was a chemical/bacteriological sample submitted to KDHE? Yes No X No If yes, date sample was submitted: Water well disinfected? Yes No X No

8 TYPE OF CASING USED: Steel PVC Other CASING JOINTS: Glued Clamped Welded Threaded Casing diameter 2 in. to 5 ft, Diameter in. to ft, Diameter in. to ft, Casing height above land surface -0.46 in. Weight lbs./ft. Well thickness or gauge No TYPE OF SCREEN OR PERFORMANCE MATERIAL: Steel Stainless Steel Fiberglass PVC Other (Specify) SCREEN OR PERFORATION OPENINGS ARE: Continuous Slot Mill Slot Gauze Wrapped Torch Cut Drilled Holes Other (Specify) Louvered Shutter Key Punched Wire Wrapped Saw Cut None (Open Hole) SCREEN-PERFORATED INTERVALS: From 5 ft. to 20 ft. GRAVEL PACK INTERVALS: From 3 ft. to 20 ft.

9 GROUT MATERIAL: Neat cement Cement grout Bentonite Other Concrete: 0-0.5' Grout intervals: From 0.5 ft. to 3 ft. From ft. to ft. From ft. to ft.

Nearest source of possible contamination: Septic Tank Lateral Lines Pit Privy Livestock Pens Insecticide Storage Sewer Lines Cess Pool Sewage Lagoon Fuel Storage Abandoned Water Well Watertight Sewer Lines Seepage Pit Feedyard Fertilizer Storage Oil Well / Gas Well Other (Specify) Direction from well? SE Distance from well? 120 ft

Table with 6 columns: FROM, TO, LITHOLOGIC LOG, FROM, TO, LITHO. LOG (cont.) or PLUGGING INTERVALS. Rows include soil types like Top soil-dark brown clay, Brown till clay, Gray sand, Brown tan sand, Gray shale.

Notes: KDHE ID: Former Lynn Fertilizer; C4-043-73296 Target of monitoring well is shallow groundwater, <20' of grout was installed at the direction of KDHE.

11 CONTRACTOR'S OR LANDOWNER'S CERTIFICATION: This water well was constructed, reconstructed, or plugged under my jurisdiction and was completed on (mo-day-year) 4/19/22 and this record is true to the best of my knowledge and belief. Kansas Water Well Contractor's License No 757 This Water Well Record was completed on (mo-day-year) 6/6/22 under the business name of Larsen & Associates, Inc. Signature



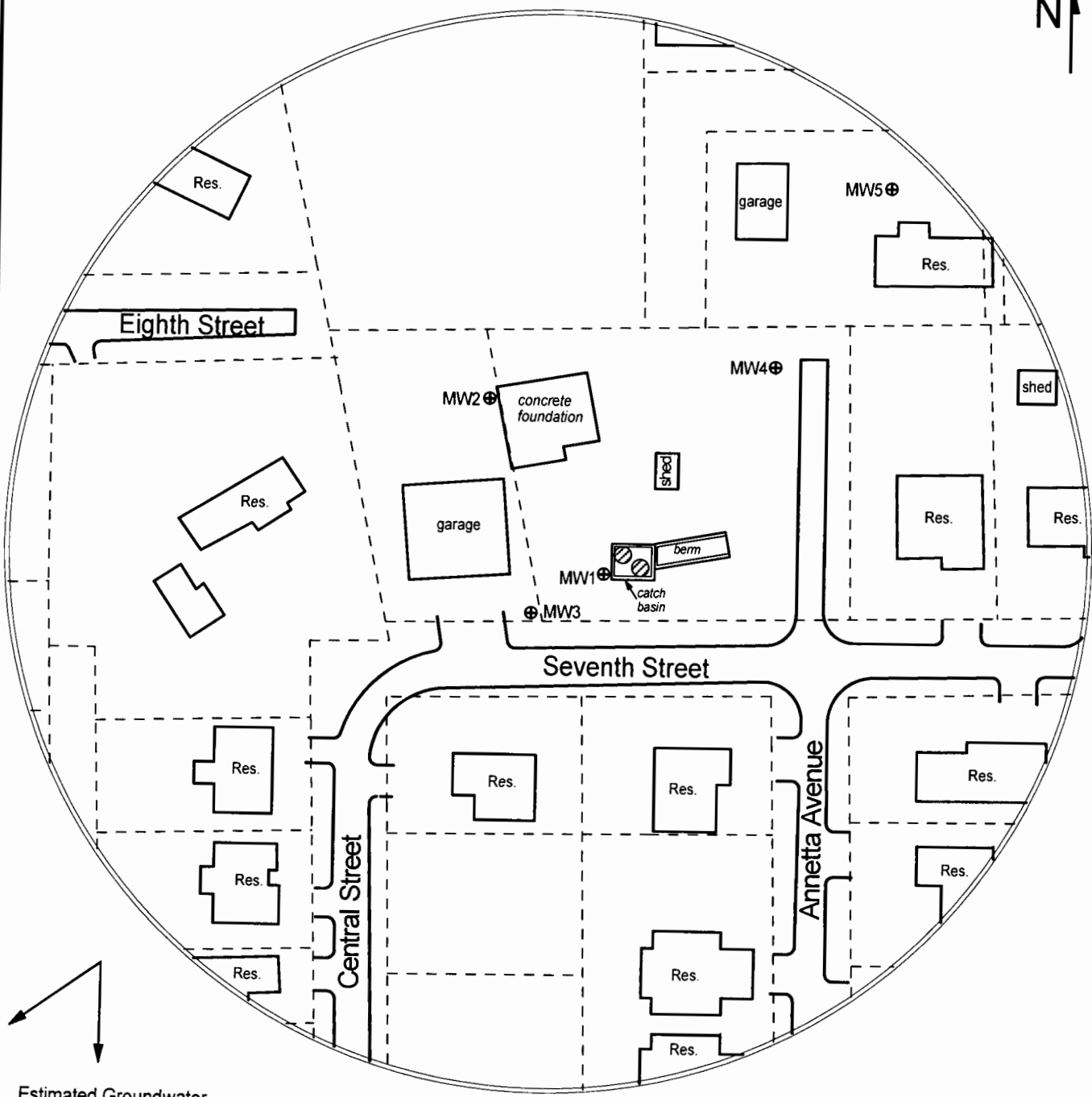

NOTE: Figures exhibited within this report are only to be used within the context of this report. Placement of property lines, wells, structures, and roads is based on the available information from county appraiser maps, surveys, site visits, and/or previous vendor reports and should be considered approximate.



Estimated Groundwater Flow Direction

FIGURE 3 - 350 FT RADIUS AREA BASE MAP

LEGEND:

-  Former Location of Above Ground Storage Tank
-  Approximate Site Boundary
-  Approximate Location of Property Line
-  New Monitoring Well (Installed 4/18-19/22)



PROJECT:
 Former Lynn Fertilizer
 707 Annetta Avenue
 Hoyt, KS
 KDHE ID: C4-043-73296
 Date: 4/26/22

1311 E 25th St. Suite B 785-841-8707 office
 Lawrence, KS 66046 785-865-4282 fax



Jackson

23-95-15E

DENNIS L HANDKE

1820 NW 59th Terrace
TOPEKA, KANSAS 66618
785-286-4047 Home

Jess Chapman
Larsen & Assoc.
1311 E. 25th St., Suite B
Topeka, Kansas 66046

April 30, 2022

RE: Monitor Well Elevation Survey
707 Annette Ave., Hoyt, Kansas

Proj. 22-00AA
Former Lynn Fertilizer
KDHE ID C4-043-73296

Bench Mark: Chisled Square on NE corner of concrete scale platform at center of property.
Elev.: 1169.92 North 2561.35 West 911.23 (from SE Cor. Sec. 23-9-15E)

MW-1	rim	1168.59	North	2470.33	NE1/4,NW1/4,NE1/4,SE1/4
	top pipe	1168.18	West	944.12	Lat = 39.25226 Long = 95.70446
MW-2	rim	1166.74	North	2595.28	NW1/4,NW1/4,NE1/4,SE1/4
	top pipe	1166.28	West	1026.12	Lat = 39.25260 Long = 95.70475
MW-3	rim	1163.12	North	2448.48	NW1/4,NW1/4,NE1/4,SE1/4
	top pipe	1162.57	West	1003.10	Lat = 39.25220 Long = 95.70467
MW-4	rim	1171.03	North	2595.41	NE1/4,NW1/4,NE1/4,SE1/4
	top pipe	1170.45	West	837.50	Lat = 39.25260 Long = 95.70409
MW-5	rim	1175.97	North	2744.20	SE1/4,SW1/4,SE1/4,NE1/4
	top pipe	1175.65	West	769.18	Lat = 39.25301 Long = 95.70384

Lat & Long derived from Mayette 7.5' quad map. WGS84.

Elevation derived from BM#37-B, KDOT project K-214 "1961". NAVD 88.

If you have any questions, please feel free to call me. Thank you for the opportunity to be of service to you.

Dennis L Handke RLS



RECEIVED

JUN 10 2022

BUREAU OF WATER