

WATER WELL RECORD

Form WWC-5

Division of Water Resources App. No.

Well ID

MW4

Original Record Correction Change in Well Ust

1 LOCATION OF WATER WELL: County Jackson Fraction NE 1/4 NW 1/4 NE 1/4 SE 1/4 Section Number 23 Township Number T 9 S Range Number R 15 E W

2 WELL OWNER: Last Name: First: Street or Rural Address where well is located (if unknown, distance and direction from nearest town or intersection): If at owner's address, check here: 707 Annetta Ave, Hoyt, KS 66440

3 LOCATE WELL WITH "X" IN SECTION BOX: NW NE SW SE X

4 DEPTH OF COMPLETED WELL: 30 ft Depth(s) Groundwater Encountered: 1) 23 ft 2) ft 3) ft or 4) Dry Well WELL'S STATIC WATER LEVEL: 14.96 ft

5 Latitude: 39.25260 (decimal degrees) Longitude: -95.70409 (decimal degrees) Horizontal Datum: WGS 84 NAD 83 NAD 27 Source for Latitude/Longitude: GPS (unit make/model): (WAAS enabled? Yes No) Land Survey Topographic Map Online Mapper

6 Elevation 1170.45 ft Ground Level TOC Source Land Survey GPS Topographic Map Other

7 WELL WATER TO BE USED AS: 1 Domestic: Household Lawn & Garden Livestock Irrigation Feedlot Industrial 5 Public Water Supply: well ID 6 Dewatering: how many wells? 7 Aquifer Recharge: well ID 8 Monitoring: well ID MW4 9 Environmental Remediation: well ID Air Sparge Soil Vapor Extractor Recovery Injection 10 Oil Field Water Supply: lease 11 Test Hole: well ID Cased Uncased Geotechnical 12 Geothermal: How many bores? a) Closed Loop Horizontal Vertical b) Open Loop Surface Discharge Inj. of Water Other (specify):

Was a chemical/bacteriological sample submitted to KDHE? Yes No If yes, date sample was submitted: Water well disinfected? Yes No

8 TYPE OF CASING USED: Steel PVC Other CASING JOINTS: Glued Clamped Welded Threaded Casing diameter 2 in. to 15 ft. Diameter in. to ft. Diameter in. to ft. Casing height above land surface -0.58 in. Weight lbs./ft. Well thickness or gauge No TYPE OF SCREEN OR PERFORATION MATERIAL: Steel Stainless Steel Fiberglass PVC Brass Galvanized Steel Concrete tile None used (open hole) SCREEN OR PERFORATION OPENINGS ARE: Continuous Slot Mill Slot Gauze Wrapped Torch Cut Drilled Holes Other (Specify) Louvered Shutter Key Punched Wire Wrapped Saw Cut None (Open Hole) SCREEN-PERFORATED INTERVALS: From 15 ft. to 30 ft. From ft. to ft. From ft. to ft. GRAVEL PACK INTERVALS: From 12 ft. to 30 ft. From ft. to ft. From ft. to ft.

9 GROUT MATERIAL: Neat cement Cement grout Bentonite Other Concrete: 0-0.5' Grout intervals: From 0.5 ft. to 12 ft. From ft. to ft. From ft. to ft.

Nearest source of possible contamination: Septic Tank Lateral Lines Pit Privy Livestock Pens Insecticide Storage Sewer Lines Cess Pool Sewage Lagoon Fuel Storage Abandoned Water Well Watertight Sewer Lines Seepage Pit Feedyard Fertilizer Storage Oil Well / Gas Well Other (Specify):

Direction from well? SW Distance from well? 150' ft

Table with 6 columns: FROM, TO, LITHOLOGIC LOG, FROM, TO, LITHO. LOG (cont.) or PLUGGING INTERVALS. Rows include Top soil, dark brown clay; Brown reddish clay; Limestone gravel; Brown reddish clay; Gray sand; Brown mottled clay; Tan shale.

Notes: KDHE ID: Former Lynn Fertilizer; C4-043-73296 Target of monitoring well is shallow groundwater, <20' of grout was installed at the direction of KDHE.

11 CONTRACTOR'S OR LANDOWNER'S CERTIFICATION: This water well was constructed, reconstructed, or plugged under my jurisdiction and was completed on (mo-day-year) 4/18/22 and this record is true to the best of my knowledge and belief. Kansas Water Well Contractor's License No 757 This Water Well Record was completed on (mo-day-year) 6/6/22 under the business name of Larsen & Associates, Inc. Signature

Jackson

23-95-15E

### DENNIS L HANDKE

1820 NW 59th Terrace  
TOPEKA, KANSAS 66618  
785-286-4047 Home

Jess Chapman  
Larsen & Assoc.  
1311 E. 25<sup>th</sup> St., Suite B  
Topeka, Kansas 66046

April 30, 2022

RE: Monitor Well Elevation Survey  
707 Annette Ave., Hoyt, Kansas

Proj. 22-00AA  
Former Lynn Fertilizer  
KDHE ID C4-043-73296

Bench Mark: Chisled Square on NE corner of concrete scale platform at center of property.  
Elev.: 1169.92      North 2561.35      West 911.23      (from SE Cor. Sec. 23-9-15E)

MW-1	rim	1168.59	North	2470.33	NE1/4,NW1/4,NE1/4,SE1/4
	top pipe	1168.18	West	944.12	Lat = 39.25226    Long = 95.70446
MW-2	rim	1166.74	North	2595.28	NW1/4,NW1/4,NE1/4,SE1/4
	top pipe	1166.28	West	1026.12	Lat = 39.25260    Long = 95.70475
MW-3	rim	1163.12	North	2448.48	NW1/4,NW1/4,NE1/4,SE1/4
	top pipe	1162.57	West	1003.10	Lat = 39.25220    Long = 95.70467
MW-4	rim	1171.03	North	2595.41	NE1/4,NW1/4,NE1/4,SE1/4
	top pipe	1170.45	West	837.50	Lat = 39.25260    Long = 95.70409
MW-5	rim	1175.97	North	2744.20	SE1/4,SW1/4,SE1/4,NE1/4
	top pipe	1175.65	West	769.18	Lat = 39.25301    Long = 95.70384

Lat & Long derived from Mayette 7.5' quad map. WGS84.

Elevation derived from BM#37-B, KDOT project K-214 "1961". NAVD 88.

If you have any questions, please feel free to call me. Thank you for the opportunity to be of service to you.

Dennis L Handke RLS



RECEIVED

JUN 10 2022



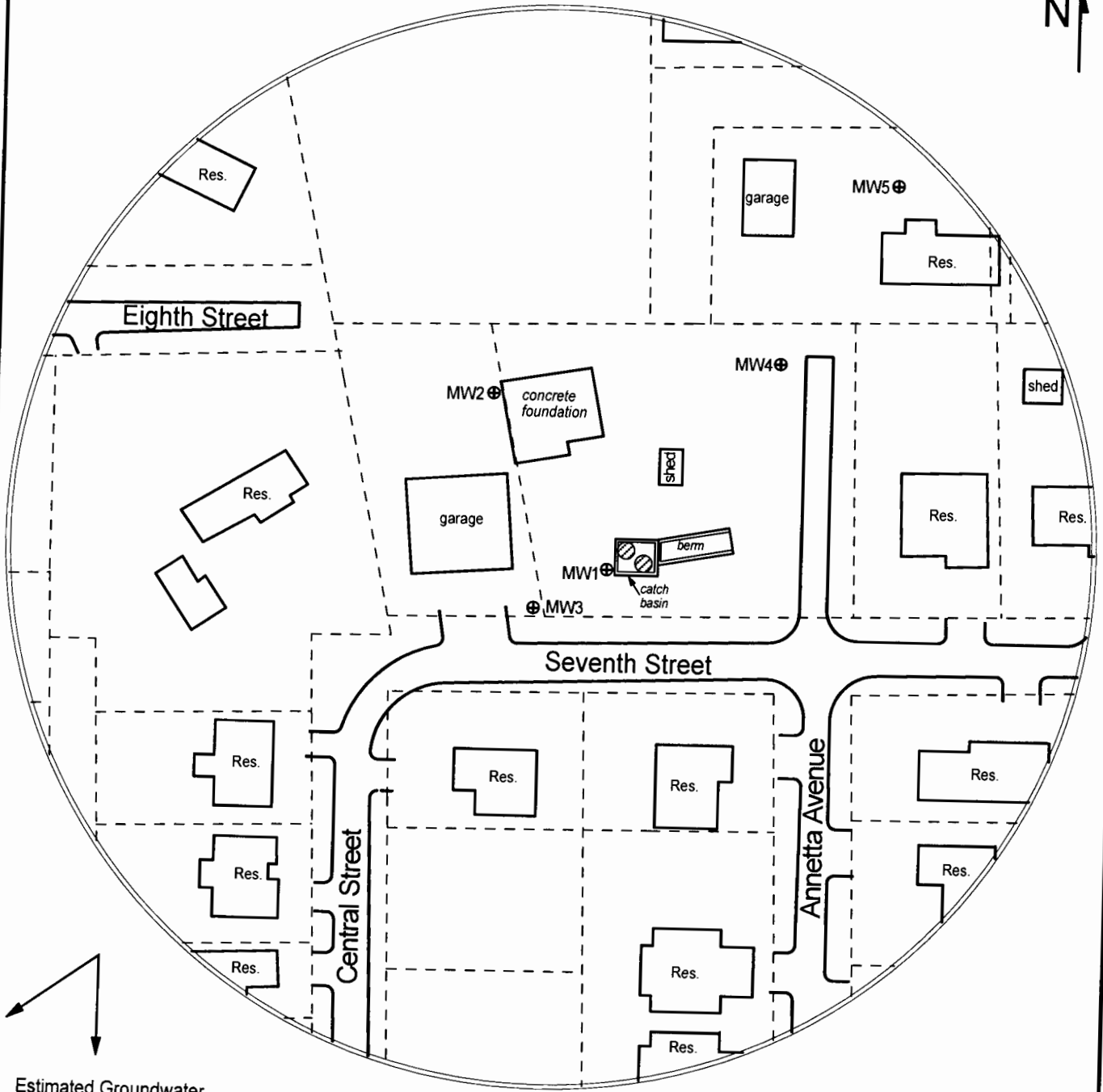

BUREAU OF WATER

NOTE: Figures exhibited within this report are only to be used within the context of this report. Placement of property lines, wells, structures, and roads is based on the available information from county appraiser maps, surveys, site visits, and/or previous vendor reports and should be considered approximate.



Estimated Groundwater Flow Direction

FIGURE 3 - 350 FT RADIUS AREA BASE MAP

- LEGEND:**
-  Former Location of Above Ground Storage Tank
  -  Approximate Site Boundary
  -  Approximate Location of Property Line
  -  New Monitoring Well (Installed 4/18-19/22)



**PROJECT:**  
 Former Lynn Fertilizer  
 707 Annetta Avenue  
 Hoyt, KS  
 KDHE ID: C4-043-73296  
 Date: 4/26/22

1311 E 25th St. Suite B    785-841-8707 office  
 Lawrence, KS 66046        785-865-4282 fax

