

289

R
EPT

USE TYPEWRITER OR BALL POINT PEN-PRESS FIRMLY, PRINT CLEARLY.

WATER WELL RECORD
KSA 82a-1201-1215

Kansas Department of Health and Environment
Division of Environment (Water well Contractors)
Topeka, Kansas 66620

SE NW SE

1. Location of well: County **Leavenworth** Fraction ~~NE~~ ~~SW~~ ~~SE~~ **1/4** Section number **34** Township number **T 9S** Range number **S R 22E** **(EW)**

2. Distance and direction from nearest town or city: **1.2 mi SW of Lansing, Ks.** Street address of well location if in city: _____

3. Owner of well: **D. L Becker** R.R. or street: **Box 370** City, state, zip code: **DeSoto, Ks. 66018**

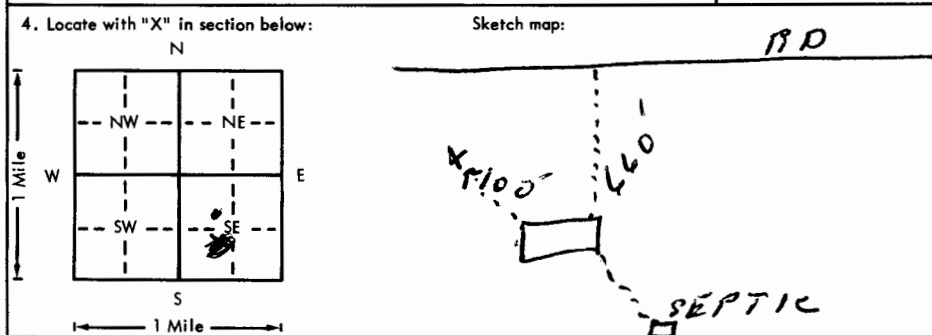

6. Bore hole dia. **8 1/2** in. Completion date **1-19-76**
Well depth **150** ft.

7. Cable tool Rotary Driven Dug
 Hollow rod Jetted Bored Reverse rotary

8. Use: Domestic Public supply Industry
 Irrigation Air conditioning Stock
 Lawn Oil field water Other

9. Casing: Material **RMP** Height: Above or below
Threaded Welded Surface **12** in.
RMP PVC Weight **1 1/2** lbs./ft.
Dia. **5** in. to **150** ft. depth Wall Thickness: _____ inches or
Dia. _____ in. to _____ ft. depth Gage No. **1/2**

| 5. Type and color of material | From | To |
|---|------|-----|
| sandy clay traces gravel brown | 0 | 26 |
| sandstone brown | 26 | 48 |
| shale blue | 48 | 60 |
| shale gray | 60 | 144 |
| lime gray | 144 | 148 |
| shale gray | 148 | 150 |
| Log held waiting for pump installation Customer hasn't called back. Must have installed himself. | | |

10. Screen: Manufacturer's name **Pioneer Mfg. Co.**
Type **RMP** Dia. **5"**
Slot/gauze **see note** Length **130'**
Set between **20** ft. and **150** ft.
_____ ft. and _____ ft.
Gravel pack? Size range of material **1/4 x 1/8**

11. Static water level: _____ mo./day/yr.
 30 ft. below land surface Date **1-19-76**

12. Pumping level below land surfaces:
_____ ft. after _____ hrs. pumping _____ g.p.m.
_____ ft. after _____ hrs. pumping _____ g.p.m.
Estimated maximum yield **1** g.p.m.

13. Water sample submitted: _____ mo./day/yr.
Yes No _____ Date _____

14. Well head completion: **well cap**
 Pitless adapter _____ Inches above grade

15. Well grouted?
With: Neat cement Bentonite Concrete
Depth: From **5** ft. to **20** ft.

16. Nearest source of possible contamination:
ft. **200** Direction **NE** Type **septic**
Well disinfected upon completion? Yes No

17. Pump: Not installed
Manufacturer's name _____
Model number _____ HP _____ Volts _____
Length of drop pipe _____ ft. capacity _____ g.p.m.
Type:
 Submersible Turbine
 Jet Reciprocating
 Centrifugal Other

18. Elevation: **950** ⁰⁴
971
Topography:
 Hill
 Slope
 Upland
 Valley

19. Remarks: **Customer aware of regulation and agrees to install concrete slab around casing. (4')**
X D. L. Becker
Note: Slot size. All casing perforated with 3/32 drill from bottom of well. TO

20. Water well contractor's certification:
This well was drilled under my jurisdiction and this report is true to the best of my knowledge and belief.
F. E. Young Drilling 240
Business name _____ License No. _____
Address **6355 Robinhood Ln. Merriam,**
Signed **F. E. Young** Date **2-14-76**
Authorized representative

Forward the white, blue and pink copies to the Department of Health and Environment

Form WWC-5

BR=945 I=941

1-9
220
34
1/4
NE
SW
SE
EPT