

Leavenworth

1-9-22

DENNIS L HANDKE

1820 NW 59th Terrace
TOPEKA, KANSAS 66618
785-286-4047 Home

Jess Chapman
Larsen & Assoc.
1311 E. 25th St., Suite B
Topeka, Kansas 66046

April 15, 2022

RE: Monitor Well Elevation Survey
2912 S. 4th St., Leavenworth, Kansas

Proj. 22-00V
Adams Standard Service
KDHE ID U4-052-00086

Bench Mark: Chisled X on North top bolt of fire hydrant near the SE corner of Applebee's building.
Elev.: 831.45 North 4909.61 West 1818.59 (from SE Cor. Sec. 12-9-22E)

MW-2	rim	828.88	North 4997.25	NW1/4,NE1/4,NW1/4,NE1/4
	top pipe	828.07	West 1840.18	Lat = 39.28801 Long = 94.90640
MW-3	rim	821.40	North 4863.50	SW1/4,NE1/4,NW1/4,NE1/4
	top pipe	821.23	West 1929.42	Lat = 39.28765 Long = 94.90671
MW-19	rim	799.03	North 5562.62	SW1/4,SW1/4,SE1/4,SE1/4 (Sec. 1-9-22E)
	top pipe	798.61	West 1158.30	Lat = 39.28756 Long = 94.90399
MW-20	rim	792.43	North 5612.57	NE1/4,SE1/4,SW1/4,SE1/4 (Sec. 1-9-22E)
	top pipe	792.12	West 1447.63	Lat = 39.28970 Long = 94.90501
MW-21	rim	827.78	North 5037.22	NE1/4,NW1/4,NW1/4,NE1/4
	top pipe	827.32	West 2188.33	Lat = 39.28812 Long = 94.90763

Lat & Long derived from Leavenworth 7.5' quad map. WGS84.

Elevation derived from existing project. NAVD 88.

If you have any questions, please feel free to call me. Thank you for the opportunity to be

of service to you.

April 15, 2022
Dennis L Handke RLS

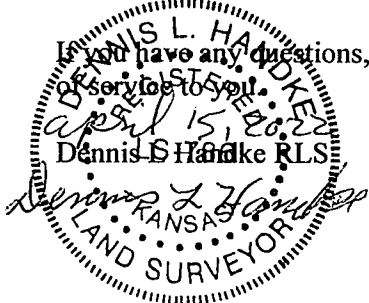

RECEIVED
MAY 17 2022
BUREAU OF WATER

WATER WELL RECORD

Form WWC-5

Division of Water Resources App. No.

Well ID

MW20

Original Record Correction Change in Well Use

1 LOCATION OF WATER WELL: County Leavenworth Fraction NE 1/4 SE 1/4 SW 1/4 SE 1/4 Section Number 1 Township Number T 9 S Range Number R 22 E W

2 WELL OWNER: Last Name: Business: KDHE (Adams Standard Service) Address: 1000 SW Jackson St. City Topeka State: KS ZIP: 66612 Street or Rural Address where well is located (if unknown, distance and direction from nearest town or intersection): 208 Logan St. Leavenworth, KS 66048

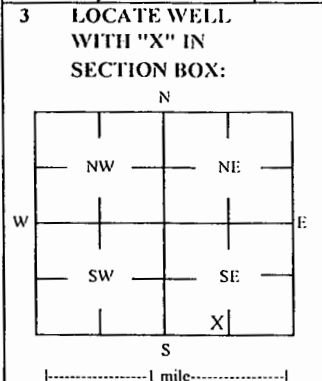

3 LOCATE WELL WITH 'X' IN SECTION BOX: 4 DEPTH OF COMPLETED WELL: 29 ft Depth(s) Groundwater Encountered: 1) 29 ft 2) 3) ft, or 4) Dry Well WELLS STATIC WATER LEVEL: 17.21 ft Wells static water level: below land surface, measured on (mo-day-yr) 4/18/2022

5 Latitude: 39.28970 (decimal degrees) Longitude: 94.90501 (decimal degrees) Horizontal Datum: WGS 84 NAD 83 NAD 27 Source for Latitude/Longitude: GPS (unit make/model) Land Survey Topographic Map Online Mapper 6 Elevation: 792.12 ft Ground Level: TOC Source: Land Survey GPS Topographic Map Other

7 WELL WATER TO BE USED AS: 1 Domestic: Household Lawn & Garden Livestock Irrigation Feedlot Industrial 2 Public Water Supply: well ID 3 Dewatering: how many wells? 4 Aquifer Recharge: well ID 5 Monitoring: well ID MW20 6 Environmental Remediation: well ID Air Sparge Recovery Soil Vapor Extractor Injection 7 Oil Field Water Supply: lease 8 Test Hole: well ID Cased Uncased Geotechnical 9 Geothermal: How many bores? a) Closed Loop Horizontal Vertical b) Open Loop Surface Discharge Inj. of Water Other (specify):

Was a chemical/bacteriological sample submitted to KDHE? Yes No If yes, date sample was submitted: Water well disinfected? Yes No

8 TYPE OF CASING USED: Steel PVC Other CASING JOINTS: Glued Clamped Welded Threaded Casing diameter 2 in. to 9 in. Diameter in. to ft. Diameter in. to ft. Casing height above land surface -0.31 in. Weight lbs./ft. Well thickness or gauge No TYPE OF SCREEN OR PERFORATION MATERIAL: Steel Stainless Steel Fiberglass PVC Brass Galvanized Steel Concrete tile None used (open hole) SCREEN OR PERFORATION OPENINGS ARE: Continuous Slot Mill Slot Gauze Wrapped Torch Cut Drilled Holes Other (Specify) Louvered Shutter Key Punched Wire Wrapped Saw Cut None (Open Hole) SCREEN-PERFORATED INTERVALS: From 9 ft. to 29 ft. GRAVEL PACK INTERVALS: From 7 ft. to 29 ft.

9 GROUT MATERIAL: Neat cement Cement grout Bentonite Other Concrete: 0-0.5' Grout intervals: From 0.5 ft. to 7 ft. Nearest source of possible contamination: Septic Tank Lateral Lines Pit Privy Livestock Pens Insecticide Storage Sewer Lines Cess Pool Sewage Lagoon Fuel Storage Abandoned Water Well Watertight Sewer Lines Seepage Pit Feedyard Fertilizer Storage Oil Well / Gas Well Other (Specify): Direction from well? SW Distance from well? -760 ft

Table with columns: 10 FROM, TO, LITHOLOGIC LOG, FROM, TO, LITHO. LOG (cont.) or PLUGGING INTERVALS. Rows: 0-1 Topsoil, rocks; 1-1.5 Rock; 1.5-4 Clay; 4-13 Silty clay; 13-29 Clay

Notes: KDHE ID: Adams Standard Service; U4-052-00086 Target of monitoring well is shallow groundwater, <20' of grout was installed at the direction of KDHE.

11 CONTRACTOR'S OR LANDOWNER'S CERTIFICATION: This water well was constructed, reconstructed, or plugged under my jurisdiction and was completed on (mo-day-year) 3/28/22 and this record is true to the best of my knowledge and belief. Kansas Water Well Contractor's License No 757 This Water Well Record was completed on (mo-day-year) 5/10/22 under the business name of Larsen & Associates, Inc. Signature

Mail 1 white copy along with a fee of \$5.00 for each constructed well to: Kansas Department of Health and Environment, Bureau of Water, GWS Section, 1000 SW Jackson St., Suite 420, Topeka, Kansas 66612-1367. Mail one to Water Well Owner and retain one for your records. Telephone 785-296-5524.

NOTE: Figures exhibited within this report are only to be used within the context of this report. Placement of property lines, wells, structures, and roads is based on the available information from county appraiser maps, surveys, site visits, and/or previous vendor reports and should be considered approximate.

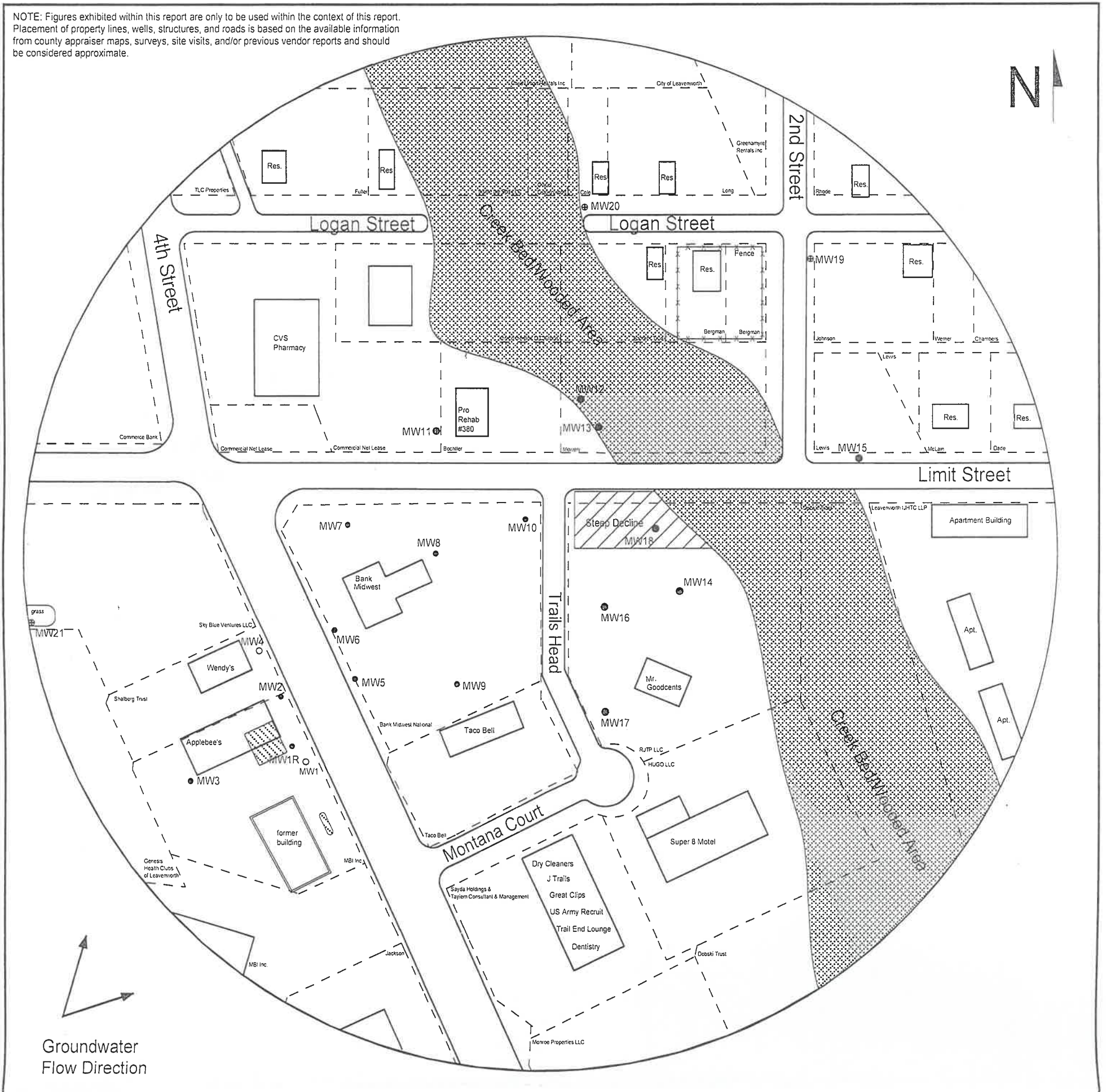



FIGURE 1 - 650 FOOT RADIUS AREA BASE MAP

LEGEND:

-  Approximate Location of Former UST Basin & Pump Island
-  Lost/Destroyed Monitoring Well
-  Monitoring Well
-  New Monitoring Well Installed 3/28/22

NOTE: Approximate location of product lines is unknown.
NOTE: MW9 is no longer within the scope of work.



PROJECT:

Adams Standard Service
2912 S. 4th Street
Leavenworth, KS
KDHE ID: U4-052-00086
Date: 3/28/22



1311 E. 25th St., Suite B (785) 841-8707 (office)
Lawrence, KS 66046 (785) 865-4282 (fax)

1-7-2022