

1 LOCATION OF WATER WELL: Fraction LOT# 2 NE1/4 Addition Section Number 30 Township Number T 9 S Range Number R 6 E
 County: Riley

Distance and direction from nearest town or city street address of well if located within city? From KEATS, Go WEST to 76 To Little Hillen Creek Rd. Turn North & Go South to NE1/4 Dr. + Go South WEST

2 WATER WELL OWNER: Robert E. Johnson
 RR#, St. Address, Box #: 7209 NE1/4 Dr. Board of Agriculture, Division of Water Resources
 City, State, ZIP Code: Manhattan, Kansas 66502 Application Number:

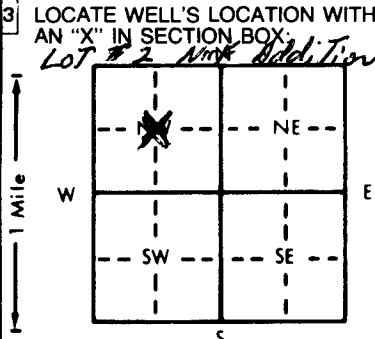

4 DEPTH OF COMPLETED WELL: 130 ft. ELEVATION:
 Depth(s) Groundwater Encountered 1. 84 ft. 2. ft. 3. ft.
 WELL'S STATIC WATER LEVEL: 50 ft. below land surface measured on mo/day/yr
 Pump test data: Well water was ft. after hours pumping gpm
 Est. Yield 2.0 gpm: Well water was ft. after hours pumping gpm
 Bore Hole Diameter: 9 in. to 130 ft., and in. to ft.
 WELL WATER TO BE USED AS: 5 Public water supply 8 Air conditioning 11 Injection well
 1 Domestic 3 Feedlot 6 Oil field water supply 9 Dewatering 12 Other (Specify below)
 2 Irrigation 4 Industrial 7 Lawn and garden only 10 Monitoring well
 Was a chemical/bacteriological sample submitted to Department? Yes No; If yes, mo/day/yr sample was submitted
 Water Well Disinfected? Yes No

5 TYPE OF BLANK CASING USED:
 1 Steel 2 PVC 3 RMP (SR) 4 ABS 5 Wrought iron 6 Asbestos-Cement 7 Fiberglass 8 Concrete tile 9 Other (specify below) CASING JOINTS: Glued Screened Clamped Welded Threaded
 Blank casing diameter: 5 in. to 110 ft., Dia. in. to ft., Dia. in. to ft.
 Casing height above land surface: 2 in., weight Sch 40 lbs./ft. Wall thickness or gauge No.
 TYPE OF SCREEN OR PERFORATION MATERIAL:
 7 PVC 10 Asbestos-cement
 1 Steel 3 Stainless steel 5 Fiberglass 8 RMP (SR) 11 Other (specify)
 2 Brass 4 Galvanized steel 6 Concrete tile 9 ABS 12 None used (open hole)
 SCREEN OR PERFORATION OPENINGS ARE:
 3 Mill slot 3/1000 5 Gauzed wrapped 8 Saw cut 11 None (open hole)
 1 Continuous slot 6 Wire wrapped 9 Drilled holes
 2 Louvered shutter 4 Key punched 7 Torch cut 10 Other (specify)
 SCREEN-PERFORATED INTERVALS: From 110 ft. to 130 ft., From ft. to ft.
 GRAVEL PACK INTERVALS: From 25 ft. to 130 ft., From ft. to ft.

6 GROUT MATERIAL: 1 Neat cement 2 Cement grout 3 Bentonite 4 Other
 Grout Intervals: From 0 ft. to 25 ft., From ft. to ft., From ft. to ft.
 What is the nearest source of possible contamination:
 4 Lateral lines 7 Pit privy 10 Livestock pens 14 Abandoned water well
 1 Septic tank 5 Cess pool 8 Sewage lagoon 11 Fuel storage 15 Oil well/Gas well
 2 Sewer lines 6 Seepage pit 9 Feedyard 12 Fertilizer storage 16 Other (specify below)
 3 Watertight sewer lines 13 Insecticide storage
 Direction from well? 85' South How many feet? 85'

FROM	TO	LITHOLOGIC LOG	FROM	TO	PLUGGING INTERVALS
0	1	Top Soil	76	84	Grey shale
1	3'	Limstone Brown shale	84	89	Limstone (water)
3	6'	Limstone	89	105	Grey shale
6	11	Brown shale	105	123	Brown shale
11	12	Limstone	123	127	Limstone
12	19	Yellow shale	127	130	Grey shale
19	29	Grey shale			
29	38	Limstone			
38	49	Grey shale			
49	54	Brown shale			
54	57	Limstone			
57	59	Grey shale			
59	65	Limstone			
65	71	Yellow shale			
71	76	Limstone			

7 CONTRACTOR'S OR LANDOWNER'S CERTIFICATION: This water well was (1) constructed, (2) reconstructed, or (3) plugged under my jurisdiction and was completed on (mo/day/year) 6/17/91 and this record is true to the best of my knowledge and belief. Kansas Water Well Contractor's License No. 451 This Water Well Record was completed on (mo/day/yr) 6/24/91 under the business name of Haldeman Well Drilling by (signature) Craig Hoff CWD/PI