

CORRECTION(S) TO WATER WELL RECORD (WWC-5)

(to rectify lacking or incorrect information)

Location listed as:

Section-Township-Range: 30-95-8E

Fraction ($\frac{1}{4}$ - $\frac{1}{4}$ $\frac{1}{4}$): SW SW

County: Riley

Location changed to:

31-95-8E

SE SE NW

Other changes: Initial statements: _____

Changed to: _____

Comments: _____

verification method: well address, area road map on internet,
and Manhattan 1:24,000 topo. map.

initials: DR date: 10/3/2005

1 LOCATION OF WATER WELL: County: Riley Fraction: $\frac{1}{4}$ SW $\frac{1}{4}$ SW $\frac{1}{4}$ Section Number: 30 Township Number: T 9 S Range Number: R 8 EW
 Distance and direction from nearest town or city street address of well if located within city? 3304 Shady Valley

2 WATER WELL OWNER: Daryl Waffel
 RR#, St. Address, Box #: 3304 Shady Valley Board of Agriculture, Division of Water Resources
 City, State, ZIP Code: Application Number:

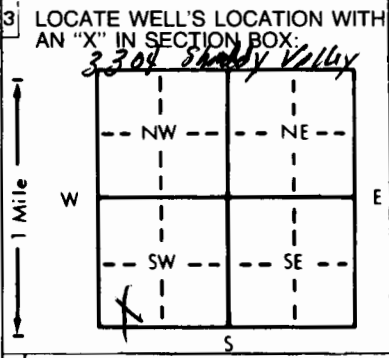

4 DEPTH OF COMPLETED WELL: 60 ft. ELEVATION:ft.
 Depth(s) Groundwater Encountered 1. 38 ft. 2.ft. 3.ft.
 WELL'S STATIC WATER LEVEL 38 ft. below land surface measured on mo/day/yr
 Pump test data: Well water wasft. after hours pumping gpm
 Est. Yield 30 gpm: Well water wasft. after hours pumping gpm
 Bore Hole Diameter 10 in. to 60 ft., and in. to ft.
 WELL WATER TO BE USED AS: 5 Public water supply 8 Air conditioning 11 Injection well
 1 Domestic 3 Feedlot 6 Oil field water supply 9 Dewatering 12 Other (Specify below)
 2 Irrigation 4 Industrial 7 Lawn and garden only 10 Monitoring well
 Was a chemical/bacteriological sample submitted to Department? Yes.....No X; If yes, mo/day/yr sample was submitted
 Water Well Disinfected? Yes No

5 TYPE OF BLANK CASING USED:
 1 Steel 3 RMP (SR) 5 Wrought iron 8 Concrete tile CASING JOINTS: Glued Sealed Clamped
2 PVC 4 ABS 6 Asbestos-Cement 9 Other (specify below) Welded
 Blank casing diameter 5 in. to 40 ft., Dia in. to ft., Dia in. to ft.
 Casing height above land surface 24" in., weight SC 40 lbs./ft. Wall thickness or gauge No.
 TYPE OF SCREEN OR PERFORATION MATERIAL:
 1 Steel 3 Stainless steel 5 Fiberglass 8 RMP (SR) 10 Asbestos-cement
 2 Brass 4 Galvanized steel 6 Concrete tile 9 ABS 11 Other (specify)
 12 None used (open hole)
 SCREEN OR PERFORATION OPENINGS ARE:
 1 Continuous slot 3 Mill slot 16/1000 5 Gauzed wrapped 8 Saw cut 11 None (open hole)
 2 Louvered shutter 4 Key punched 6 Wire wrapped 9 Drilled holes
 7 Torch cut 10 Other (specify)
 SCREEN-PERFORATED INTERVALS: From 40 ft. to 60 ft., From ft. to ft.
 GRAVEL PACK INTERVALS: From 20 ft. to 60 ft., From ft. to ft.

6 GROUT MATERIAL: 1 Neat cement 2 Cement grout 3 Bentonite EQUI-SPLIT
 Grout Intervals: From 0 ft. to 20 ft., From ft. to ft., From ft. to ft.
 What is the nearest source of possible contamination: NONE Close
 1 Septic tank 4 Lateral lines 7 Pit privy 10 Livestock pens 14 Abandoned water well
 2 Sewer lines 5 Cess pool 8 Sewage lagoon 11 Fuel storage 15 Oil well/Gas well
 3 Watertight sewer lines 6 Seepage pit 9 Feedyard 12 Fertilizer storage 16 Other (specify below)
 13 Insecticide storage
 Direction from well? How many feet?

FROM	TO	LITHOLOGIC LOG	FROM	TO	PLUGGING INTERVALS
<u>0</u>	<u>38</u>	<u>BROWN CLAY</u>			
<u>38</u>	<u>45</u>	<u>BROWN CLAY + FINE SAND</u>			
<u>45</u>	<u>56</u>	<u>COURSE SAND + FINE GRAVEL</u>			
<u>56</u>	<u>60</u>	<u>GRAY SHALE</u>			

7 CONTRACTOR'S OR LANDOWNER'S CERTIFICATION: This water well was (1) constructed, (2) reconstructed, or (3) plugged under my jurisdiction and was completed on (mo/day/year) 9/19/89 and this record is true to the best of my knowledge and belief. Kansas Water Well Contractor's License No. 450 This Water Well Record was completed on (mo/day/yr) 10/9/89 under the business name of HALDEMAN WELL DRILLING by (signature) Craig

INSTRUCTIONS: Use typewriter or ball point pen. PLEASE PRESS FIRMLY and PRINT clearly. Please fill in blanks, underline or circle the correct answers. Send top three copies to Kansas Department of Health and Environment, Bureau of Water Protection, Topeka, Kansas 66620-7320. Telephone: 913-296-5514. Send one to WATER WELL OWNER and retain one for your records.