

WATER WELL RECORD

Form WWC-5

Division of Water Resources App. No.

Empty box for application number

1 LOCATION OF WATER WELL: County: Osborne, Fraction 1/4 SE 1/4 SW 1/4 NE 1/4, Section Number 30, Township No. T 10 S, Range Number R 14, Global Positioning System (GPS) information: Latitude, Longitude, Elevation, Datum, Collection Method.

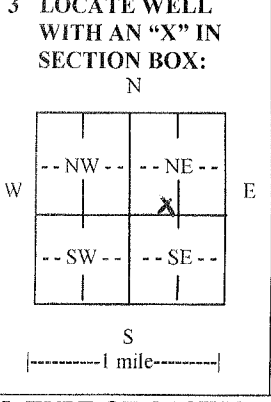

2 WATER WELL OWNER: Neal SMith, RR#, Street Address, Box #: 222 South 7th, City, State, ZIP Code: Osbourne, KS 67473. 3 LOCATE WELL WITH AN 'X' IN SECTION BOX: N, W, E, S. 4 DEPTH OF COMPLETED WELL 60 ft. Depth(s) Groundwater Encountered, WELL'S STATIC WATER LEVEL, Pump test data, EST. YIELD, Bore Hole Diameter, WELL WATER TO BE USED AS, Was a chemical/bacteriological sample submitted to Department?, Water well disinfected?

5 TYPE OF CASING USED: Steel, PVC, Other. CASING JOINTS: Glued, Clamped, Welded, Threaded. Casing diameter, Casing height above land surface, TYPE OF SCREEN OR PERFORATION MATERIAL: Steel, Stainless Steel, PVC, Brass, Galvanized Steel, None used (open hole). SCREEN OR PERFORATION OPENINGS ARE: Continuous slot, Mill slot, Gauze wrapped, Torch cut, Drilled holes, Louvered shutter, Key punched, Wire wrapped, Saw cut, Other (specify). SCREEN-PERFORATED INTERVALS, GRAVEL PACK INTERVALS.

6 GROUT MATERIAL: Neat cement, Cement grout, Bentonite, Other. Grout Intervals, What is the nearest source of possible contamination: Septic tank, Lateral lines, Pit privy, Livestock pens, Insecticide storage, Sewer lines, Cesspool, Sewage lagoon, Fuel storage, Abandoned water well, Watertight sewer lines, Seepage pit, Feedyard, Fertilizer storage, Oil well/gas well, Creek. Direction from well West, Distance from well 100ft.

Table with columns: FROM, TO, LITHOLOGIC LOG, FROM, TO, LITHO. LOG (cont.) or PLUGGING INTERVALS. Rows: 0-4 Top soil, 4-31 Brown clay, 31-40.5 Sandy, silty gray clay, 40.5-45 Broken white rock, 45-60 Blue shale.

7 CONTRACTOR'S OR LANDOWNER'S CERTIFICATION: This water well was constructed, reconstructed, or plugged under my jurisdiction and was completed on (mo/day/year) 9-17-14, Kansas Water Well Contractor's License No. 134, This Water Well Record was completed on (mo/day/year) 9-25-14, under the business name of Rosencrantz- Bemis Ent Inc, by (signature) [Signature]

INSTRUCTIONS: Use typewriter or ball point pen. PLEASE PRESS FIRMLY and PRINT clearly. Please fill in blanks and check the correct answers. Send three copies (white, blue, pink) to Kansas Department of Health and Environment, Bureau of Water, Geology Section, 1000 SW Jackson St., Suite 420, Topeka, Kansas 66612-1367. Telephone 785-296-5524. Send one copy to WATER WELL OWNER and retain one for your records. Include fee of \$5.00 for each constructed well. Visit us at http://www.kdheks.gov/waterwell/index.html.