

USE TYPEWRITER OR BALL POINT PEN-PRESS FIRMLY, PRINT CLEARLY.

T R EW sec 1/4 1/4 1/4 No.

WATER WELL RECORD  
KSA 82a-1201-1215

Kansas State Dept. Of Health  
(Water Well Contractors)  
Forbes-Bldg. 740  
Topeka, Kansas 66620

1 Location of well:	County <b>Osborne</b>	Township name <b>Natoma</b>	Fraction <b>SE<math>\frac{1}{4}</math> NE<math>\frac{1}{4}</math> SW<math>\frac{1}{4}</math></b>	Section number <b>17</b>	Town number <b>10S</b>	Range number <b>15W</b>
---------------------	--------------------------	--------------------------------	---	-----------------------------	---------------------------	----------------------------

Distance and direction from nearest town or city: Street address of well location if in city: <b>215 Koelling</b>	3 Owner of well: <b>Paul Ruggels</b> Address: <b>215 Koelling-Natoma, Kansas</b>
--	--

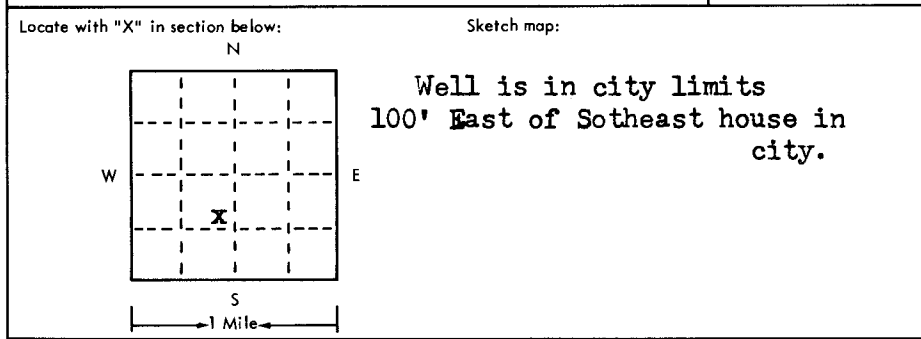

4 Well depth: 73 ft. Date of completion 4-5'76  
Well diameter 10 in.

5  Cable tool  Rotary  Driven  Dug  
 Hollow rod  Jetted  Bored  Reverse rotary

6 Use:  Domestic  Public supply  Industry  
 Irrigation  Air conditioning  Commercial  
 Test well

7 Casing: Material PVC Height: above/below  
Threaded  Welded  Surface 12 in.  
Diam. \_\_\_\_\_ Weight 2 lbs./ft.  
5 in. to 73 ft. depth Drive shoe?  Yes  No  
\_\_\_\_\_ in. to \_\_\_\_\_ ft. depth

2	Type and color of material	From	To
	Top soil	0	4
	Brown sandy soil and clay	4	30
	Sand and White gravel	30	46
	Blue mud	46	66
	Whitw rock and coarse gravel	66	70
	Black shale	70	73

8 Screen: Cut 1/16" slots  
Manufacturer \_\_\_\_\_ Dia. 1/16"  
Type slots Length 6'  
Slot/gauze \_\_\_\_\_ Length \_\_\_\_\_  
Set between 6' ft. and 70 ft. 5  
Fittings: \_\_\_\_\_  
Gravel pack  Yes  No Size range of material \_\_\_\_\_

9 Static water level:  
20 ft. below land surface Date 4/5/76

10 Pumping level below land surfaces:  
20 ft. after 16 hrs. pumping 7 g.p.m.  
20 ft. after 20 hrs. pumping 7 g.p.m.  
Estimated maximum yield 30 g.p.m.

11 Water sample submitted:  
 Yes  No Date \_\_\_\_\_

12 Well head completion:  
 Pitless adapter 12 inches above grade

13 Well grouted?  Yes  No  
 Neat cement  Bentonite  \_\_\_\_\_  
Depth: From 15 ft. to 5 ft.

14 Nearest source of possible contamination:  
ft. 4 mile Direction south Type sewer plant  
Well disinfected upon completion?  Yes  No

15 Pump:  Not installed  
Manufacturer's name \_\_\_\_\_  
Model number \_\_\_\_\_ HP \_\_\_\_\_ Volts \_\_\_\_\_  
Length of drop pipe \_\_\_\_\_ ft. capacity \_\_\_\_\_ g.m.p.  
Type:  
 Submersible  Turbine  
 Jet  Reciprocating  
 Centrifugal  Other

16 Remarks: elevation **Well is located 100' East of the Southwest house in Natoma, about 1/4 mile North of sewer plant up hill To be used for garden and lawn**

Topography:  
 Hill  
 Slope  
 Upland  
 Valley

Water well contractor's certification:  
This well was drilled under my jurisdiction and this report is true to the best of my knowledge and belief.

**Oscar Rush** 310  
Business name \_\_\_\_\_ License No. \_\_\_\_\_  
Address **Natoma, Kansas**  
Signed **Oscar Rush** Date 4/20/76  
Authorized representative

10  
15W  
17  
SENE SW

Forward the white, blue and pink copies to the Kansas State Dept. Of Health.