

1 LOCATION OF WATER WELL: Fraction SE 1/4 SE 1/4 NE 1/4 Section Number 12 Township Number 10 Range Number 16 E/W xx
 County: Rooks

Distance and direction from nearest town or city street address of well if located within city?
from Natoma on hwy. K-18 go approx. 1 mi. West to 31 Rd., then 1/4 mi. N. to pasture/field gate on West side.

2 WATER WELL OWNER: Paul Hachmeister
 RR#, St. Address, Box #: 3080 Hwy. 18
 City, State ZIP Code: Natoma, Ks. 67651
Global Positioning Systems (decimal degrees, min. of 4 digits)
 Latitude: _____
 Longitude: _____
 Elevation: _____
 Datum: _____
 Data Collection Method: _____

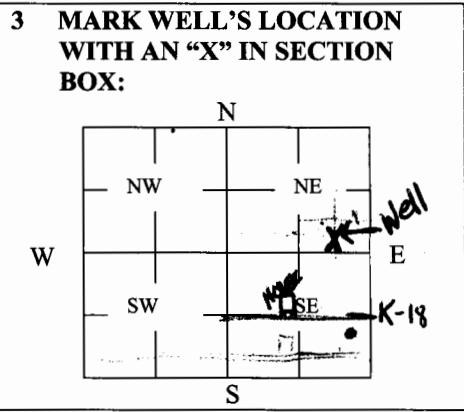

4 DEPTH OF WELL 78 ft.
WELL'S STATIC WATER LEVEL 8 ft.
WELL WAS USED AS:
 Domestic 5 Public Water Supply 9 Dewatering
 2 Irrigation 6 Oil Field Water Supply 10 Monitoring
 Feedlot 7 Domestic (Lawn & Garden) 11 Injection Well
 4 Industrial 8 Air Conditioning 12 Other _____
 Was a chemical/bacteriological sample submitted to Department? Yes _____ No

5 TYPE OF BLANK CASING USED:
 1 Steel 3 RMP (SR) 5 Wrought 7 Fiberglass 9 Other (Specify below)
 PVC 4 ABS 6 Asbestos-Cement 8 Concrete Tile
 Blank casing diameter 5 in. Was casing pulled? Yes _____ No If yes, how much _____
 Casing height above or below land surface 36 in.

6 GROUT PLUG MATERIAL: 1 Neat cement 2 Cement grout Bentonite 4 Other _____
 Grout Plug Intervals: From 62 ft. to 52 ft., From 12 ft. to 3 ft., From _____ to _____ ft.
 What is the nearest source of possible contamination:
 1 Septic tank 6 Seepage pit 11 Fuel Storage 16 Other (specify below) _____
 2 Sewer lines 7 Pit privy 12 Fertilizer storage _____
 3 Watertight sewer lines Sewage lagoon 13 Insecticide storage _____
 4 Lateral lines Feedyard 14 Abandoned water well Direction from well? SW
 5 Cess pool Livestock pens 15 Oil well/Gas well How many feet? 350'

FROM	TO	PLUGGING MATERIALS	FROM	TO	PLUGGING MATERIALS
78	62	Washed Gravel			
62	52	Bentonite			
52	12	Washed Gravel			
12	3	Bentonite			

7 CONTRACTOR'S OR LANDOWNER'S CERTIFICATION: This water well was plugged under my jurisdiction and was completed on (mo/day/year) 10/10/2008 and this record is true to the best of my knowledge and belief. Kansas Water Well Contractor's License No. 767. This Water Well Record was completed on (mo/day/year) 10/19/2008 under the business name of **Mid Kandas Water Well Service, LLC** by (signature)

INSTRUCTIONS: Use typewriter or ballpoint pen. Please press firmly and print clearly. Please fill in blanks, underline or circle the correct answers. Send top three copies to Kansas Department of Health and Environment, Bureau of Water, Geology Section, 1000 SW Jackson St., Ste. 420, Topeka, Kansas 66612-1367. Telephone: 785/296-5522. Send one to Water Well Owner and retain one for your records. Visit us at <http://www.kdheks.gov/geo/waterwells>.