

WATER WELL RECORD

Form WWC-5

Division of Water Resources App. No.

2011 04 33

1 LOCATION OF WATER WELL: Logan Fraction SE 1/4 SE 1/4 NW 1/4 SE 1/4 Section Number 5 Township Number T 11 S Range Number R 34

Street/Rural Address of Well Location; if unknown, distance & direction from nearest town or intersection: If at owner's address, check here. Global Positioning System (GPS) information: Latitude: Longitude: Elevation:

2 WATER WELL OWNER James Family., LLC RR#, St. Address, Box # 804 Central Ave City, State, ZIP Code Nebraska City, NE 68410

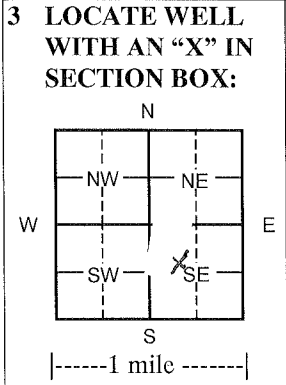

3 LOCATE WELL WITH AN 'X' IN SECTION BOX: 4 DEPTH OF COMPLETED WELL 200 ft. Depth(s) Groundwater Encountered (1) ft. (2) ft. (3) ft. WELL'S STATIC WATER LEVEL ft. below land surface measured on mo/day/yr

5 TYPE OF CASING USED: Steel PVC Other CASING JOINTS: Glued Clamped Welded Threaded Casing diameter 4.5 in. to 160 ft., Diameter in. to ft., Diameter in. to ft. Casing height above land surface 18 in., Weight 2.38 lbs./ft. Wall thickness or gauge No. 248

TYPE OF SCREEN OR PERFORATION MATERIAL: Steel Stainless Steel PVC Other (Specify) Brass Galvanized Steel None used (open hole) SCREEN OR PERFORATION OPENINGS ARE: Continuous Slot Mill slot Gauze wrapped Torch cut Drilled holes None (open hole) Louvered shutter Key punched Wire wrapped Saw cut Other (specify)

6 GROUT MATERIAL: Neat cement Cement grout Bentonite Other Grout Intervals From 0 ft. to 20 ft. From ft. to ft. From ft. to ft. From ft. to ft. What is the nearest source of possible contamination: Septic tank Lateral lines Pit privy Livestock pens Insecticide storage Other (specify below)

Table with columns: FROM, TO, LITHOLOGIC LOG, FROM, TO, LITHO. LOG (cont.) or PLUGGING INTERVALS. Rows include Surface, Loess, Clay w/caliche strks, Fine & med sand w/clay & caliche strks, Clay & caliche w/fine sand strks, Fine sand w/clay & caliche strks, Caliche w/fine sand strks, Fine to some med sand w/clay & caliche Strks, Fine & med sand w/clay lenses.

7 CONTRACTOR'S OR LANDOWNER'S CERTIFICATION: This water well was constructed, reconstructed, or plugged under my jurisdiction and was completed on (mo/day/year) 9/16/11 and this record is true to the best of my knowledge and belief. Kansas Water Well Contractor's License No. 554 This Water Well Record was completed on (mo/day/year) 9-23-11 under the business name of Woofter Pump & Well Inc. by (signature)

INSTRUCTIONS: Please fill in blanks and check the correct answers. Send three copies (white, blue, pink) to Kansas Department of Health and Environment, Bureau of Water, Geology Section, 1000 SW Jackson St., Suite 420, Topeka, Kansas 66612-1367. Telephone 785-296-5522. Send one to WATER WELL OWNER and retain one for your records. Include fee of \$5.00 for each constructed well. Visit us at http://www.kdheks.gov/waterwell/index.html.