

WATER WELL RECORD

Form WWC-5

Division of Water Resources App. No.

Well ID

MW5

Original Record Correction Change in Well Ust

1 LOCATION OF WATER WELL: County Lincoln Fraction SE 1/4 NE 1/4 SE 1/4 SE 1/4 Section Number 34 Township Number T 11 S Range Number R 8 E W

2 WELL OWNER: Last Name: Business: Walker Products Co. Address: PO Box 349 City Lincoln State: KS ZIP: 67455 Street or Rural Address where well is located (if unknown, distance and direction from nearest town or intersection): 1324 N 170th Rd, Lincoln, KS

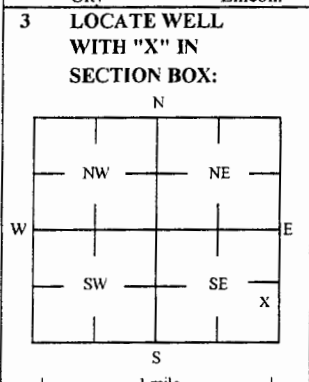

3 LOCATE WELL WITH 'X' IN SECTION BOX: 4 DEPTH OF COMPLETED WELL: 49.72 ft Depth(s) Groundwater Encountered: 1) 49.72 ft 2) ft 3) ft, or 4) Dry Well WELL'S STATIC WATER LEVEL: 35.26 ft

5 Latitude: 39.04771 (decimal degrees) Longitude: 98.18891 (decimal degrees) Horizontal Datum: X WGS 84 NAD 83 NAD 27 Source for Latitude/Longitude: GPS (unit make/model): (WAAS enabled? Yes No) X Land Survey Topographic Map Online Mapper 6 Elevation 1402.44 ft Ground Level X TOC Source: X Land Survey GPS Topographic Map Other

7 WELL WATER TO BE USED AS: 1 Domestic: Household Lawn & Garden Livestock Irrigation Feedlot Industrial 2 Public Water Supply: well ID 3 Dewatering: how many wells? 4 Aquifer Recharge: well ID 5 Monitoring: well ID MW5 6 Environmental Remediation: well ID 7 Air Sparge 8 Soil Vapor Extractor 9 Recovery 10 Injection 11 Oil Field Water Supply: lease 12 Test Hole: well ID Cased Uncased Geotechnical 13 Geothermal: How many bores? a) Closed Loop Horizontal Vertical b) Open Loop Surface Discharge Inj. of Water Other (specify):

Was a chemical/bacteriological sample submitted to KDHE? Yes No X No If yes, date sample was submitted: Water well disinfected? Yes No X No

8 TYPE OF CASING USED: Steel PVC Other CASING JOINTS: Glued Clamped Welded X Threaded Casing diameter 2 in. to 34.72 ft, Diameter in. to ft, Diameter in. to ft, Casing height above land surface -0.24 in. Weight lbs./ft. Well thickness or gauge No TYPE OF SCREEN OR PERFORATION MATERIAL: Steel Stainless Steel Fiberglass PVC Other (Specify) Brass Galvanized Steel Concrete tile None used (open hole) SCREEN OR PERFORATION OPENINGS ARE: Continuous Slot X Mill Slot Gauze Wrapped Torch Cut Drilled Holes Other (Specify) Louvered Shutter Key Punched Wire Wrapped Saw Cut None (Open Hole) SCREEN-PERFORATED INTERVALS: From 34.72 ft. to 49.72 ft. GRAVEL PACK INTERVALS: From 32.72 ft. to 50.5 ft.

9 GROUT MATERIAL: Neat cement Cement grout X Bentonite X Other Concrete: 0-0.5' Grout intervals: From 0.5 ft. to 32.72 ft. From ft. to ft. From ft. to ft.

Nearest source of possible contamination: Septic Tank Lateral Lines Pit Privy Livestock Pens Insecticide St. 25 Sewer Lines Cess Pool Sewage Lagoon X Fuel Storage Abandoned Water Well Watertight Sewer Lines Seepage Pit Feedyard Fertilizer Storage Oil Well / Gas Well Other (Specify) Direction from well? N-NW Distance from well? ~130 ft

10 FROM TO LITHOLOGIC LOG FROM TO LITHO. LOG (cont.) or PLUGGING INTERVALS

FROM	TO	LITHOLOGIC LOG	FROM	TO	LITHO. LOG (cont.) or PLUGGING INTERVALS
0	2.5	Topsoil: Silty clay			
2.5	3	Sandstone			
3	4.5	Silty clay			
4.5	6.5	Siltstone and sandstone			
6.5	15	Silty clay			
15	50.5	Siltstone and sandstone			

Notes: KDHE ID: Walker Products Co., Inc.; U5-053-00111

11 CONTRACTOR'S OR LANDOWNER'S CERTIFICATION: This water well was X constructed, reconstructed, or plugged under my jurisdiction and was completed on (mo-day-year) 6/28/16 and this record is true to the best of my knowledge and belief. Kansas Water Well Contractor's License No 757 This Water Well Record was completed on (mo-day-year) 10/25/16 under the business name of Larsen & Associates, Inc. Signature

Mail 1 white copy along with a fee of \$5.00 for each constructed well to: Kansas Department of Health and Environment, Bureau of Water, Groundwater Section, 1000 SW Jackson St., Suite 420, Topeka, Kansas 66612-1367. Mail one to Water Well Owner and retain one for your records. Telephone 785-296-5524.

DENNIS L HANDKE

1820 NW 59th Terrace
TOPEKA, KANSAS 66618
785-286-4047 Home
785-286-1990 Fax

Jessica Chapman
Larsen & Associates
1311 E. 25th Street, Suite B
Lawrence, Kansas, 66046

August 11, 2016

RE: Monitor Well Elevation Survey
1324 N. 170th Rd., Lincoln, Kansas

Proj. 16-00M
Walker Products Co, Inc.
U5-053-00111

Bench Mark: Sq.cut on Southeast corner of concrete retaining wall East of the garage.
Elev: 1405.08 North 1034 West 86 (from SE Cor. Sec. 34-11-8W)

MW-1	rim	1403.71	North	1087	NE1/4,NE1/4,SE1/4,SE1/4
	top pipe	1403.37	West	116	Lat= 39.04854 Long = 98.18907
MW-2	rim	1402.07	North	1082	NE1/4,NE1/4,SE1/4,SE1/4
	top pipe	1401.71	West	63	Lat= 39.04804 Long = 98.18889
MW-3	rim	1403.89	North	1015	NE1/4,NE1/4,SE1/4,SE1/4
	top pipe	1403.63	West	107	Lat= 39.04786 Long = 98.18904
MW-4	rim	1403.49	North	1250	NE1/4,NE1/4,SE1/4,SE1/4
	top pipe	1403.11	West	89	Lat= 39.04850 Long = 98.18898
MW-5	rim	1402.68	North	962	SE1/4,NE1/4,SE1/4,SE1/4
	top pipe	1402.44	West	71	Lat= 39.04771 Long = 98.18891
MW-6	rim	1403.27	North	1055	NE1/4,NE1/4,SE1/4,SE1/4
	top pipe	1402.84	West	186	Lat= 39.04797 Long = 98.18932

Elevation derived from USGS BM "Lincoln Center" NAVD88.

Lat & Long derived from Lincoln 7.5 Quad Map WGS84.

If you have any questions, please feel free to call me. Thank you for the opportunity to be of service to you.

August 11, 2016
Dennis L Handke RLS

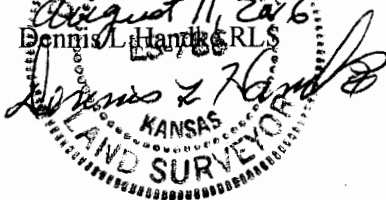

RECEIVED
NOV 04 2016
BUREAU OF WATER