

WATER WELL RECORD

Form WWC-5

Division of Water Resources App. No.

Well ID

MW8

[X] Original Record [] Correction [] Change in Well Ust

1 LOCATION OF WATER WELL: County Lincoln Fraction SE 1/4 NE 1/4 SE 1/4 SE 1/4 Section Number 34 Township Number T 11 S Range Number R 8 E [X] W

2 WELL OWNER: Last Name: Business: Walker Products Co. Address: PO Box 349 City Lincoln State: KS ZIP: 67455 Street or Rural Address where well is located (if unknown, distance and direction from nearest town or intersection): 1324 N 170th Rd, Lincoln, KS

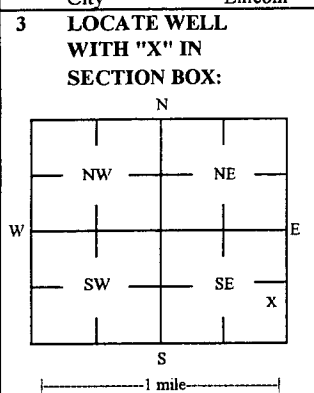

3 LOCATE WELL WITH "X" IN SECTION BOX: 4 DEPTH OF COMPLETED WELL: 35.5 ft Depth(s) Groundwater Encountered: 1) _____ ft 2) _____ ft 3) _____ ft, or 4) [] Dry Well WELLS STATIC WATER LEVEL: 20.01 ft. [X] below land surface, measured on (mo-day-yr) 2/9/17 [] above land surface, measured on (mo-day-yr) _____ Pump test data: Well water was _____ ft after _____ hours pumping _____ gpm Water well was _____ ft after _____ hours pumping _____ gpm Estimated Yield: _____ gpm Bore Hole Diameter: 7.25 in to _____ ft, and _____ in to _____ ft

5 Latitude: 39.04764 (decimal degrees) Longitude: 98.18942 (decimal degrees) Horizontal Datum [X] WGS 84 [] NAD 83 [] NAD 27 Source for Latitude/Longitude: [] GPS (unit make/model: _____) (WAAS enabled? [] Yes [] No) [X] Land Survey [] Topographic Map [] Online Mapper

6 Elevation 1388.95 ft [] Ground Level [X] TOC Source [X] Land Survey [] GPS [] Topographic Map [] Other _____

7 WELL WATER TO BE USED AS: 1 Domestic: [] Household [] Lawn & Garden [] Livestock 2 [] Irrigation 3 [] Feedlot 4 [] Industrial 5 [] Public Water Supply: well ID 6 [] Dewatering: how many wells? 7 [] Aquifer Recharge: well ID 8 [X] Monitoring: well ID MW8 9 Environmental Remediation: well ID [] Air Sparge [] Soil Vapor Extractor [] Recovery [] Injection 10 [] Oil Field Water Supply: lease 11 Test Hole: well ID [] Cased [] Uncased [] Geotechnical 12 Geothermal: How many bores? a) Closed Loop [] Horizontal [] Vertical b) Open Loop [] Surface Discharge [] Inj. of Water [] Other (specify): _____

Was a chemical/bacteriological sample submitted to KDHE? [] Yes [X] No If yes, date sample was submitted: _____ Water well disinfected? [] Yes [X] No

8 TYPE OF CASING USED: [] Steel [X] PVC [] Other _____ CASING JOINTS: [] Glued [] Clamped [] Welded [X] Threaded Casing diameter 2 in. to 15.5 ft, Diameter _____ in. to _____ ft, Diameter _____ in. to _____ ft, Casing height above land surface -0.27 in. Weight _____ lbs./ft. Well thickness or gauge No _____ TYPE OF SCREEN OR PERFORATION MATERIAL: [] Steel [] Stainless Steel [] Fiberglass [X] PVC [] Brass [] Galvanized Steel [] Concrete tile [] None used (open hole) [] Other (Specify) _____ SCREEN OR PERFORATION OPENINGS ARE: [] Continuous Slot [X] Mill Slot [] Gauze Wrapped [] Torch Cut [] Drilled Holes [] Other (Specify) [] Louvered Shutter [] Key Punched [] Wire Wrapped [] Saw Cut [] None (Open Hole) SCREEN-PERFORATED INTERVALS: From 15.5 ft. to 35.5 ft, From _____ ft. to _____ ft, From _____ ft. to _____ ft, GRAVEL PACK INTERVALS: From 13 ft. to 35.5 ft, From _____ ft. to _____ ft, From _____ ft. to _____ ft,

9 GROUT MATERIAL: [] Neat cement [] Cement grout [X] Bentonite [X] Other Concrete: 0-0.5' Grout intervals: From 0.5 ft. to 13 ft, From _____ ft. to _____ ft, From _____ ft. to _____ ft,

Nearest source of possible contamination: [] Septic Tank [] Lateral Lines [] Pit Privy [] Livestock Pens [] Insecticide St 25 [] Sewer Lines [] Cess Pool [] Sewage Lagoon [] Fuel Storage [] Abandoned Water Well [] Watertight Sewer Lines [] Seepage Pit [] Feedyard [X] Fertilizer Storage [] Oil Well / Gas Well [] Other (Specify) _____ Direction from well? S-SE Distance from well? ~75 ft

Table with columns: 10 FROM, TO, LITHOLOGIC LOG, FROM, TO, LITHO. LOG (cont.) or PLUGGING INTERVALS. Row 1: 0, 0.5, Topsoil. Row 2: 0.5, 35.5, Sandstone.

Notes: KDHE ID: Walker Products Co., Inc.; U5-053-00111

11 CONTRACTOR'S OR LANDOWNER'S CERTIFICATION: This water well was [X] constructed, [] reconstructed, or [] plugged under my jurisdiction and was completed on (mo-day-year) 2/8/17 and this record is true to the best of my knowledge and belief. Kansas Water Well Contractor's License No 757 This Water Well Record was completed on (mo-day-year) 3/14/17 under the business name of Larsen & Associates, Inc. Signature _____

DENNIS L HANDKE

1820 NW 59th Terrace
TOPEKA, KANSAS 66618
785-286-4047 Home
785-286-1990 Fax

Jessica Chapman
Larsen & Associates
1311 E. 25th Street, Suite B
Lawrence, Kansas, 66046

February 17, 2017

RE: Monitor Well Elevation Survey
1324 N. 170th Rd., Lincoln, Kansas

Proj. 17-00F
Walker Products Co, Inc.
U5-053-00111

Bench Mark: Sq.cut on Southeast corner of concrete retaining wall East of the garage.
Elev: 1405.08 North 1034 West 86 (from SE Cor. Sec. 34-11-8W)

MW-7	rim	1380.07	North	985	SE1/4,NE1/4,SE1/4,SE1/4
	top pipe	1379.84	West	315	Lat= 39.04778 Long = 98.18977
MW-8	rim	1389.22	North	934	SE1/4,NE1/4,SE1/4,SE1/4
	top pipe	1388.95	West	217	Lat= 39.04764 Long = 98.18942
MW-9	rim	1396.33	North	850	SE1/4,NE1/4,SE1/4,SE1/4
	top pipe	1396.07	West	73	Lat= 39.04740 Long = 98.18842

Elevation derived from existing project.

Lat & Long derived from Lincoln 7.5 Quad Map WGS84.

If you have any questions, please feel free to call me. Thank you for the opportunity to be

of service to you.

February 17, 2017
Dennis L Handke R.E.S.

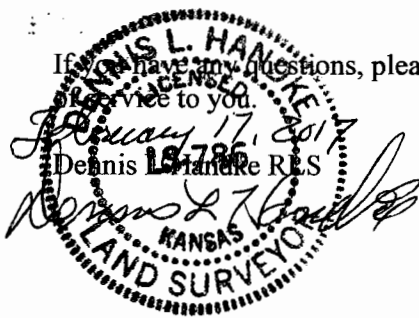

RECEIVED

APR 12 2017

BUREAU OF WATER