

WATER WELL RECORD

Form WWC-5

Division of Water Resources App. No.

Well ID

MW9

Original Record Correction Change in Well Use

1 LOCATION OF WATER WELL: County Lincoln Fraction SE 1/4 NE 1/4 SE 1/4 SE 1/4 Section Number 34 Township Number T 11 S Range Number R 8 E X W

2 WELL OWNER: Last Name: Business: Walker Products Co. Address: PO Box 349 City Lincoln State: KS ZIP: 67455 Street or Rural Address where well is located (if unknown, distance and direction from nearest town or intersection): 1324 N 170th Rd, Lincoln, KS

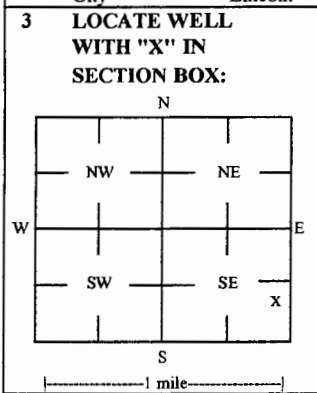

4 DEPTH OF COMPLETED WELL: 40 ft Depth(s) Groundwater Encountered: 1) _____ ft 2) _____ ft 3) _____ ft, or 4) Dry Well WELL'S STATIC WATER LEVEL: 27.5 ft. X below land surface, measured on (mo-day-yr) 2/9/17

5 Latitude: 39.04740 (decimal degrees) Longitude: 98.18842 (decimal degrees) Horizontal Datum: X WGS 84 NAD 83 NAD 27 Source for Latitude/Longitude: GPS (unit make/model:) (WAAS enabled? Yes No) X Land Survey Topographic Map Online Mapper

6 Elevation 1396.07 ft Ground Level X TOC Source: X Land Survey GPS Topographic Map Other

7 WELL WATER TO BE USED AS: 1 Domestic: Household Lawn & Garden Livestock Irrigation Feedlot Industrial 5 Public Water Supply: well ID 6 Dewatering: how many wells? 7 Aquifer Recharge: well ID 8 X Monitoring: well ID MW9 9 Environmental Remediation: well ID Air Sparge Soil Vapor Extractor Recovery Injection 10 Oil Field Water Supply: lease 11 Test Hole: well ID Cased Uncased Geotechnical 12 Geothermal: How many bores? a) Closed Loop Horizontal Vertical b) Open Loop Surface Discharge Inj. of Water Other (specify):

Was a chemical/bacteriological sample submitted to KDHE? Yes No X No If yes, date sample was submitted: Water well disinfected? Yes No X No

8 TYPE OF CASING USED: Steel PVC X Other CASING JOINTS: Glued Clamped Welded X Threaded Casing diameter 2 in. to 20 ft, Diameter in. to ft, Diameter in. to ft, Casing height above land surface -0.26 in. Weight lbs./ft. Well thickness or gauge No TYPE OF SCREEN OR PERFORATION MATERIAL: Steel Stainless Steel Fiberglass X PVC Other (Specify) SCREEN OR PERFORATION OPENINGS ARE: Continuous Slot X Mill Slot Gauze Wrapped Torch Cut Drilled Holes Other (Specify) Louvered Shutter Key Punched Wire Wrapped Saw Cut None (Open Hole) SCREEN-PERFORATED INTERVALS: From 20 ft. to 40 ft, From ft. to ft, From ft. to ft, GRAVEL PACK INTERVALS: From 18 ft. to 40 ft, From ft. to ft, From ft. to ft,

9 GROUT MATERIAL: Neat cement Cement grout X Bentonite X Other Concrete: 0-0.5' Grout intervals: From 0.5 ft. to 18 ft, From ft. to ft, From ft. to ft,

Nearest source of possible contamination: Septic Tank Lateral Lines Pit Privy Livestock Pens Insecticide Storage 25 Sewer Lines Cess Pool Sewage Lagoon Fuel Storage Abandoned Water Well Watertight Sewer Lines Seepage Pit Feedyard X Fertilizer Storage Oil Well / Gas Well Other (Specify) Direction from well? W Distance from well? ~105 ft

Table with columns: FROM, TO, LITHOLOGIC LOG, FROM, TO, LITHO. LOG (cont.) or PLUGGING INTERVALS. Rows show soil layers from 0 to 40 feet depth: Topsoil, Silty clay with trace sand, Sand, Silty sandy clay, Sand with siltstone and sandstone, Silty sand, Sandstone.

Notes: KDHE ID: Walker Products Co., Inc.; U5-053-00111

11 CONTRACTOR'S OR LANDOWNER'S CERTIFICATION: This water well was X constructed, reconstructed, or plugged under my jurisdiction and was completed on (mo-day-year) 2/8/17 and this record is true to the best of my knowledge and belief. Kansas Water Well Contractor's License No 757 This Water Well Record was completed on (mo-day-year) 3/14/17 under the business name of Larsen & Associates, Inc. Signature

Mail 1 white copy along with a fee of \$5.00 for each constructed well to: Kansas Department of Health and Environment, Bureau of Water, GWIS Section, 1000 SW Jackson St., Suite 420, Topeka, Kansas 66612-1367. Mail one to Water Well Owner and retain one for your records. Telephone 785-296-5524.

DENNIS L HANDKE

1820 NW 59th Terrace
TOPEKA, KANSAS 66618
785-286-4047 Home
785-286-1990 Fax

Jessica Chapman
Larsen & Associates
1311 E. 25th Street, Suite B
Lawrence, Kansas, 66046

February 17, 2017

RE: Monitor Well Elevation Survey
1324 N. 170th Rd., Lincoln, Kansas

Proj. 17-00F
Walker Products Co, Inc.
U5-053-00111

Bench Mark: Sq.cut on Southeast corner of concrete retaining wall East of the garage.
Elev: 1405.08 North 1034 West 86 (from SE Cor. Sec. 34-11-8W)

| | | | | | |
|------|----------|---------|-------|-----|----------------------------------|
| MW-7 | rim | 1380.07 | North | 985 | SE1/4,NE1/4,SE1/4,SE1/4 |
| | top pipe | 1379.84 | West | 315 | Lat= 39.04778 Long = 98.18977 |
| MW-8 | rim | 1389.22 | North | 934 | SE1/4,NE1/4,SE1/4,SE1/4 |
| | top pipe | 1388.95 | West | 217 | Lat= 39.04764 Long = 98.18942 |
| MW-9 | rim | 1396.33 | North | 850 | SE1/4,NE1/4,SE1/4,SE1/4 |
| | top pipe | 1396.07 | West | 73 | Lat= 39.04740 Long = 98.18842 |

Elevation derived from existing project.

Lat & Long derived from Lincoln 7.5 Quad Map WGS84.

If you have any questions, please feel free to call me. Thank you for the opportunity to be of service to you.

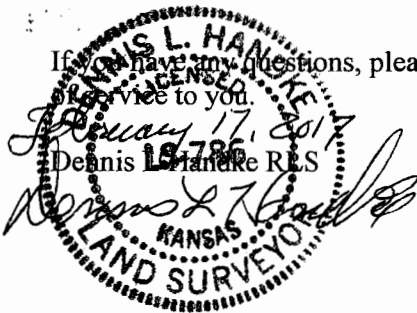

RECEIVED

APR 12 2017

BUREAU OF WATER