

WATER WELL RECORD

Form WWC-5

Division of Water Resources App. No.

1 LOCATION OF WATER WELL: County: Russell	Fraction NW 1/4 SE 1/4 NW 1/4 NW 1/4	Section Number 33	Township No. T 12 S	Range Number R 12 <input type="checkbox"/> E <input checked="" type="checkbox"/> W
Street/Rural Address of Well Location; if unknown, distance & direction from nearest town or intersection: If at owner's address, check here <input type="checkbox"/> 6 1/4 North, 1 3/4 East of Bunker Hill		Global Positioning System (GPS) information: Latitude: (in decimal degrees) Longitude: (in decimal degrees) Elevation: Datum: <input type="checkbox"/> WGS 84, <input type="checkbox"/> NAD 83, <input type="checkbox"/> NAD 27 Collection Method: <input type="checkbox"/> GPS unit (Make/Model:) <input type="checkbox"/> Digital Map/Photo, <input type="checkbox"/> Topographic Map, <input type="checkbox"/> Land Survey Est. Accuracy: <input type="checkbox"/> <3 m, <input type="checkbox"/> 3-5 m, <input type="checkbox"/> 5-15 m, <input type="checkbox"/> >15 m		

2 WATER WELL OWNER: Warren Tindall RR#, Street Address, Box #: Box 266 City, State, ZIP Code : Hoisington, KS 67544	
--	--

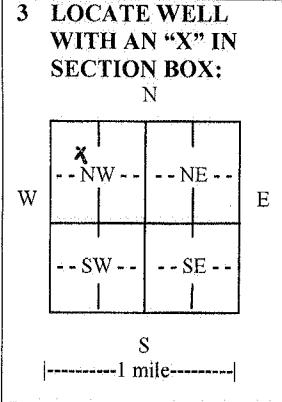

4 DEPTH OF COMPLETED WELL 110 ft.
 Depth(s) Groundwater Encountered (1)..... ft. (2)..... ft. (3)..... ft.
 WELL'S STATIC WATER LEVEL 43 ft. below land surface measured on mo/day/yr. 4-5-13.....
 Pump test data: Well water was ft. after hours pumping gpm
 EST. YIELD. N/A gpm. Well water was ft. after hours pumping gpm
 Bore Hole Diameter 10 in. to 110 ft., and in. to ft.
 WELL WATER TO BE USED AS: Public water supply Geothermal Injection well
 Domestic Feedlot Oil field water supply Dewatering Other (Specify below)
 Irrigation Industrial Domestic-lawn & garden Monitoring well Stock
 Was a chemical/bacteriological sample submitted to Department? Yes No
 If yes, mo/day/yr sample was submitted.....
 Water well disinfected? Yes No

5 TYPE OF CASING USED: Steel PVC Other
CASING JOINTS: Glued Clamped Welded Threaded
 Casing diameter 5 in. to 110 ft., Diameter in. to ft., Diameter in. to ft.
 Casing height above land surface 18 in., Weight SDR: 26 lbs./ft., Wall thickness or gauge No.
TYPE OF SCREEN OR PERFORATION MATERIAL:
 Steel Stainless Steel PVC Other (Specify)
 Brass Galvanized Steel None used (open hole)
SCREEN OR PERFORATION OPENINGS ARE:
 Continuous slot Mill slot Gauze wrapped Torch cut Drilled holes None (open hole)
 Louvered shutter Key punched Wire wrapped Saw cut Other (specify)
SCREEN-PERFORATED INTERVALS: From 110 ft. to 60 ft., From ft. to ft.
 From ft. to ft., From ft. to ft.
GRAVEL PACK INTERVALS: From 110 ft. to 20 ft., From ft. to ft.
 From ft. to ft., From ft. to ft.

6 GROUT MATERIAL: Neat cement Cement grout Bentonite Other
 Grout Intervals: From ft. to ft., From 20 ft. to 0 ft., From ft. to ft.
 What is the nearest source of possible contamination:
 Septic tank Lateral lines Pit privy Livestock pens Insecticide storage Other (specify below)
 Sewer lines Cesspool Sewage lagoon Fuel storage Abandoned water well
 Watertight sewer lines Seepage pit Feedyard Fertilizer storage Oil well/gas well Lake
 Direction from well South Distance from well 500ft.....

FROM	TO	LITHOLOGIC LOG	FROM	TO	LITHO. LOG (cont.) or PLUGGING INTERVALS
0	2	Top soil	79	98	Gray shale/ sandstone/ coal mixed
2	5	Ironated sandstone	98	110	Fire clay
5	10	Gray & yellow shale			
10	17	Sandstone/ ironated coal			
17	24	Light gray shale			
24	45	Fine clay			
45	52	Sandstone/ coal/ iron pyrite			
52	55	Fire clay			
55	79	Sandstone/ coal/ streaks of iron pyrite/ bits of gray shale			

7 CONTRACTOR'S OR LANDOWNER'S CERTIFICATION: This water well was constructed, reconstructed, or plugged under my jurisdiction and was completed on (mo/day/year) 4-5-13 and this record is true to the best of my knowledge and belief.
 Kansas Water Well Contractor's License No. 134 This Water Well Record was completed on (mo/day/year) 4-26-13
 under the business name of Rosencrantz- Bemis by (signature) *Rosencrantz- Bemis*

INSTRUCTIONS: Use typewriter or ball point pen. PLEASE PRESS FIRMLY and PRINT clearly. Please fill in blanks and check the correct answers. Send three copies (white, blue, pink) to Kansas Department of Health and Environment, Bureau of Water, Geology Section, 1000 SW Jackson St., Suite 420, Topeka, Kansas 66612-1367. Telephone 785-296-5524. Send one copy to WATER WELL OWNER and retain one for your records. I include fee of \$5.00 for each constructed well. Visit us at <http://www.kdheks.gov/waterwell/index.html>.