

County: Trego Fraction: SW-NE-NW Sec. 10 T 12 S R 22 E/W

**CORRECTION(S) TO WATER WELL COMPLETION RECORD (WWC-5)**  
(to rectify lacking or incorrect information)

Owner: North Fork Farms LLC

Location was listed as:

Section-Township-Range: 10-12 S-22 W

Fraction (1/4 1/4 1/4): NW-NE-SW

Location changed to:

10-12 S-22 W

SW-NE-NW

Other changes: Initial statements: \_\_\_\_\_

Changed to: \_\_\_\_\_

Comments: \_\_\_\_\_

Verification method: Transposed Fractions match marked location and Aerial Map

initials: DF date: 4/15/14

Submitted by: Kansas Geological Survey, Data Resources Library, 1930 Constant Ave., Lawrence KS 66047-3726  
to: Kansas Dept of Health & Environment, Bureau of Water, 1000 SW Jackson, Suite 420, Topeka, KS 66612-1367.

1 LOCATION OF WATER WELL: County: Trego Fraction: NW 1/4 NE 1/4 SW 1/4 Section Number: 10 Township Number: 12 S Range Number: 22 E (W)  
 Distance and direction from nearest town or city street address of well if located within city?  
Go to Hrd and 330 Av Then South int Posture

2 WATER WELL OWNER: North Fork Farms LLC  
 RR#, St. Address, Box #: 1412 NW Westwood Dr  
 City, State ZIP Code: Blue Springs, MO 64015  
 Global Positioning Systems (decimal degrees, min. of 4 digits)  
 Latitude: \_\_\_\_\_  
 Longitude: \_\_\_\_\_  
 Elevation: \_\_\_\_\_  
 Datum: \_\_\_\_\_  
 Data Collection Method: \_\_\_\_\_

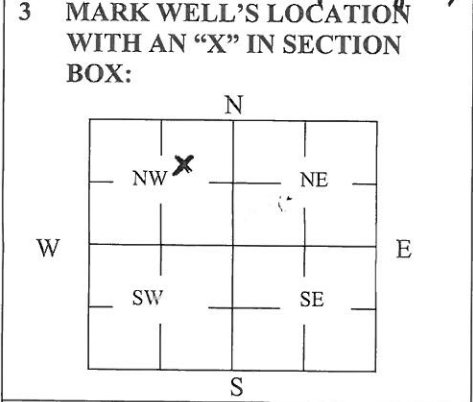

4 DEPTH OF WELL 92 ft.  
 WELL'S STATIC WATER LEVEL 79 ft.  
 WELL WAS USED AS:  
 1 Domestic 5 Public Water Supply 9 Dewatering  
 2 Irrigation 6 Oil Field Water Supply 10 Monitoring  
 3 Feedlot 7 Domestic (Lawn & Garden) 11 Injection Well  
 4 Industrial 8 Air Conditioning 12 Other \_\_\_\_\_  
 Was a chemical/bacteriological sample submitted to Department? Yes \_\_\_\_\_ No X

5 TYPE OF BLANK CASING USED:  
 1 Steel 3 RMP (SR) 5 Wrought 7 Fiberglass 9 Other (Specify below)  
 2 PVC 4 ABS 6 Asbestos-Cement 8 Concrete Tile \_\_\_\_\_  
 Blank casing diameter 5 in. Was casing pulled? Yes X No \_\_\_\_\_ If yes, how much 6'  
 Casing height above or below land surface 72 in.

6 GROUT PLUG MATERIAL: 1 Neat cement 2 Cement grout 3 Bentonite 4 Other \_\_\_\_\_  
 Grout Plug Intervals: From 16 ft. to 6 ft., From \_\_\_\_\_ ft. to \_\_\_\_\_ ft., From \_\_\_\_\_ to \_\_\_\_\_ ft.  
 What is the nearest source of possible contamination:  
 1 Septic tank 6 Seepage pit 11 Fuel Storage 16 Other (specify below)  
 2 Sewer lines 7 Pit privy 12 Fertilizer storage  
 3 Watertight sewer lines 8 Sewage lagoon 13 Insecticide storage  
 4 Lateral lines 9 Feedyard 14 Abandoned water well Direction from well? S/W  
 5 Cess pool 10 Livestock pens 15 Oil well/Gas well How many feet? 100

FROM	TO	PLUGGING MATERIALS	FROM	TO	PLUGGING MATERIALS
<u>92</u>	<u>75</u>	<u>Clean Sand</u>			
<u>75</u>	<u>16</u>	<u>Clay Soil</u>			
<u>16</u>	<u>6</u>	<u>Bentonite</u>			
<u>6</u>	<u>0</u>	<u>Clay Soil</u>			

7 CONTRACTOR'S OR LANDOWNER'S CERTIFICATION: This water well was plugged under my jurisdiction and was completed on (mo/day/year) 9/9/2013 and this record is true to the best of my knowledge and belief. Kansas Water Well Contractor's License No. \_\_\_\_\_. This Water Well Record was completed on (mo/day/year) 10/24/13 under the business name of Bollig Ditching & Well Service by (signature) Eddie Bollig

INSTRUCTIONS: Use typewriter or ballpoint pen. Please press firmly and print clearly. Please fill in blanks, underline or circle the correct answers. Send top three copies to Kansas Department of Health and Environment, Bureau of Water, Geology Section, 1000 SW Jackson St., Ste. 420, Topeka, Kansas 66612-1367. Telephone: 785/296-5522. Send one to Water Well Owner and retain one for your records. Visit us at <http://www.kdheks.gov/geo/waterwells>.