

# WATER WELL RECORD Form WWC-5

☒ Original Record ☐ Correction ☐ Change in Well Use

Division of Water  
Resources App. No.

Well ID

EMW-12R

<b>1 LOCATION OF WATER WELL:</b> County: Trego	Fraction SE ¼ SE ¼ NE ¼ NE ¼	Section Number 17	Township Number T 12 S	Range Number R 23 E W
---	---------------------------------	----------------------	---------------------------	--------------------------

<b>2 WELL OWNER:</b> Last Name: First: Business: Triplett, Inc. Address: P.O. Box 647 City: Salina State: KS ZIP: 67402	Street or Rural Address where well is located (if unknown, distance and direction from nearest town or intersection): If at owner's address, check here: <input type="checkbox"/> I-70 & Hwy 283; Wakeeney, KS
--	---

<b>3 LOCATE WELL WITH "X" IN SECTION BOX:</b> N W E S ----- 1 mile -----	<b>4 DEPTH OF COMPLETED WELL:</b> ..... ft. Depth(s) Groundwater Encountered: 1) ..... ft. 2) ..... ft. 3) ..... ft., or 4) <input type="checkbox"/> Dry Well WELL'S STATIC WATER LEVEL: 82.38 ft. <input checked="" type="checkbox"/> below land surface, measured on (mo-day-yr) 3-6-18 <input type="checkbox"/> above land surface, measured on (mo-day-yr) ..... Pump test data: Well water was ..... ft. after ..... hours pumping ..... gpm Well water was ..... ft. after ..... hours pumping ..... gpm Estimated Yield: ..... gpm Bore Hole Diameter: 8.5 in. to 103 ft. and ..... in. to ..... ft.	<b>5 Latitude:</b> 39.01173 ..... (decimal degrees) <b>Longitude:</b> 99.89078 ..... (decimal degrees) <b>Horizontal Datum:</b> <input type="checkbox"/> WGS 84 <input checked="" type="checkbox"/> NAD 83 <input type="checkbox"/> NAD 27 <b>Source for Latitude/Longitude:</b> <input checked="" type="checkbox"/> GPS (unit make/model: .....) (WAAS enabled? <input type="checkbox"/> Yes <input checked="" type="checkbox"/> No) <input type="checkbox"/> Land Survey <input type="checkbox"/> Topographic Map <input type="checkbox"/> Online Mapper: .....
--	---	--

<b>7 WELL WATER TO BE USED AS:</b>		
1. Domestic: <input type="checkbox"/> Household <input type="checkbox"/> Lawn & Garden <input type="checkbox"/> Livestock	5. <input type="checkbox"/> Public Water Supply: well ID ..... 6. <input type="checkbox"/> Dewatering: how many wells? ..... 7. <input type="checkbox"/> Aquifer Recharge: well ID ..... 8. <input checked="" type="checkbox"/> Monitoring: well ID EMW-12R 9. Environmental Remediation: well ID ..... <input type="checkbox"/> Air Sparge <input type="checkbox"/> Soil Vapor Extraction <input type="checkbox"/> Recovery <input type="checkbox"/> Injection	10. <input type="checkbox"/> Oil Field Water Supply: lease ..... 11. Test Hole: well ID ..... <input type="checkbox"/> Cased <input type="checkbox"/> Uncased <input type="checkbox"/> Geotechnical 12. Geothermal: how many bores? ..... a) Closed Loop <input type="checkbox"/> Horizontal <input type="checkbox"/> Vertical b) Open Loop <input type="checkbox"/> Surface Discharge <input type="checkbox"/> Inj. of Water 13. <input type="checkbox"/> Other (specify): .....

Was a chemical/bacteriological sample submitted to KDHE? ☐ Yes ☒ No If yes, date sample was submitted: .....  
Water well disinfected? ☐ Yes ☒ No

<b>8 TYPE OF CASING USED:</b> <input type="checkbox"/> Steel <input checked="" type="checkbox"/> PVC <input type="checkbox"/> Other ..... CASING JOINTS: <input type="checkbox"/> Glued <input type="checkbox"/> Clamped <input type="checkbox"/> Welded <input checked="" type="checkbox"/> Threaded Casing diameter 4 in. to 100 ft., Diameter ..... in. to ..... ft., Diameter ..... in. to ..... ft. Casing height above land surface 5 in. Weight ..... lbs./ft. Wall thickness or gauge No. .... <b>TYPE OF SCREEN OR PERFORATION MATERIAL:</b> <input type="checkbox"/> Steel <input type="checkbox"/> Stainless Steel <input type="checkbox"/> Fiberglass <input checked="" type="checkbox"/> PVC <input type="checkbox"/> Other (Specify) ..... <input type="checkbox"/> Brass <input type="checkbox"/> Galvanized Steel <input type="checkbox"/> Concrete tile <input type="checkbox"/> None used (open hole) <b>SCREEN OR PERFORATION OPENINGS ARE:</b> <input type="checkbox"/> Continuous Slot <input checked="" type="checkbox"/> Mill Slot <input type="checkbox"/> Gauze Wrapped <input type="checkbox"/> Torch Cut <input type="checkbox"/> Drilled Holes <input type="checkbox"/> Other (Specify) ..... <input type="checkbox"/> Louvered Shutter <input type="checkbox"/> Key Punched <input type="checkbox"/> Wire Wrapped <input type="checkbox"/> Saw Cut <input type="checkbox"/> None (Open Hole) <b>SCREEN-PERFORATED INTERVALS:</b> From 75 ft. to 100 ft., From ..... ft. to ..... ft., From ..... ft. to ..... ft. <b>GRAVEL PACK INTERVALS:</b> From 73 ft. to 100 ft., From ..... ft. to ..... ft., From ..... ft. to ..... ft.
---

<b>9 GROUT MATERIAL:</b> <input type="checkbox"/> Neat cement <input type="checkbox"/> Cement grout <input checked="" type="checkbox"/> Bentonite <input type="checkbox"/> Other ..... Grout Intervals: From 0.5 ft. to 73 ft., From ..... ft. to ..... ft., From ..... ft. to ..... ft. <b>Nearest source of possible contamination:</b> <input type="checkbox"/> Septic Tank <input type="checkbox"/> Lateral Lines <input type="checkbox"/> Pit Privy <input type="checkbox"/> Livestock Pens <input type="checkbox"/> Insecticide Storage <input type="checkbox"/> Sewer Lines <input type="checkbox"/> Cess Pool <input type="checkbox"/> Sewage Lagoon <input type="checkbox"/> Fuel Storage <input type="checkbox"/> Abandoned Water Well <input type="checkbox"/> Watertight Sewer Lines <input type="checkbox"/> Seepage Pit <input type="checkbox"/> Feedyard <input type="checkbox"/> Fertilizer Storage <input type="checkbox"/> Oil Well/Gas Well <input type="checkbox"/> Other (Specify) ..... Direction from well? ..... Distance from well? ..... ft.
---

10 FROM	TO	LITHOLOGIC LOG	FROM	TO	LITHO. LOG (cont.) or PLUGGING INTERVALS
0	0.5	Asphalt			
0.5	12	Silty clay with trace sand			
12	43	Sandy clay with caliche, clay, trace gravel			
43	65	Gravelly Sand with caliche, trace gravel			
65	82	Gravelly sand with cemented streaks			
82	103	Sand with clay			

Notes: Wakeeney Travel Plaza Site: KDHE Project Code: U6-098-00782
---

**11 CONTRACTOR'S OR LANDOWNER'S CERTIFICATION:** This water well was ☒ constructed, ☐ reconstructed, or ☐ plugged under my jurisdiction and was completed on (mo-day-yr) 2/28/18 ..... and this record is true to the best of my knowledge and belief. Kansas Water Well Contractor's License No. 881 ..... This Water Well Record was completed on (mo-day-yr) 4/17/18 ..... under the business name of Woofert Pump & Well ..... Signature: .....

TREGO

17-12-23W

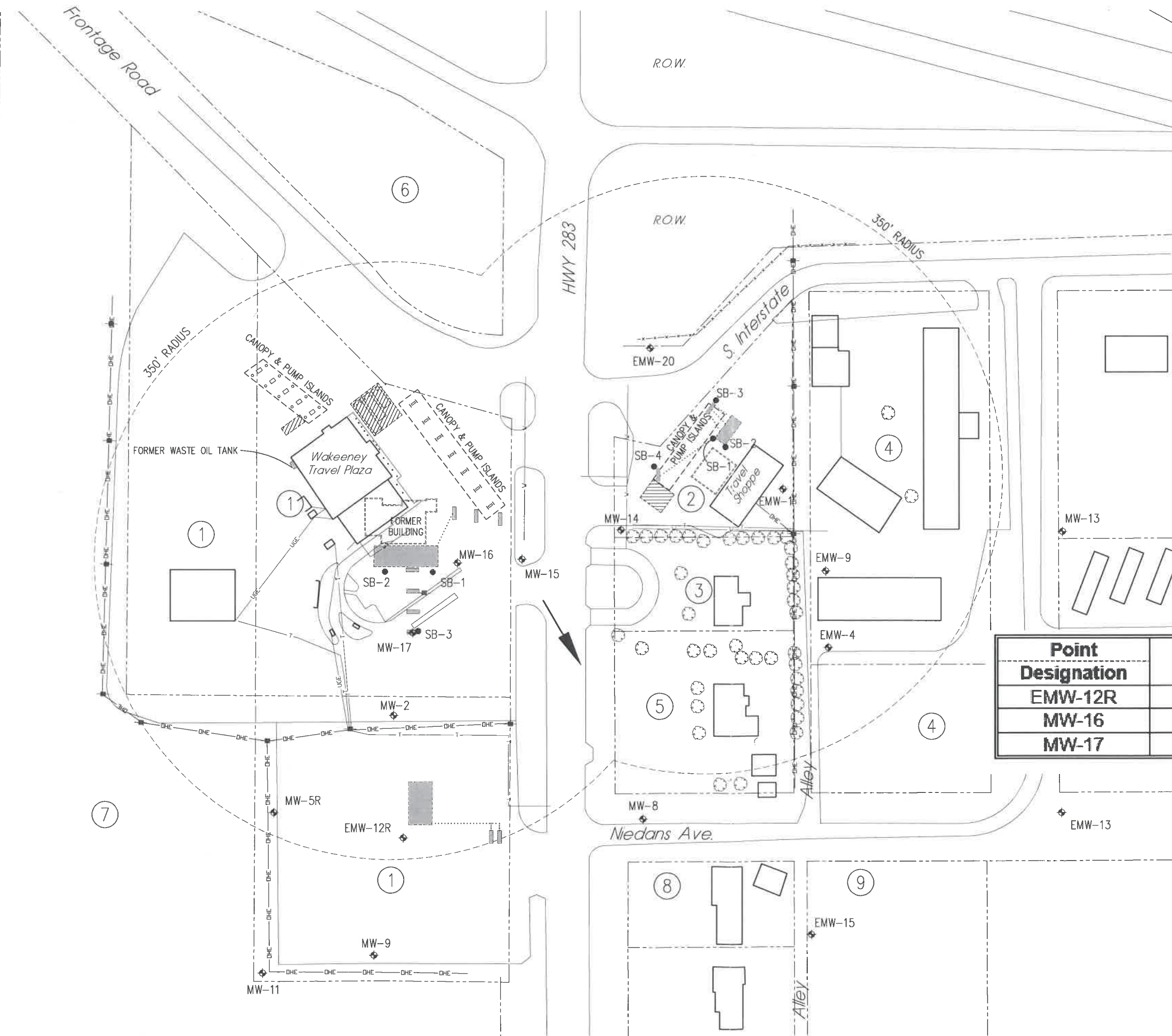

**LEGEND**

- MONITORING WELL
- SOIL BORING
- UNDERGROUND WATER
- OVERHEAD ELECTRIC
- TELEPHONE
- SANITARY SEWER
- UNDERGROUND ELECTRIC
- FORMER FUEL PIPING
- FENCE
- POWER POLE/LIGHT POLE
- GROUNDWATER FLOW DIRECTION
- FORMER TANK BASINS/PUMP ISLANDS
- CURRENT TANK BASINS
- APPROXIMATE PROPERTY LINE

Properties are residential unless otherwise indicated.

- Property 23678 LLC (Triplett, Inc.)- Wakeeney Travel Plaza
- Service Oil - Travel Shoppe #1
- Noah, Susan - full basement
- Wakeeney Hospitality, Inc - Econo Lodge/Brazen Bull
- Purinton, Ed & Deborah - crawl space
- Malanco, Inc - c/o Joe Madden - agricultural
- Madden, Mollie & Edward Jr. - agricultural
- Day, Shannon & Lora - crawl space
- Niedens, Jerry & Hedwig - agricultural
- Balthazar, Michael - trailer park
- Boeve, John & Luetta - Boeve's Coins and Antiques

Point Designation	Latitude	Longitude
EMW-12R	39.01173	99.89078
MW-16	39.01262	99.89056
MW-17	39.01239	99.89075

RECEIVED  
MAY 07 2018  
BUREAU OF WATER

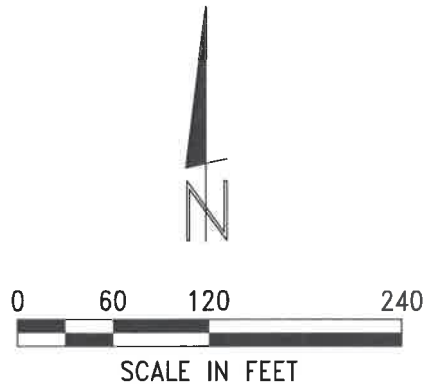

REVISIONS

BY

**MILCO**  
Environmental  
Services, Inc.

Kearney, NE (308) 237-5923  
McCook, NE (308) 345-4741  
Colby, KS (785) 460-1955

WAKEENEY TRAVEL PLAZA & TRAVEL SHOPPE #1

**SITE BASE MAP - 350' RADIUS**

I-70 & HWY 283, WAKEENEY, KANSAS U6-098-00782/U6-098-00850

SCALE: AS SHOWN

PROJECT NO. M251-P24-02

DATE: APRIL, 2018

FIELD BOOK M&A DWG NO.

DRAWN BY: BSF

APRVD BY:

SHEET

FIGURE 2.1

This document, and the ideas and designs incorporated herein, as an instrument of professional service, is the property of Miller & Associates and is not to be used in whole or in part, for any other project without the written authorization of Miller & Associates.