

**WATER WELL RECORD**

**Form WWC-5**

Division of Water Resources App. No. 20100478

**1 LOCATION OF WATER WELL:** Fraction NE 1/4 NW 1/4 SW 1/4 SE 1/4 Section Number 31 Township Number T 12 S Range Number R 31  E  W

Gove

Street/Rural Address of Well Location; if unknown, distance & direction from nearest town or intersection: If at owner's address, check here  So of Oakley to Gove Rd, East 2 miles to Tank Battery, North 1/4 mile, East into

**2 WATER WELL OWNER:** Donald G. Ziegler, Trustee  
 RR#, St. Address, Box # Rt 2, Box 4  
 City, State, ZIP Code Grainfield, KS 67737

**Global Positioning System (GPS) information:**  
 Latitude: \_\_\_\_\_ (in decimal degrees)  
 Longitude: \_\_\_\_\_ (in decimal degrees)  
 Elevation: \_\_\_\_\_  
 Datum:  WGS 84,  NAD 83,  NAD 27  
 Collection Method:  
 GPS unit (Make/Model: \_\_\_\_\_)  
 Digital Map/Photo,  Topographic Map,  Land Survey  
 Est. Accuracy:  <3 m,  3-5 m,  5-15 m,  >15 m

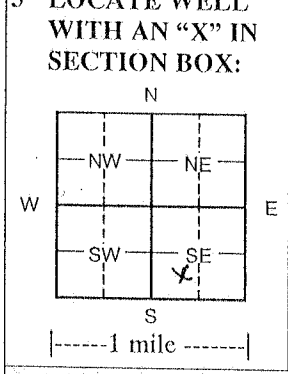

**4 DEPTH OF COMPLETED WELL** 90 ft.

Depth(s) Groundwater Encountered (1) \_\_\_\_\_ ft. (2) \_\_\_\_\_ ft. (3) \_\_\_\_\_ ft.

WELL'S STATIC WATER LEVEL NA ft. below land surface measured on mo/day/yr

Pump test data: Well water was \_\_\_\_\_ ft. after \_\_\_\_\_ hours pumping \_\_\_\_\_ gpm

EST. YIELD \_\_\_\_\_ gpm; Well water was \_\_\_\_\_ ft. after \_\_\_\_\_ hours pumping \_\_\_\_\_ gpm

WELL WATER TO BE USED AS:  Public water supply  Geothermal  Injection well  
 Domestic  Feedlot  Oil field water supply  Dewatering  Other (Specify below)  
 Irrigation  Industrial  Domestic-lawn & garden  Monitoring well

Was a chemical/bacteriological sample submitted to Department?  Yes  No

If yes, mo/day/yr sample was submitted \_\_\_\_\_

Water Well Disinfected?  Yes  No

**5 TYPE OF CASING USED:**  Steel  PVC  Other

CASING JOINTS:  Glued  Clamped  Welded  Threaded

Casing diameter 4.5 in. to 50 ft., Diameter \_\_\_\_\_ in. to \_\_\_\_\_ ft., Diameter \_\_\_\_\_ in. to \_\_\_\_\_ ft.

Casing height above land surface 18 in., Weight 2.38 lbs./ft. Wall thickness or gauge No. .248

TYPE OF SCREEN OR PERFORATION MATERIAL:  
 Steel  Stainless Steel  PVC  Other (Specify) \_\_\_\_\_  
 Brass  Galvanized Steel  None used (open hole)

SCREEN OR PERFORATION OPENINGS ARE:  
 Continuous Slot  Mill slot  Gauze wrapped  Torch cut  Drilled holes  None (open hole)  
 Louvered shutter  Key punched  Wire wrapped  Saw cut  Other (specify) \_\_\_\_\_

SCREEN-PERFORATED INTERVALS: From 50 ft. to 90 ft., From \_\_\_\_\_ ft. to \_\_\_\_\_ ft.

GRAVEL PACK INTERVALS: From 20 ft. to 90 ft., From \_\_\_\_\_ ft. to \_\_\_\_\_ ft.

**6 GROUT MATERIAL:**  Neat cement  Cement grout  Bentonite  Other

Grout Intervals From 0 ft. to 20 ft. From \_\_\_\_\_ ft. to \_\_\_\_\_ ft. From \_\_\_\_\_ ft. to \_\_\_\_\_ ft.

What is the nearest source of possible contamination:  
 Septic tank  Lateral lines  Pit privy  Livestock pens  Insecticide storage  Other (specify below)  
 Sewer lines  Cesspool  Sewage lagoon  Fuel storage  Abandoned water well  
 Watertight sewer lines  Seepage pit  Feedyard  Fertilizer storage  Oil well/gas well None

Direction from well \_\_\_\_\_ Distance from well \_\_\_\_\_

FROM	TO	LITHOLOGIC LOG	FROM	TO	LITHO. LOG (cont.) or PLUGGING INTERVALS
0	2	Surface	76	92	Yellow ochre
2	12	Loess	92	100	Black shale
12	21	Clay			
21	28	Fine to med sand			
28	31	Caliche			
31	41	Caliche with sand str			
41	58	Fine to med sand & gravel str			
58	64	Clay			
64	76	Fine to med sand & sonme gravel with Clay str			

**7 CONTRACTOR'S OR LANDOWNER'S CERTIFICATION:** This water well was constructed, reconstructed, or  plugged under my jurisdiction and was completed on (mo/day/year) 11/22/10 and this record is true to the best of my knowledge and belief.

Kansas Water Well Contractor's License No. 554 or 783 This Water Well Record was completed on (mo/day/year) 12-2-10  
 under the business name of Woofter Pump & Well Inc. by (signature) [Signature]

**INSTRUCTIONS:** Please fill in blanks and check the correct answers. Send three copies (white, blue, pink) to Kansas Department of Health and Environment, Bureau of Water, Geology Section, 1000 SW Jackson St., Suite 420, Topeka, Kansas 66612-1367. Telephone 785-296-5522. Send one to WATER WELL OWNER and retain one for your records. Include fee of \$5.00 for each constructed well. Visit us at <http://www.kdheks.gov/waterwell/index.html>.