

WATER WELL RECORD

Form WWC-5

Division of Water Resources; App. No.

1 LOCATION OF WATER WELL:	Fraction	Section Number	Township Number	Range Number
County: Lincoln	NE ¼ SE ¼ NE ¼	1	T 12 S	R 8 W
Distance and direction from nearest town or city street address of well if located within city? ~50' SW of 232 W. Lincoln Ave., Lincoln KS		Global Positioning System (decimal degrees, min. of 4 digits)		
		Latitude: <u>N 39.04007°</u>		
		Longitude: <u>W 98.15156°</u>		
		Elevation: <u>RIM: 1383.82; TOC: 1383.50</u>		
		Datum: <u>NAVD83 WGS 84 -per surveyor</u> (KGS)		
		Data Collection Method: <u>legal survey</u>		

2 WATER WELL OWNER: Quik Way, Inc.
 RR#, St. Address, Box # : PO Box 282
 City, State, ZIP Code : Lincoln, KS 67455

3 LOCATE WELL'S LOCATION WITH AN "X" IN SECTION BOX:	4 DEPTH OF COMPLETED WELL 13.80 ft.				
<div style="border: 1px solid black; padding: 5px; margin: 0 auto; width: 80px;"> <p style="text-align:center;">N</p> <table style="width:100%; border-collapse: collapse;"> <tr> <td style="border: 1px solid black; width: 40px; height: 40px; text-align:center;">NW</td> <td style="border: 1px solid black; width: 40px; height: 40px; text-align:center;">NE X</td> </tr> <tr> <td style="border: 1px solid black; width: 40px; height: 40px; text-align:center;">SW</td> <td style="border: 1px solid black; width: 40px; height: 40px; text-align:center;">SE</td> </tr> </table> <p style="text-align:center;">S</p> </div>	NW	NE X	SW	SE	<p style="text-align:center;">MW6</p> <p>Depth(s) Groundwater Encountered 1 _____ ft. 2 _____ ft. 3 _____ ft.</p> <p>WELL'S STATIC WATER LEVEL <u>12.80</u> ft. below land surface measured on mo/day/yr <u>11/25/14</u></p> <p>Pump test data: Well water was _____ ft. after _____ hours pumping _____ gpm</p> <p>Est. Yield _____ gpm: Well water was _____ ft. after _____ hours pumping _____ gpm</p> <p>WELL WATER TO BE USED AS: 5 Public water supply 8 Air conditioning 11 Injection well</p> <p>1 Domestic 3 Feed lot 6 Oil field water supply 9 Dewatering 12 Other (Specify below)</p> <p>2 Irrigation 4 Industrial 7 Domestic (lawn & garden) 10 Monitoring well</p> <p>Was a chemical/bacteriological sample submitted to Department? Yes _____ No X; If yes, mo/day/yr</p> <p>Sample was submitted _____ Water Well Disinfected? Yes _____ No X</p>
NW	NE X				
SW	SE				

5 TYPE OF CASING USED:

1 Steel	3 RMP (SR)	6 Asbestos-Cement	8 Concrete tile	9 Other (specify below)
2 PVC	4 ABS	7 Fiberglass	CASING JOINTS: Glued _____ Clamped _____	Welded _____
			Threaded _____	X

Blank casing diameter 2 in. to 3.80 ft., Dia _____ in. to _____ ft., Dia _____ in. to _____ ft.

Casing height below land surface 0.32 ft., Weight _____ lbs./ft. Wall thickness or gauge No. _____

TYPE OF SCREEN OR PERFORATION MATERIAL:

1 Steel	3 Stainless steel	5 Fiberglass	7 PVC	9 ABS	11 Other (specify)
2 Brass	4 Galvanized steel	6 Concrete tile	8 RM (SR)	10 Asbestos-Cement	12 None used (open hole)

SCREEN OR PERFORATION OPENINGS ARE:

1 Continuous slot	3 Mill slot	5 Gauze wrapped	7 Torch cut	9 Drilled holes	11 None (open hole)
2 Louvered shutter	4 Key punched	6 Wire wrapped	8 Saw Cut	10 Other (specify)	

SCREEN-PERFORATED INTERVALS: From 3.80 ft. to 13.80 ft. From _____ ft. to _____ ft.

GRAVEL PACK INTERVALS: From 3 ft. to 14.16 ft. From _____ ft. to _____ ft.

6 GROUT MATERIAL: 1 Neat cement 2 Cement grout **3** Bentonite **4** Other Concrete: 0-1'

Grout Intervals From 1 ft. to 3 ft. From _____ ft. to _____ ft. From _____ ft. to _____ ft.

What is the nearest source of possible contamination:

1 Septic tank	4 Lateral lines	7 Pit privy	10 Livestock pens	13 Insecticide Storage	16 Other (specify below)
2 Sewer lines	5 Cess pool	8 Sewage lagoon	11 Fuel storage	14 Abandoned water well	
3 Watertight sewer lines	6 Seepage pit	9 Feedyard	12 Fertilizer storage	15 Oil well/ gas well	

Direction from well? SW How many feet? ~50'

FROM	TO	LITHOLOGIC LOG	FROM	TO	LITHOLOGIC LOG
0	2	Topsoil			
2	3	Dark silty clay			
3	5	Sand and gravel fill material			
5	9.5	Silty sand becoming coarser w/ depth, Mottled, Fe staining			
9.5	10	Poorly cemented, highly weathered, Laminated silt stone, mottled, gray, Fe Staining			
10	14.16	Poorly cemented, highly weathered, Laminated silt stone, w/ sand, light			

7 CONTRACTOR'S OR LANDOWNER'S CERTIFICATION: This water well was (1) constructed, (2) reconstructed, or (3) plugged under my jurisdiction and was completed on (mo/day/year) 10/28/14 and this record is true to the best of my knowledge and belief.

Kansas Water Well Contractor's License No. 757. This Water Well Record was completed on (mo/day/year) 12/16/14 under the business name of Larsen & Associates, Inc. by (signature) _____

INSTRUCTIONS: Please fill in blanks or circle the correct answers. Send top three copies to Kansas Department of Health and Environment, Bureau of Water, Geology Section, 1000 SW Jackson St., Suite 420, Topeka, Kansas 66612-1367. Telephone 785-296-5522. Send one to WATER WELL OWNER and retain one for your records. Fee of \$5.00 for each constructed well. Visit us at <http://www.kdheks.gov/waterwell>.

TRITERRA LAND SERVICES

P.O. Box 546
Clearwater, Kansas 67026
Cell (316) 648-3617 Fax (620) 584-4371
E-mail: triterrals@yahoo.com

SURVEYING OF MONITORING WELLS
QUIK WAY, INC.
LINCOLN, KANSAS

The above site is in Section 6, Township 12 South, Range 7 West of the Sixth Principal Meridian, Lincoln County, Kansas. The Southeast corner of Section 6 was assigned coordinates of 00.00 North and 00.00 West.

The vertical control was an NGS benchmark at Lincoln City Hall listed as 'Lincoln Center', described as a benchmark disk located 8 feet west of the centerline of the main door, 12 feet east of the northwest corner of the building in the center of the first stone window sill near the entrance, and 2.5 feet above the ground. The control point was established as a chiseled 'X' on top of the old concrete sign base at the southwest corner of the site.

The Latitude and Longitude were recorded from a GPS unit. The site is located on the 7.5' quad map titled "Lincoln".

ID	NORTH	WEST	LATITUDE	LONGITUDE	ELEVATION
SE CORNER 6-12S-7W	00.00	00.00			
Control Point	3685.15	5087.66	39.04034	98.15125	1386.38
MW-1 NW NW SW NW	3696.12	5085.27	39.04039	98.15125	RIM 1385.93 TOC 1385.65
MW-2 NW NW SW NW	3681.65	5030.29	39.04032	98.15102	RIM 1386.53 TOC 1386.07
MW-3 SW NW SW NW	3587.21	5103.92	39.04010	98.15129	RIM 1384.48 TOC 1384.20
MW-4 NE NW SW NW	3792.37	4949.89	39.04065	98.15076	RIM 1391.67 TOC 1391.38
MW-5 (Sec 1-12S-8W) NE NE SE NE	3664.31	5178.41	39.04033	98.15159	RIM 1383.71 TOC 1383.50
MW-6 (Sec 1-12S-8W) SE NE SE NE	3595.36	5168.94	39.04007	98.15156	RIM 1383.82 TOC 1383.50
MW-7 NW NW SW NW	3741.93	5076.14	39.04052	98.15121	RIM 1386.73 TOC 1386.43
MW-8 SW NW SW NW	3476.64	4962.76	39.03979	98.15082	RIM 1388.47 TOC 1388.21

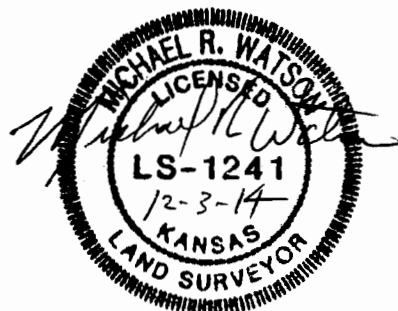

State of Kansas KDHE/BER Well Tag Form

Quik Way, Inc.

KDHE Project Code:

U	5	0	5	3	1	4	4	8	3
----------	----------	----------	----------	----------	----------	----------	----------	----------	----------

Well Tag Number	Well Number
0050780	MW1
0050781	MW2
0050784	MW3
0050788	MW4
0050787	MW5
0050782	MW6
0050786	MW7
0050783	MW8

After completing this form, photocopy it and keep the copy for your files.
Send the original to the address below.

Kansas Department of Health & Environment
Bureau of Environmental Remediation
1000 SW Jackson, Suite 410
Topeka, KS 66612-1367