

1 LOCATION OF WATER WELL: County: <u>Russell</u>	Fraction <u>SE 1/4 SE 1/4 NE 1/4 1/4</u>	Section Number <u>27</u>	Township Number <u>T 13 S</u>	Range Number <u>14</u> <input type="checkbox"/> E <input checked="" type="checkbox"/> W
--	---	-----------------------------	----------------------------------	--

Street/Rural Address of Well Location; if unknown, distance & direction from nearest town or intersection: If at owner's address, check here East 9th and North Elm St.

Global Positioning Systems (GPS) information:
 Latitude: 38.893912 (in decimal degrees)
 Longitude: -98.857475 (in decimal degrees)
 Elevation: 1822
 Datum: WGS84, NAD83, NAD27
 Collection Method:
 GPS unit (Make/Model: _____)
 Digital Map/Photo, Topographic Map, Land Survey
 Est. Accuracy: < 3 m, 3-5 m, 5-15 m, > 15 m

2 WATER WELL OWNER: City of Russell
 RR#, St. Address, Box #: 133 W 8th
 City, State ZIP Code: Russell, KS 67665

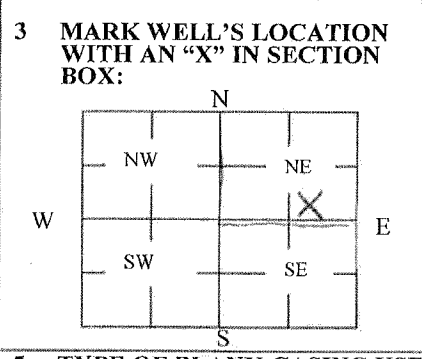

4 DEPTH OF WELL 15 ft.
 WELL'S STATIC WATER LEVEL 10 ft.
 WELL WAS USED AS:
 Domestic Public Water Supply Dewatering
 Irrigation Oil Field Water Supply Monitoring
 Feedlot Domestic (Lawn & Garden) Injection Well
 Industrial Air Conditioning Other _____
 Was a chemical/bacteriological sample submitted to Department? Yes No

5 TYPE OF BLANK CASING USED:

Steel RMP (SR) Wrought Fiberglass Other (Specify below) _____
 PVC ABS Asbestos-Cement Concrete Tile _____

Blank casing diameter 2 in. Was casing pulled? Yes No If yes, how much all 15'
 Casing height above or below land surface below - 6 in.

6 GROUT PLUG MATERIAL: Neat cement Cement grout Bentonite Other _____

Grout Plug Intervals: From 2 ft. to 15 ft., From _____ ft. to _____ ft., From _____ to _____ ft.

What is the nearest source of possible contamination:
 Septic tank Seepage pit Fuel Storage Other (specify below) _____
 Sewer lines Pit privy Fertilizer storage _____
 Watertight sewer lines Sewage lagoon Insecticide storage _____
 Lateral lines Feedyard Abandoned water well Oil well/Gas well Direction from well? NE
 Cess pool Livestock pens How many feet? ~250

FROM	TO	PLUGGING MATERIALS	FROM	TO	PLUGGING MATERIALS
0	2	Top Soil			
2	15	Bentonite Chips			
					RECEIVED
					JAN 02 2013
					BUREAU OF WATER

7 CONTRACTOR'S OR LANDOWNER'S CERTIFICATION: This water well was plugged under my jurisdiction and was completed on (mo/day/year) 11/15/2012 and this record is true to the best of my knowledge and belief. Kansas Water Well Contractor's License No. N/A. This Water Well Record was completed on (mo/day/year) 11/21/2012 under the business name of SCS Engineers by (signature) Bret H. Clements

INSTRUCTIONS: Use typewriter or ballpoint pen. Please press firmly and print clearly. Please fill in blanks, underline or circle the correct answers. Send top three copies to Kansas Department of Health and Environment, Bureau of Water, Geology Section, 1000 SW Jackson St., Ste. 420, Topeka, Kansas 66612-1367. Telephone: 785/296-5524. Send one to Water Well Owner and retain one for your records. Visit us at <http://www.kdheks.gov/waterwell/index.html>.