

WATER WELL RECORD

Form WWC-5

Division of Water Resources App. No.

1 LOCATION OF WATER WELL: County: <u>ELLIS</u>	Fraction $\frac{1}{4}$ $\frac{1}{4}$ <u>SE</u> $\frac{1}{4}$ <u>SE</u> $\frac{1}{4}$	Section Number <u>19</u>	Township No. T <u>13</u> S	Range Number R <u>18</u> <input type="checkbox"/> E <input checked="" type="checkbox"/> W
Street/Rural Address of Well Location; if unknown, distance & direction from nearest town or intersection: If at owner's address, check here <input checked="" type="checkbox"/> .		Global Positioning System (GPS) information: Latitude: (in decimal degrees) Longitude: (in decimal degrees) Elevation: Datum: <input type="checkbox"/> WGS 84, <input type="checkbox"/> NAD 83, <input type="checkbox"/> NAD 27 Collection Method: <input type="checkbox"/> GPS unit (Make/Model:) <input type="checkbox"/> Digital Map/Photo, <input type="checkbox"/> Topographic Map, <input type="checkbox"/> Land Survey Est. Accuracy: <input type="checkbox"/> <3 m, <input type="checkbox"/> 3-5 m, <input type="checkbox"/> 5-15 m, <input type="checkbox"/> >15 m		

2 WATER WELL OWNER:
RR#, Street Address, Box #: Joel Fort
City, State, ZIP Code: 4100 Millstone Circle
Hays, Ks. 67601

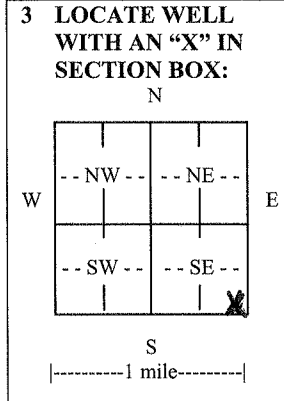

4 DEPTH OF COMPLETED WELL 68 ft.
Depth(s) Groundwater Encountered (1) 30 ft. (2) ft. (3) ft.
WELL'S STATIC WATER LEVEL ft. below land surface measured on mo/day/yr
Pump test data: Well water was ft. after hours pumping gpm
EST. YIELD gpm. Well water was ft. after hours pumping gpm
Bore Hole Diameter 10 in. to 6.8 ft., and in. to ft.
WELL WATER TO BE USED AS: Public water supply Geothermal Injection well
 Domestic Feedlot Oil field water supply Dewatering Other (Specify below)
 Irrigation Industrial Domestic-lawn & garden Monitoring well
Was a chemical/bacteriological sample submitted to Department? Yes No
If yes, mo/day/yr sample was submitted
Water well disinfected? Yes No

5 TYPE OF CASING USED: Steel PVC Other
CASING JOINTS: Glued Clamped Welded Threaded
Casing diameter 4.5 in. to 6.8 ft., Diameter in. to ft., Diameter in. to ft.
Casing height above land surface 18 in., Weight 160 lbs./ft., Wall thickness or gauge No. SDR 26
TYPE OF SCREEN OR PERFORATION MATERIAL:
 Steel Stainless Steel PVC Other (Specify)
 Brass Galvanized Steel None used (open hole)
SCREEN OR PERFORATION OPENINGS ARE:
 Continuous slot Mill slot Gauze wrapped Torch cut Drilled holes None (open hole)
 Louvered shutter Key punched Wire wrapped Saw cut Other (specify)
SCREEN-PERFORATED INTERVALS: From 6.8 ft. to 5.8 ft., From ft. to ft.
From ft. to ft., From ft. to ft.
GRAVEL PACK INTERVALS: From 6.8 ft. to 5.6 ft., From ft. to ft.
From ft. to ft., From ft. to ft.

6 GROUT MATERIAL: Neat cement Cement grout Bentonite Other
Grout Intervals: From 3 ft. to 26 ft., From 51 ft. to 56 ft., From ft. to ft.
What is the nearest source of possible contamination:
 Septic tank Lateral lines Pit privy Livestock pens Insecticide storage Other (specify below)
 Sewer lines Cesspool Sewage lagoon Fuel storage Abandoned water well
 Watertight sewer lines Seepage pit Feedyard Fertilizer storage Oil well/gas well
Direction from well East Distance from well 301

FROM	TO	LITHOLOGIC LOG	FROM	TO	LITHO. LOG (cont.) or PLUGGING INTERVALS
0	2	Top Soil			
2	26	CLAY			
26	36	CLAY & SAND			
36	45	FINE SAND			
45	55	FINE & COARSE SAND			
55	58	GRAVEL			
58	63	FINE SAND			
63	64	CLAY			
64	68	SHALE			

7 CONTRACTOR'S OR LANDOWNER'S CERTIFICATION: This water well was constructed, reconstructed, or plugged under my jurisdiction and was completed on (mo/day/year) 7/24/10 and this record is true to the best of my knowledge and belief.
Kansas Water Well Contractor's License No. 478 This Water Well Record was completed on (mo/day/year) 7/28/10 under the business name of Phonixwater well by (signature) [Signature]

INSTRUCTIONS: Use typewriter or ball point pen. PLEASE PRESS FIRMLY and PRINT clearly. Please fill in blanks and check the correct answers. Send three copies (white, blue, pink) to Kansas Department of Health and Environment, Bureau of Water, Geology Section, 1000 SW Jackson St., Suite 420, Topeka, Kansas 66612-1367. Telephone 785-296-5522. Send one copy to WATER WELL OWNER and retain one for your records. Include fee of \$5.00 for each constructed well. Visit us at <http://www.kdheks.gov/waterwell/index.html>.