

**WATER WELL PLUGGING RECORD Form WWC-5P KSA 82a-1212 ID NO.**

261539

|   |                              |                     |                           |   |
|---|------------------------------|---------------------|---------------------------|---|
| <b>1 LOCATION OF WATER WELL:</b><br>County: Ellis | Fraction<br>SW ¼ ¼ SW ¼ SE ¼ | Section Number<br>5 | Township Number<br>T 13 S | Range Number<br>20 <input type="checkbox"/> E <input checked="" type="checkbox"/> W |
|---|------------------------------|---------------------|---------------------------|---|

Street/Rural Address of Well Location; if unknown, distance & direction from nearest town or intersection: If at owner's address, check here  Ellis Power Plant  
501 W. 6th Street  
Ellis, KS

**Global Positioning Systems (GPS) information:**  
 Latitude: \_\_\_\_\_ (in decimal degrees)  
 Longitude: \_\_\_\_\_ (in decimal degrees)  
 Elevation: \_\_\_\_\_  
 Horizontal Datum:  WGS84,  NAD83,  NAD27  
 Collection Method: \_\_\_\_\_  
 GPS unit (Make/Model: \_\_\_\_\_)  
 Digital Map/Photo,  Topographic Map,  Land Survey  
 Est. Accuracy:  < 3 m,  3-5 m,  5-15 m,  > 15 m

**2 WATER WELL OWNER:** Ellis Power Plant/City of Ellis  
 RR#, St. Address, Box #: 815 Jefferson  
 City, State ZIP Code: Ellis, KS 67637

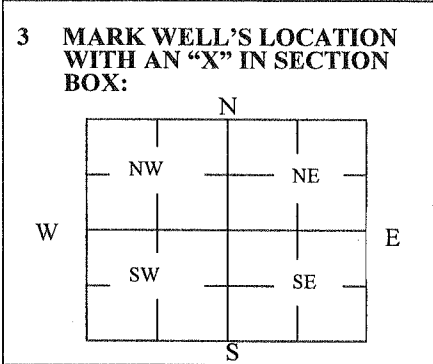

**4 DEPTH OF WELL** 20 ft.  
 WELL'S STATIC WATER LEVEL \_\_\_\_\_ ft  
 WELL WAS USED AS:  
 Domestic  Public Water Supply  Dewatering  
 Irrigation  Oil Field Water Supply  Monitoring  
 Feedlot  Domestic (Lawn & Garden)  Injection Well  
 Industrial  Air Conditioning  Other \_\_\_\_\_  
 Was a chemical/bacteriological sample submitted to Department? Yes  No

**5 TYPE OF BLANK CASING USED:**

Steel  RMP (SR)  Wrought  Fiberglass  Other (Specify below) \_\_\_\_\_  
 PVC  ABS  Asbestos-Cement  Concrete Tile

Blank casing diameter 2 in. Was casing pulled? Yes  No  If yes, how much ~3ft below ground surface  
 Casing height above or below land surface \_\_\_\_\_ in.

**6 GROUT PLUG MATERIAL:**  Neat cement  Cement grout  Bentonite  Other \_\_\_\_\_

Grout Plug Intervals: From 3 ft. to 20 ft., From \_\_\_\_\_ ft. to \_\_\_\_\_ ft., From \_\_\_\_\_ ft. to \_\_\_\_\_ ft.

What is the nearest source of possible contamination:

|   |   |   |  |
|---|---|---|--|
| <input type="checkbox"/> Septic tank            | <input type="checkbox"/> Seepage pit    | <input type="checkbox"/> Fuel storage         | <input type="checkbox"/> Other (specify below) _____ |
| <input type="checkbox"/> Sewer lines            | <input type="checkbox"/> Pit privy      | <input type="checkbox"/> Fertilizer storage   |  |
| <input type="checkbox"/> Watertight sewer lines | <input type="checkbox"/> Sewage lagoon  | <input type="checkbox"/> Insecticide storage  |  |
| <input type="checkbox"/> Lateral lines          | <input type="checkbox"/> Feedyard       | <input type="checkbox"/> Abandoned water well | Direction from well? _____                           |
| <input type="checkbox"/> Cess pool              | <input type="checkbox"/> Livestock pens | <input type="checkbox"/> Oil well/Gas well    | How many feet? _____                                 |

| FROM | TO | PLUGGING MATERIALS | FROM | TO | PLUGGING MATERIALS |
|------|----|--------------------|------|----|--------------------|
| 3    | 20 | Bentonite          |      |    |                    |
|      |    |                    |      |    |                    |
|      |    |                    |      |    | MW-1               |
|      |    |                    |      |    |                    |
|      |    |                    |      |    |                    |

**7 CONTRACTOR'S OR LANDOWNER'S CERTIFICATION:** This water well was plugged under my jurisdiction and was completed on (mo/day/year) 3/31/15 and this record is true to the best of my knowledge and belief. Kansas Water Well Contractor's License No. \_\_\_\_\_. This Water Well Record was completed on (mo/day/year) 4/9/15 under the business name of GreenField Contractors, Inc. by (signature) Melina D. Melton

Send one white copy to Kansas Department of Health & Environment, Geology Section, 1000 SW Jackson Street, Ste. 420, Topeka, KS 66612-1367. Send one copy to WATER WELL OWNER and retain one for your records.  
 Visit us at <http://www.kdheks.gov/waterwell/index.html> Telephone 785-296-5524.