

**WATER WELL PLUGGING RECORD Form WWC-5P KSA 82a-1212 ID NO.**

261836

**1 LOCATION OF WATER WELL:** County: Ellis Fraction SW ¼ ¼ SW ¼ SE ¼ Section Number 5 Township Number T 13 S Range Number 20  E  W

Street/Rural Address of Well Location; if unknown, distance & direction from nearest town or intersection: If at owner's address, check here  Ellis Power Plant  
501 W. 6th Street  
Ellis, KS

**Global Positioning Systems (GPS) information:**  
Latitude: \_\_\_\_\_ (in decimal degrees)  
Longitude: \_\_\_\_\_ (in decimal degrees)  
Elevation: \_\_\_\_\_  
Horizontal Datum:  WGS84,  NAD83,  NAD27  
Collection Method:

**2 WATER WELL OWNER:** Ellis Power Plant/City of Ellis  
RR#, St. Address, Box #: 815 Jefferson  
City, State ZIP Code: Ellis, KS 67637

GPS unit (Make/Model: \_\_\_\_\_)  
 Digital Map/Photo,  Topographic Map,  Land Survey  
Est. Accuracy:  < 3 m,  3-5 m,  5-15 m,  > 15 m

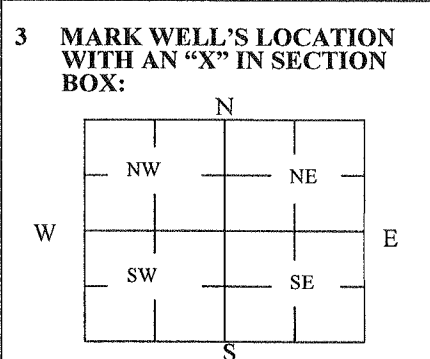

**4 DEPTH OF WELL** 20 \_\_\_\_\_ ft.  
WELL'S STATIC WATER LEVEL \_\_\_\_\_ ft  
WELL WAS USED AS:  
 Domestic  Public Water Supply  Dewatering  
 Irrigation  Oil Field Water Supply  Monitoring  
 Feedlot  Domestic (Lawn & Garden)  Injection Well  
 Industrial  Air Conditioning  Other \_\_\_\_\_  
Was a chemical/bacteriological sample submitted to Department? Yes  No

**5 TYPE OF BLANK CASING USED:**  
 Steel  RMP (SR)  Wrought  Fiberglass  Other (Specify below)  
 PVC  ABS  Asbestos-Cement  Concrete Tile  
Blank casing diameter 2 \_\_\_\_\_ in. Was casing pulled? Yes  No  If yes, how much ~3ft below ground surface  
Casing height above or below land surface \_\_\_\_\_ in.

**6 GROUT PLUG MATERIAL:**  Neat cement  Cement grout  Bentonite  Other \_\_\_\_\_  
Grout Plug Intervals: From 3 \_\_\_\_\_ ft. to 20 \_\_\_\_\_ ft., From \_\_\_\_\_ ft. to \_\_\_\_\_ ft., From \_\_\_\_\_ ft. to \_\_\_\_\_ ft.  
What is the nearest source of possible contamination:  
 Septic tank  Seepage pit  Fuel storage  Other (specify below)  
 Sewer lines  Pit privy  Fertilizer storage  
 Watertight sewer lines  Sewage lagoon  Insecticide storage  
 Lateral lines  Feedyard  Abandoned water well Direction from well? \_\_\_\_\_  
 Cess pool  Livestock pens  Oil well/Gas well How many feet? \_\_\_\_\_

| FROM | TO | PLUGGING MATERIALS | FROM | TO | PLUGGING MATERIALS |
|------|----|--------------------|------|----|--------------------|
| 3    | 20 | Bentonite          |      |    |                    |
|      |    |                    |      |    |                    |
|      |    |                    |      |    | MW-4               |
|      |    |                    |      |    |                    |
|      |    |                    |      |    |                    |
|      |    |                    |      |    |                    |

**7 CONTRACTOR'S OR LANDOWNER'S CERTIFICATION:** This water well was plugged under my jurisdiction and was completed on (mo/day/year) 3/31/15 and this record is true to the best of my knowledge and belief. Kansas Water Well Contractor's License No. \_\_\_\_\_ This Water Well Record was completed on (mo/day/year) 4/9/15 under the business name of GreenField Contractors, Inc. by (signature) *Melina D. Melwara*

Send one white copy to Kansas Department of Health & Environment, Geology Section, 1000 SW Jackson Street, Ste. 420, Topeka, KS 66612-1367. Send one copy to WATER WELL OWNER and retain one for your records.  
Visit us at <http://www.kdheks.gov/waterwell/index.html> Telephone 785-296-5524.