

<b>1 LOCATION OF WATER WELL:</b> County: Russell	Fraction ¼ NW¼ SW ¼ NW ¼	Section Number 02	Township Number T 14 S	Range Number 14 <input type="checkbox"/> E <input checked="" type="checkbox"/> W
Street/Rural Address of Well Location; if unknown, distance & direction from nearest town or intersection: If at owner's address, check here <input type="checkbox"/> 1415 S. Fossil St. Russell Kansas		<b>Global Positioning Systems (GPS) information:</b> Latitude: _____ (in decimal degrees) Longitude: _____ (in decimal degrees) Elevation: 1823.26 TOC Horizontal Datum: <input type="checkbox"/> WGS84, <input checked="" type="checkbox"/> NAD83, <input type="checkbox"/> NAD27 Collection Method:		

<b>2 WATER WELL OWNER:</b> Angela Dunn RR#, St. Address, Box #: 150 St. Peters Centre Blvd, Ste C City, State ZIP Code: St. Peters, MO 63376	<input type="checkbox"/> GPS unit (Make/Model: _____) <input type="checkbox"/> Digital Map/Photo, <input type="checkbox"/> Topographic Map, <input checked="" type="checkbox"/> Land Survey Est. Accuracy: <input checked="" type="checkbox"/> < 3 m, <input type="checkbox"/> 3-5 m, <input type="checkbox"/> 5-15 m, <input type="checkbox"/> > 15 m
--	--

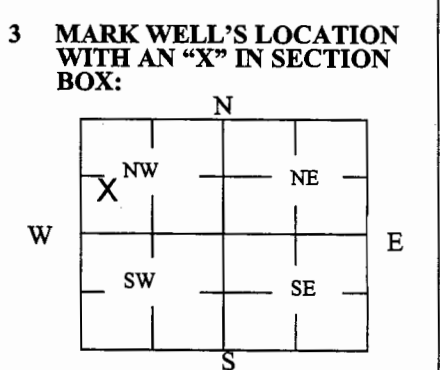

**4 DEPTH OF WELL** 23.10 ft.  
**WELL'S STATIC WATER LEVEL** 15.52 ft.  
**WELL WAS USED AS:**

<input type="checkbox"/> Domestic	<input type="checkbox"/> Public Water Supply	<input type="checkbox"/> Dewatering
<input type="checkbox"/> Irrigation	<input type="checkbox"/> Oil Field Water Supply	<input checked="" type="checkbox"/> Monitoring
<input type="checkbox"/> Feedlot	<input type="checkbox"/> Domestic (Lawn & Garden)	<input type="checkbox"/> Injection Well
<input type="checkbox"/> Industrial	<input type="checkbox"/> Air Conditioning	<input type="checkbox"/> Other _____

Was a chemical/bacteriological sample submitted to Department? Yes  No

**5 TYPE OF BLANK CASING USED:**

<input checked="" type="checkbox"/> Steel	<input type="checkbox"/> RMP (SR)	<input type="checkbox"/> Wrought	<input type="checkbox"/> Fiberglass	<input type="checkbox"/> Other (Specify below) _____
<input checked="" type="checkbox"/> PVC	<input type="checkbox"/> ABS	<input type="checkbox"/> Asbestos-Cement	<input type="checkbox"/> Concrete Tile	

Blank casing diameter 2 in. Was casing pulled? Yes  No  If yes, how much 3 ft.  
 Casing height above or below land surface 36 in.

**6 GROUT PLUG MATERIAL:**  Neat cement  Cement grout  Bentonite  Other \_\_\_\_\_

Grout Plug Intervals: From 3 ft. to 23.10 ft., From \_\_\_\_\_ ft. to \_\_\_\_\_ ft., From \_\_\_\_\_ ft. to \_\_\_\_\_ ft.

What is the nearest source of possible contamination:

<input type="checkbox"/> Septic tank	<input type="checkbox"/> Seepage pit	<input checked="" type="checkbox"/> Fuel storage	<input type="checkbox"/> Other (specify below) _____
<input type="checkbox"/> Sewer lines	<input type="checkbox"/> Pit privy	<input type="checkbox"/> Fertilizer storage	
<input type="checkbox"/> Watertight sewer lines	<input type="checkbox"/> Sewage lagoon	<input type="checkbox"/> Insecticide storage	
<input type="checkbox"/> Lateral lines	<input type="checkbox"/> Feedyard	<input type="checkbox"/> Abandoned water well	Direction from well? <u>Southeast</u>
<input type="checkbox"/> Cess pool	<input type="checkbox"/> Livestock pens	<input type="checkbox"/> Oil well/Gas well	How many feet? <u>125</u>

FROM	TO	PLUGGING MATERIALS	FROM	TO	PLUGGING MATERIALS
0	0.5	Concrete			
0.5	3	Compacted silt/clay			
3	23.10	Hydrated Bentonite chips			U6-084-00597

**7 CONTRACTOR'S OR LANDOWNER'S CERTIFICATION:** This water well was plugged under my jurisdiction and was completed on (mo/day/year) 2-6-19 and this record is true to the best of my knowledge and belief. Kansas Water Well Contractor's License No. 585. This Water Well Record was completed on (mo/day/year) 2-11-19 under the business name of Associated Environmental, Inc. by (signature) [Signature]

Send one white copy to Kansas Department of Health & Environment, Geology Section, 1000 SW Jackson Street, Ste. 420, Topeka, KS 66612-1367. Send one copy to WATER WELL OWNER and retain one for your records.  
 Visit us at <http://www.kdheks.gov/waterwell/index.html> Telephone 785-296-5524.

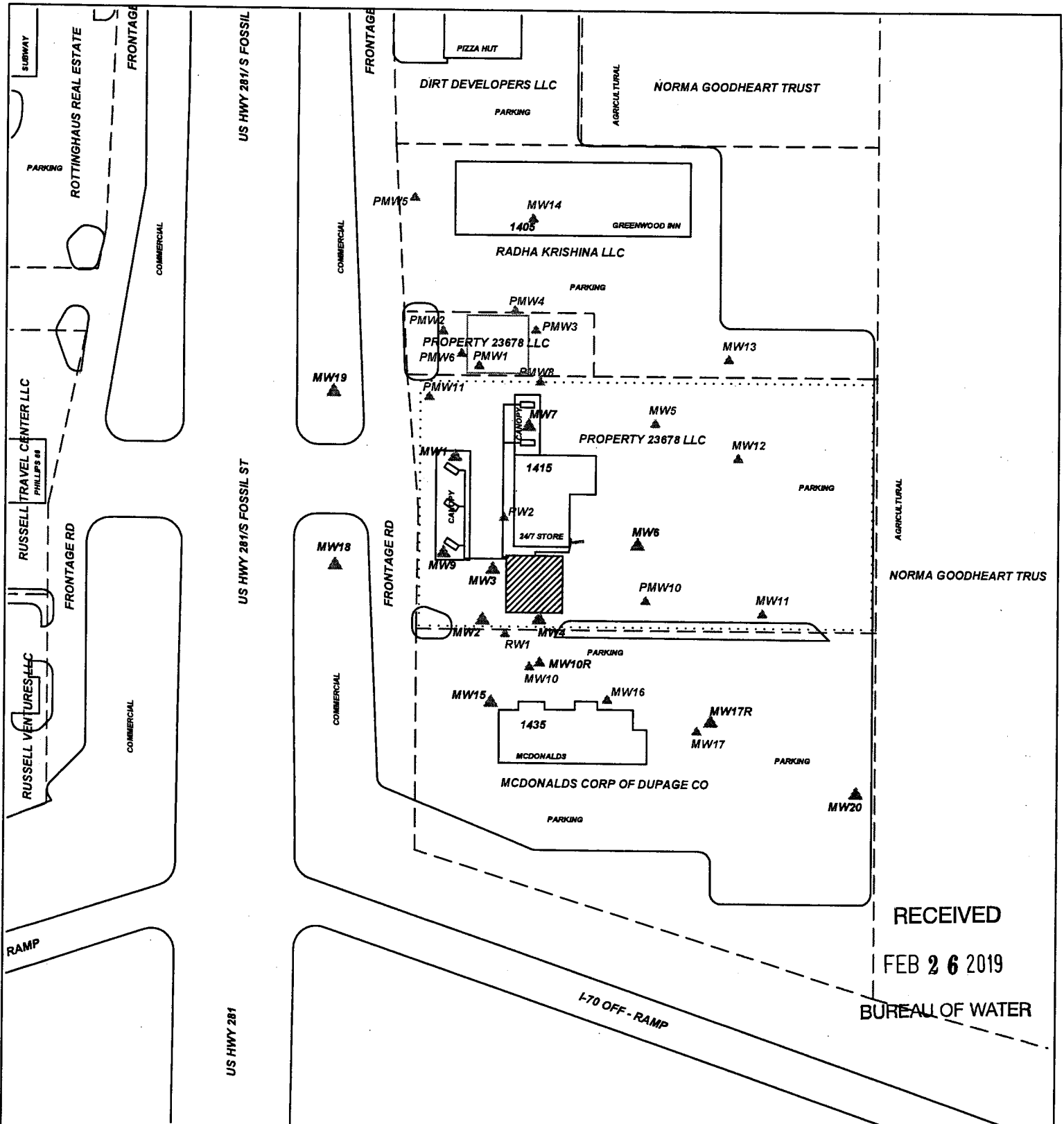

RECEIVED  
 FEB 26 2019  
 BUREAU OF WATER

PROJECT: **AMOCO #9689**  
 ADDRESS: **HWY. 70 & 281**  
 LOCATION: **RUSSELL, KS**  
 DRAWN BY: **B. STALNAKER** DATE: **10/25/17**  
 REVISED BY: **C. ROE** DATE: **10/10/18**  
 AEI JOB #: **TF507** KDHE JOB #: **U6-084-00597**

TITLE: **FIGURE 2.1  
 AREA BASE MAP  
 350' RADIUS**

**AEI** ASSOCIATED ENVIRONMENTAL INC.

LEGEND:  

 = (1) 12,000 G., (1) 10,000 G., (1) 8,000 G. GASOLINE, (1) 12,000 G. DIESEL, PRODUCT LINES & DISPENSERS  
 ● = MONITORING WELL  
 ▲ = PLUGGED/DESTROYED WELL  
 ..... = SUBJECT PROPERTY  
 - - - = PARCEL BOUNDARY

SCALE: **1" = 100'**

NOTES:  
 No basements observed within 500'.