

WATER WELL PLUGGING RECORD Form WWC-5P

KSA 82a-1212 ID NO.

MW-2

| | | | | |
|---|-----------------------------|----------------------|---------------------------|---|
| 1 LOCATION OF WATER WELL: County: Russell | Fraction ¼ NW¼ SW ¼ NW ¼ | Section Number 02 | Township Number T 14 S | Range Number 14 <input type="checkbox"/> E <input checked="" type="checkbox"/> W |
|---|-----------------------------|----------------------|---------------------------|---|

| | |
|---|--|
| Street/Rural Address of Well Location; if unknown, distance & direction from nearest town or intersection: If at owner's address, check here <input type="checkbox"/> 1415 S. Fossil St. Russell Kansas | Global Positioning Systems (GPS) information: Latitude: _____ (in decimal degrees) Longitude: _____ (in decimal degrees) Elevation: 1823.21 TOC Horizontal Datum: <input type="checkbox"/> WGS84, <input checked="" type="checkbox"/> NAD83, <input type="checkbox"/> NAD27 Collection Method: |
|---|--|

| | |
|--|--|
| 2 WATER WELL OWNER: Angela Dunn RR#, St. Address, Box #: 150 St. Peters Centre Blvd, Ste C City, State ZIP Code: St. Peters, MO 63376 | <input type="checkbox"/> GPS unit (Make/Model): _____ <input type="checkbox"/> Digital Map/Photo, <input type="checkbox"/> Topographic Map, <input checked="" type="checkbox"/> Land Survey Est. Accuracy: <input checked="" type="checkbox"/> < 3 m, <input type="checkbox"/> 3-5 m, <input type="checkbox"/> 5-15 m, <input type="checkbox"/> > 15 m |
|--|--|

3 MARK WELL'S LOCATION WITH AN "X" IN SECTION BOX:

4 DEPTH OF WELL 27.00 ft.
WELL'S STATIC WATER LEVEL 15.65 ft.
WELL WAS USED AS:

| | | |
|-------------------------------------|---|--|
| <input type="checkbox"/> Domestic | <input type="checkbox"/> Public Water Supply | <input type="checkbox"/> Dewatering |
| <input type="checkbox"/> Irrigation | <input type="checkbox"/> Oil Field Water Supply | <input checked="" type="checkbox"/> Monitoring |
| <input type="checkbox"/> Feedlot | <input type="checkbox"/> Domestic (Lawn & Garden) | <input type="checkbox"/> Injection Well |
| <input type="checkbox"/> Industrial | <input type="checkbox"/> Air Conditioning | <input type="checkbox"/> Other _____ |

Was a chemical/bacteriological sample submitted to Department? Yes No

5 TYPE OF BLANK CASING USED:

| | | | | |
|---|-----------------------------------|--|--|--|
| <input checked="" type="checkbox"/> Steel | <input type="checkbox"/> RMP (SR) | <input type="checkbox"/> Wrought | <input type="checkbox"/> Fiberglass | <input type="checkbox"/> Other (Specify below) _____ |
| <input checked="" type="checkbox"/> PVC | <input type="checkbox"/> ABS | <input type="checkbox"/> Asbestos-Cement | <input type="checkbox"/> Concrete Tile | |

Blank casing diameter 2 in. Was casing pulled? Yes No If yes, how much 3 ft
Casing height above or below land surface 36 in.

6 GROUT PLUG MATERIAL: Neat cement Cement grout Bentonite Other _____

Grout Plug Intervals: From 3 ft. to 27.00 ft., From _____ ft. to _____ ft., From _____ ft. to _____ ft.

What is the nearest source of possible contamination:

| | | | |
|---|---|--|--|
| <input type="checkbox"/> Septic tank | <input type="checkbox"/> Seepage pit | <input checked="" type="checkbox"/> Fuel storage | <input type="checkbox"/> Other (specify below) _____ |
| <input type="checkbox"/> Sewer lines | <input type="checkbox"/> Pit privy | <input type="checkbox"/> Fertilizer storage | |
| <input type="checkbox"/> Watertight sewer lines | <input type="checkbox"/> Sewage lagoon | <input type="checkbox"/> Insecticide storage | |
| <input type="checkbox"/> Lateral lines | <input type="checkbox"/> Feedyard | <input type="checkbox"/> Abandoned water well | Direction from well? <u>Northeast</u> |
| <input type="checkbox"/> Cess pool | <input type="checkbox"/> Livestock pens | <input type="checkbox"/> Oil well/Gas well | How many feet? <u>20</u> |

| FROM | TO | PLUGGING MATERIALS | FROM | TO | PLUGGING MATERIALS |
|------|-------|--------------------------|------|----|--------------------|
| 0 | 0.5 | Concrete | | | |
| 0.5 | 3 | Compacted silt/clay | | | |
| 3 | 27.00 | Hydrated Bentonite chips | | | U6-084-00597 |
| | | | | | |
| | | | | | |

7 CONTRACTOR'S OR LANDOWNER'S CERTIFICATION: This water well was plugged under my jurisdiction and was completed on (mo/day/year) 2-6-19 _____ and this record is true to the best of my knowledge and belief. Kansas Water Well Contractor's License No. 585. This Water Well Record was completed on (mo/day/year) 2-11-19 _____ under the business name of Associated Environmental, Inc. by (signature) _____

Send one white copy to Kansas Department of Health & Environment, Geology Section, 1000 SW Jackson Street, Ste. 420, Topeka, KS 66612-1367. Send one copy to WATER WELL OWNER and retain one for your records.
Visit us at <http://www.kdheks.gov/waterwell/index.html> Telephone 785-296-5524.

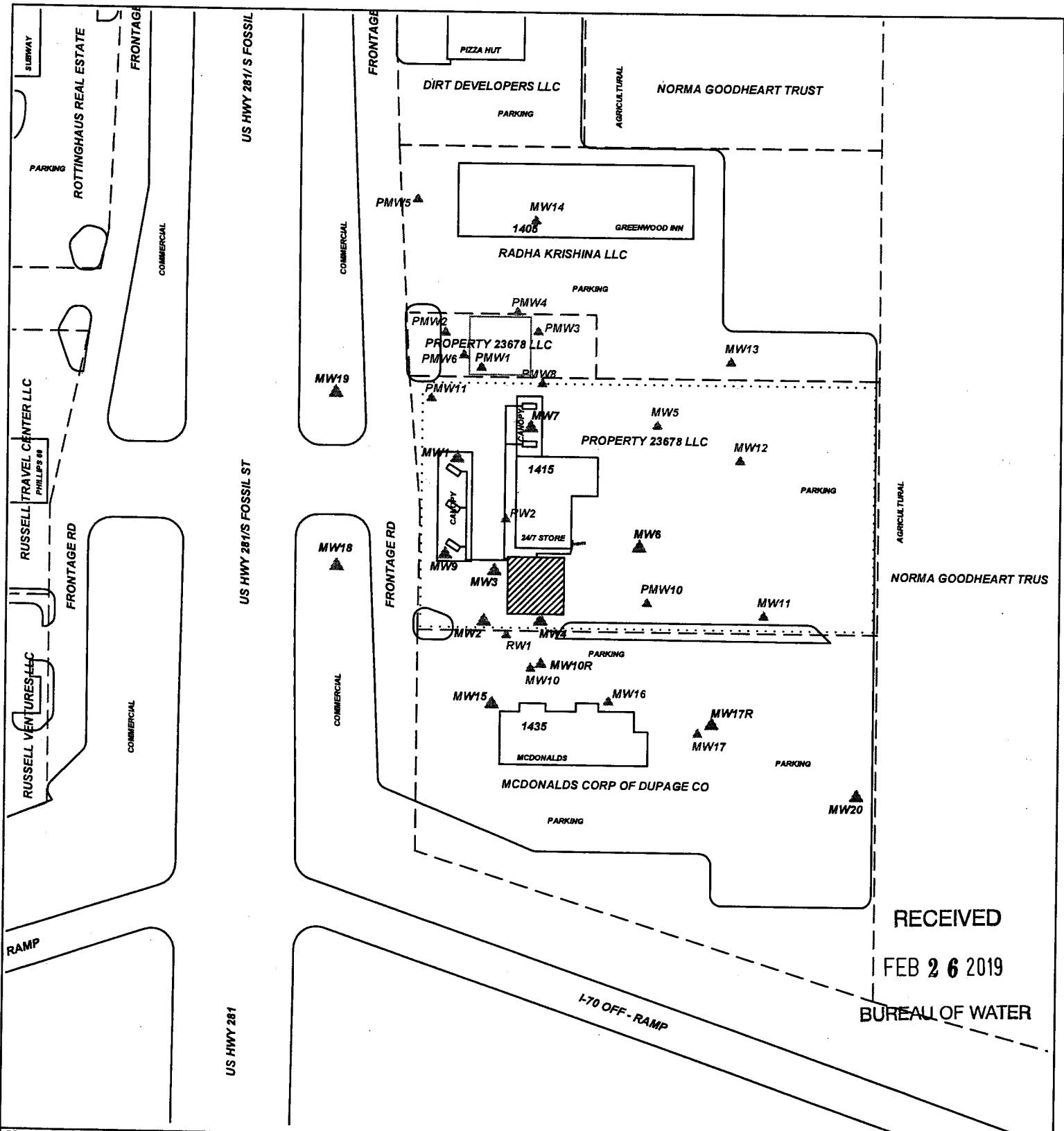

RECEIVED
FEB 26 2019

BUREAU OF WATER

PROJECT: **AMOCO #9689**

ADDRESS: **HWY. 70 & 281**

LOCATION: **RUSSELL, KS**

DRAWN BY: **B. STALNAKER** DATE: **10/25/17**

REVISED BY: **C. ROE** DATE: **10/10/18**

AEI JOB #: **TF507** KDHE JOB #: **U6-084-00597**

TITLE: **FIGURE 2.1
AREA BASE MAP
350' RADIUS**

AEI ASSOCIATED ENVIRONMENTAL INC.

LEGEND:

- = (1) 12,000 G., (1) 10,000 G., (1) 8,000 G. GASOLINE, (1) 12,000 G. DIESEL, PRODUCT LINES & DISPENSERS
- = MONITORING WELL
- = PLUGGED/DESTROYED WELL
- = SUBJECT PROPERTY
- = PARCEL BOUNDARY

SCALE: **1" = 100'**

NOTES:
No basements observed within 500'.