

WATER WELL PLUGGING RECORD Form WWC-5P

KSA 82a-1212 ID NO.

MW-6

1 LOCATION OF WATER WELL: Fraction 1/4 NW 1/4 SW 1/4 NW 1/4 Section Number 02 Township Number T 14 S Range Number 14 E W
 County: Russell

Street/Rural Address of Well Location; if unknown, distance & direction from nearest town or intersection: If at owner's address, check here 1415 S. Fossil St. Russell Kansas

Global Positioning Systems (GPS) information:
 Latitude: _____ (in decimal degrees)
 Longitude: _____ (in decimal degrees)
 Elevation: 1825.72 TOC
 Horizontal Datum: WGS84, NAD83, NAD27
 Collection Method: _____

2 WATER WELL OWNER: Angela Dunn
 RR#, St. Address, Box #: 150 St. Peters Centre Blvd, Ste C
 City, State ZIP Code: St. Peters, MO 63376

GPS unit (Make/Model: _____)
 Digital Map/Photo, Topographic Map, Land Survey
 Est. Accuracy: < 3 m, 3-5 m, 5-15 m, > 15 m

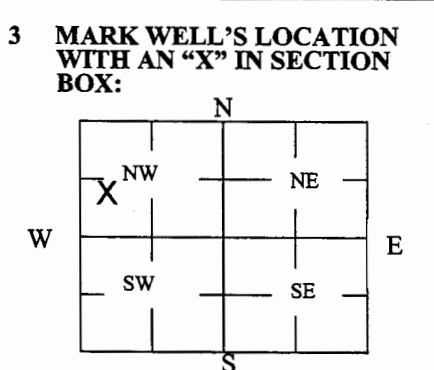

4 DEPTH OF WELL 24.38 ft.
 WELL'S STATIC WATER LEVEL 18.52 ft.
 WELL WAS USED AS:
 Domestic Public Water Supply Dewatering
 Irrigation Oil Field Water Supply Monitoring
 Feedlot Domestic (Lawn & Garden) Injection Well
 Industrial Air Conditioning Other _____
 Was a chemical/bacteriological sample submitted to Department? Yes No

5 TYPE OF BLANK CASING USED:
 Steel RMP (SR) Wrought Fiberglass Other (Specify below)
 PVC ABS Asbestos-Cement Concrete Tile
 Blank casing diameter 2 in. Was casing pulled? Yes No If yes, how much 3 ft
 Casing height above or below land surface 36 in.

6 GROUT PLUG MATERIAL: Neat cement Cement grout Bentonite Other _____
 Grout Plug Intervals: From 3 ft. to 24.38 ft., From _____ ft. to _____ ft., From _____ ft. to _____ ft.
 What is the nearest source of possible contamination:
 Septic tank Seepage pit Fuel storage Other (specify below)
 Sewer lines Pit privy Fertilizer storage
 Watertight sewer lines Sewage lagoon Insecticide storage
 Lateral lines Feedyard Abandoned water well Direction from well? West
 Cess pool Livestock pens Oil well/Gas well How many feet? 70

FROM	TO	PLUGGING MATERIALS	FROM	TO	PLUGGING MATERIALS
0	0.5	Asphalt			
0.5	3	Compacted silt/clay			
3	24.38	Hydrated Bentonite chips			U6-084-00597

7 CONTRACTOR'S OR LANDOWNER'S CERTIFICATION: This water well was plugged under my jurisdiction and was completed on (mo/day/year) 2-6-19 and this record is true to the best of my knowledge and belief. Kansas Water Well Contractor's License No. 585. This Water Well Record was completed on (mo/day/year) 2-11-19 under the business name of Associated Environmental, Inc. by (signature) [Signature]

Send one white copy to Kansas Department of Health & Environment, Geology Section, 1000 SW Jackson Street, Ste. 420, Topeka, KS 66612-1367. Send one copy to WATER WELL OWNER and retain one for your records.
 Visit us at <http://www.kdheks.gov/waterwell/index.html> Telephone 785-296-5524.

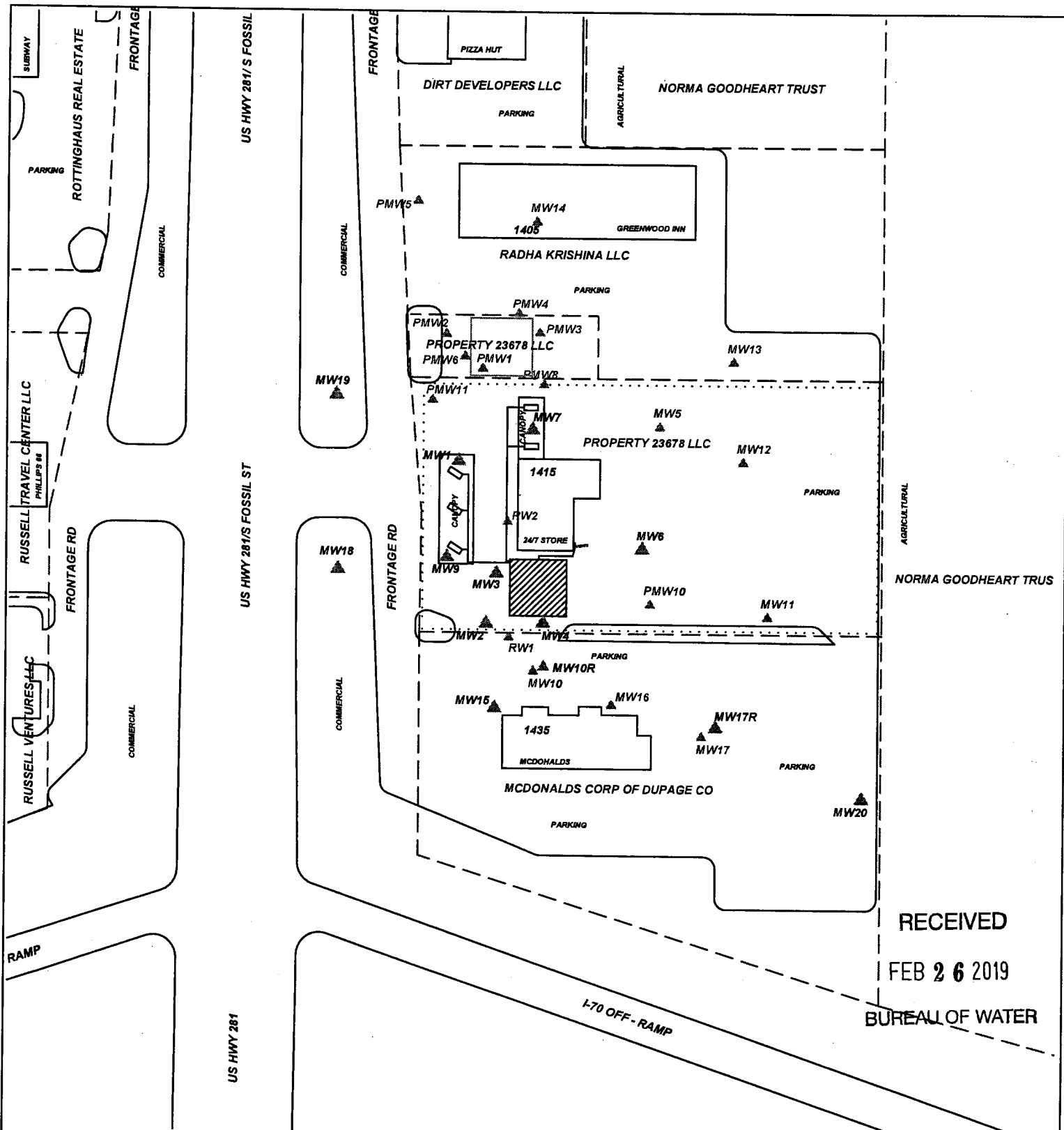

RECEIVED
 FEB 26 2019
 BUREAU OF WATER

PROJECT: AMOCO #9689		TITLE: FIGURE 2.1 AREA BASE MAP 350' RADIUS		LEGEND: <ul style="list-style-type: none"> = (1) 12,000 G., (1) 10,000 G., (1) 8,000 G. GASOLINE, (1) 12,000 G. DIESEL, PRODUCT LINES & DISPENSERS = MONITORING WELL = PLUGGED/DESTROYED WELL = SUBJECT PROPERTY = PARCEL BOUNDARY
ADDRESS: HWY. 70 & 281		ASSOCIATED ENVIRONMENTAL INC.		
LOCATION: RUSSELL, KS				
DRAWN BY: B. STALNAKER	DATE: 10/25/17			
REVISED BY: C. ROE	DATE: 10/10/18			
AEI JOB #: TF507	KDHE JOB #: U6-084-00597			
SCALE: 1" = 100' 	NOTES: No basements observed within 500'.			