

**1 LOCATION OF WATER WELL:** Fraction ¼ NW ¼ SW ¼ NW ¼ Section Number 02 Township Number T 14 S Range Number 14  E  W  
 County: Russell

Street/Rural Address of Well Location; if unknown, distance & direction from nearest town or intersection: If at owner's address, check here  1415 S. Fossil St. Russell Kansas

**Global Positioning Systems (GPS) information:**  
 Latitude: \_\_\_\_\_ (in decimal degrees)  
 Longitude: \_\_\_\_\_ (in decimal degrees)  
 Elevation: 1825.12 TOC  
 Horizontal Datum:  WGS84,  NAD83,  NAD27  
 Collection Method: \_\_\_\_\_

**2 WATER WELL OWNER:** Angela Dunn  
 RR#, St. Address, Box #: 150 St. Peters Centre Blvd, Ste C  
 City, State ZIP Code: St. Peters, MO 63376

GPS unit (Make/Model: \_\_\_\_\_)  
 Digital Map/Photo,  Topographic Map,  Land Survey  
 Est. Accuracy:  < 3 m,  3-5 m,  5-15 m,  > 15 m

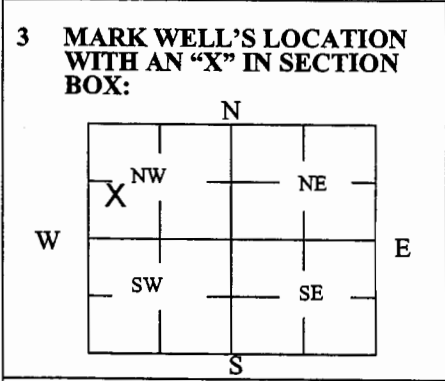

**4 DEPTH OF WELL** 28.70 ft.  
 WELL'S STATIC WATER LEVEL 17.50 ft.  
 WELL WAS USED AS:

Domestic  Public Water Supply  Dewatering  
 Irrigation  Oil Field Water Supply  Monitoring  
 Feedlot  Domestic (Lawn & Garden)  Injection Well  
 Industrial  Air Conditioning  Other \_\_\_\_\_

Was a chemical/bacteriological sample submitted to Department? Yes  No

**5 TYPE OF BLANK CASING USED:**

Steel  RMP (SR)  Wrought  Fiberglass  Other (Specify below) \_\_\_\_\_  
 PVC  ABS  Asbestos-Cement  Concrete Tile

Blank casing diameter 2 in. Was casing pulled? Yes  No  If yes, how much 3 ft  
 Casing height above or below land surface 36 in.

**6 GROUT PLUG MATERIAL:**  Neat cement  Cement grout  Bentonite  Other \_\_\_\_\_

Grout Plug Intervals: From 3 ft. to 28.70 ft., From \_\_\_\_\_ ft. to \_\_\_\_\_ ft., From \_\_\_\_\_ ft. to \_\_\_\_\_ ft.

What is the nearest source of possible contamination:

Septic tank  Seepage pit  Fuel storage  Other (specify below) \_\_\_\_\_  
 Sewer lines  Pit privy  Fertilizer storage  
 Watertight sewer lines  Sewage lagoon  Insecticide storage  
 Lateral lines  Feedyard  Abandoned water well Direction from well? South  
 Cess pool  Livestock pens  Oil well/Gas well How many feet? 135

FROM	TO	PLUGGING MATERIALS	FROM	TO	PLUGGING MATERIALS
0	0.5	Concrete			
0.5	3	Compacted silt/clay			
3	28.70	Hydrated Bentonite chips			U6-084-00597

**7 CONTRACTOR'S OR LANDOWNER'S CERTIFICATION:** This water well was plugged under my jurisdiction and was completed on (mo/day/year) 2-6-19 and this record is true to the best of my knowledge and belief. Kansas Water Well Contractor's License No. 585. This Water Well Record was completed on (mo/day/year) 2-11-19 under the business name of Associated Environmental, Inc. by (signature) *Angela Dunn*

Send one white copy to Kansas Department of Health & Environment, Geology Section, 1000 SW Jackson Street, Ste. 420, Topeka, KS 66612-1367. Send one copy to WATER WELL OWNER and retain one for your records.  
 Visit us at <http://www.kdheks.gov/waterwell/index.html> Telephone 785-296-5524.

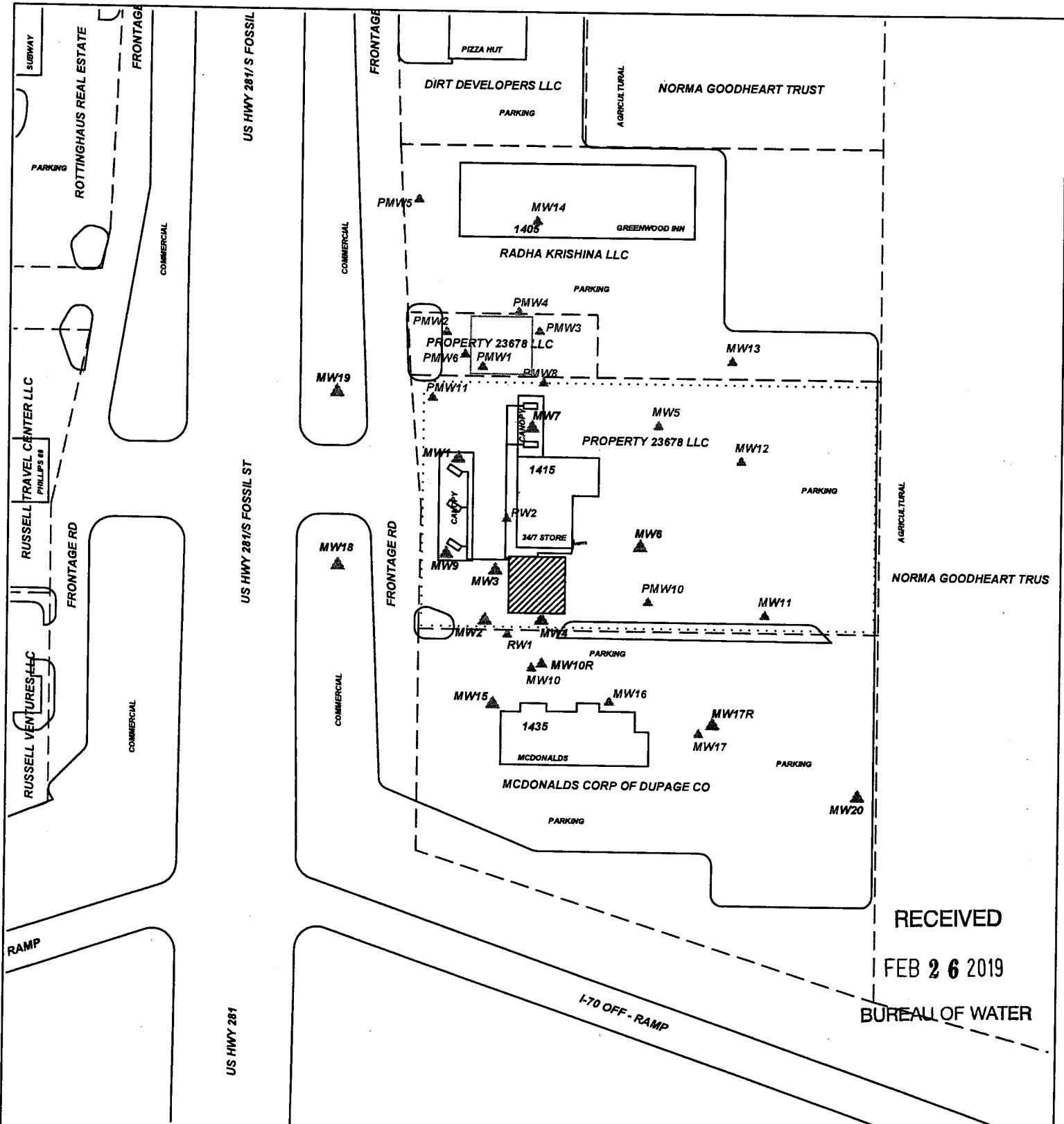

RECEIVED  
 FEB 26 2019  
 BUREAU OF WATER

**PROJECT:** AMOCO #9689  
**ADDRESS:** HWY. 70 & 281  
**LOCATION:** RUSSELL, KS  
**DRAWN BY:** B. STALNAKER DATE: 10/25/17  
**REVISED BY:** C. ROE DATE: 10/10/18  
**AEI JOB #:** TF507 KDHE JOB #: U6-084-00597

**TITLE:** **FIGURE 2.1**  
**AREA BASE MAP**  
**350' RADIUS**

**AEI ASSOCIATED ENVIRONMENTAL INC.**

**LEGEND:**

- = (1) 12,000 G., (1) 10,000 G., (1) 8,000 G. GASOLINE, (1) 12,000 G. DIESEL, PRODUCT LINES & DISPENSERS
- = MONITORING WELL
- = PLUGGED/DESTROYED WELL
- = SUBJECT PROPERTY
- = PARCEL BOUNDARY

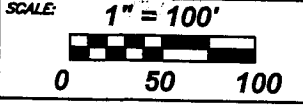

**NOTES:**  
 No basements observed within 500'.