

WATER WELL PLUGGING RECORD Form WWC-5P

KSA 82a-1212 ID NO.

MW-2

1 LOCATION OF WATER WELL: County: Russell Fraction 1/4 NW 1/4 SW 1/4 NW 1/4 Section Number 02 Township Number T 14 S Range Number 14 [] E [x] W

Street/Rural Address of Well Location; if unknown, distance & direction from nearest town or intersection: If at owner's address, check here [] 1415 S. Fossil St. Russell Kansas Global Positioning Systems (GPS) information: Latitude: (in decimal degrees) Longitude: (in decimal degrees) Elevation: 1823.21 TOC Horizontal Datum: [] WGS84, [x] NAD83, [] NAD27 Collection Method:

2 WATER WELL OWNER: Angela Dunn RR#, St. Address, Box #: 150 St. Peters Centre Blvd, Ste C City, State ZIP Code: St. Peters, MO 63376 [] GPS unit (Make/Model): [] Digital Map/Photo, [] Topographic Map, [x] Land Survey Est. Accuracy: [x] < 3 m, [] 3-5 m, [] 5-15 m, [] > 15 m

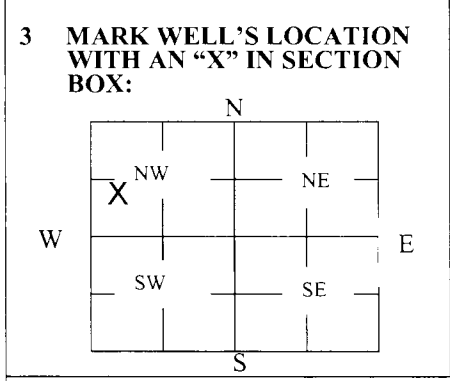

4 DEPTH OF WELL 27.00 ft. WELL'S STATIC WATER LEVEL 15.65 ft. WELL WAS USED AS: [] Domestic Irrigation Feedlot Industrial [] Public Water Supply Oil Field Water Supply Domestic (Lawn & Garden) Air Conditioning [] Dewatering Monitoring Injection Well Other [x] Monitoring Was a chemical/bacteriological sample submitted to Department? Yes [] No [x]

5 TYPE OF BLANK CASING USED: [] Steel [x] PVC [] RMP (SR) [] ABS [] Wrought [] Asbestos-Cement [] Fiberglass [] Concrete Tile [] Other (Specify below) Blank casing diameter 2 in. Was casing pulled? Yes [x] No [] If yes, how much 3 ft Casing height above or below land surface 36 in.

6 GROUT PLUG MATERIAL: [] Neat cement [] Cement grout [x] Bentonite [] Other Grout Plug Intervals: From 3 ft. to 27.00 ft., From ft. to ft., From ft. to ft. What is the nearest source of possible contamination: [] Septic tank [] Sewer lines [] Watertight sewer lines [] Lateral lines [] Cess pool [] Seepage pit [] Pit privy [] Sewage lagoon [] Feedyard [] Livestock pens [x] Fuel storage [] Fertilizer storage [] Insecticide storage [] Abandoned water well [] Oil well/Gas well [] Other (specify below) Direction from well? Northeast How many feet? 20

Table with 6 columns: FROM, TO, PLUGGING MATERIALS, FROM, TO, PLUGGING MATERIALS. Rows include: 0 to 0.5 Concrete; 0.5 to 3 Compacted silt/clay; 3 to 27.00 Hydrated Bentonite chips; U6-084-00597

7 CONTRACTOR'S OR LANDOWNER'S CERTIFICATION: This water well was plugged under my jurisdiction and was completed on (mo/day/year) 2-6-19 and this record is true to the best of my knowledge and belief. Kansas Water Well Contractor's License No. 585. This Water Well Record was completed on (mo/day/year) 2-11-19 under the business name of Associated Environmental, Inc. by (signature) [Signature]

Send one white copy to Kansas Department of Health & Environment, Geology Section, 1000 SW Jackson Street, Ste. 420, Topeka, KS 66612-1367. Send one copy to WATER WELL OWNER and retain one for your records. Visit us at http://www.kdheks.gov/waterwell/index.html Telephone 785-296-5524.

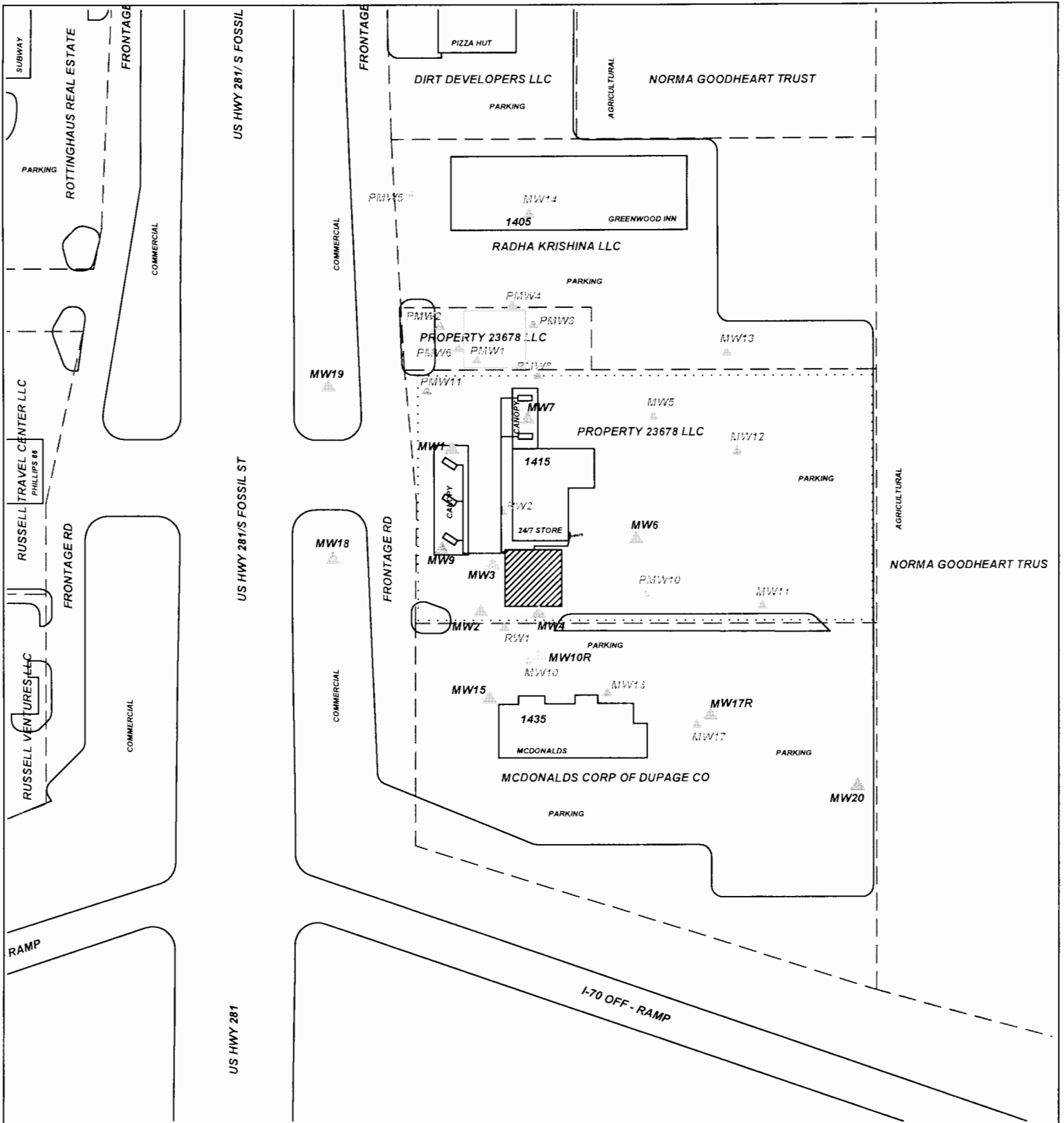

PROJECT: AMOCO #9689
ADDRESS: HWY. 70 & 281
LOCATION: RUSSELL, KS
DRAWN BY: B. STALNAKER **DATE:** 10/25/17
REVISED BY: C. ROE **DATE:** 10/10/18
AEI JOB #: TF507 **KDHE JOB #:** U6-084-00597

TITLE: **FIGURE 2.1**
AREA BASE MAP
350' RADIUS

AEI ASSOCIATED ENVIRONMENTAL INC.

LEGEND:

- = (1) 12,000 G., (1) 10,000 G., (1) 8,000 G. GASOLINE, (1) 12,000 G. DIESEL, PRODUCT LINES & DISPENSERS
- = MONITORING WELL
- = PLUGGED/DESTROYED WELL
- = SUBJECT PROPERTY
- = PARCEL BOUNDARY

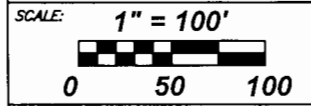

NOTES:
 No basements observed within 500'.