

**WATER WELL PLUGGING RECORD Form WWC-5P KSA 82a-1212 ID NO.**

<b>1 LOCATION OF WATER WELL:</b> County: Russell	Fraction ¼ SW ¼ SW ¼ NW ¼	Section Number 02	Township Number T 14 S	Range Number 14 <input type="checkbox"/> E <input checked="" type="checkbox"/> W
---	------------------------------	----------------------	---------------------------	---

Street/Rural Address of Well Location; if unknown, distance & direction from nearest town or intersection: If at owner's address, check here  1435 S. Fossil St. Russell Kansas

**Global Positioning Systems (GPS) information:**  
 Latitude: \_\_\_\_\_ (in decimal degrees)  
 Longitude: \_\_\_\_\_ (in decimal degrees)  
 Elevation: 1824.60 TOC  
 Horizontal Datum:  WGS84,  NAD83,  NAD27  
 Collection Method: \_\_\_\_\_

**2 WATER WELL OWNER:** Angela Dunn  
 RR#, St. Address, Box #: 150 St. Peters Centre Blvd, Ste C  
 City, State ZIP Code: St. Peters, MO 63376

GPS unit (Make/Model: \_\_\_\_\_)  
 Digital Map/Photo,  Topographic Map,  Land Survey  
 Est. Accuracy:  < 3 m,  3-5 m,  5-15 m,  > 15 m

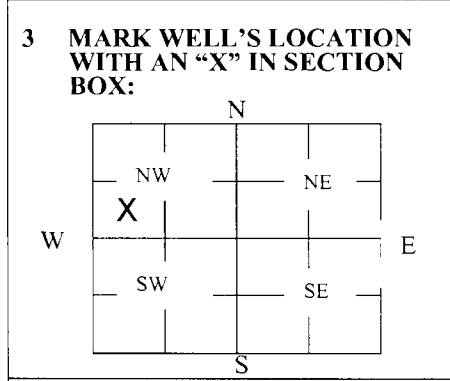

**4 DEPTH OF WELL** 35.21 ft.  
 WELL'S STATIC WATER LEVEL 18.06 ft

WELL WAS USED AS:

<input type="checkbox"/> Domestic	<input type="checkbox"/> Public Water Supply	<input type="checkbox"/> Dewatering
<input type="checkbox"/> Irrigation	<input type="checkbox"/> Oil Field Water Supply	<input checked="" type="checkbox"/> Monitoring
<input type="checkbox"/> Feedlot	<input type="checkbox"/> Domestic (Lawn & Garden)	<input type="checkbox"/> Injection Well
<input type="checkbox"/> Industrial	<input type="checkbox"/> Air Conditioning	<input type="checkbox"/> Other _____

Was a chemical/bacteriological sample submitted to Department? Yes  No

**5 TYPE OF BLANK CASING USED:**

Steel  RMP (SR)  Wrought  Fiberglass  Other (Specify below) \_\_\_\_\_  
 PVC  ABS  Asbestos-Cement  Concrete Tile

Blank casing diameter 2 in. Was casing pulled? Yes  No  If yes, how much 3 ft  
 Casing height above or below land surface 36 in.

**6 GROUT PLUG MATERIAL:**  Neat cement  Cement grout  Bentonite  Other \_\_\_\_\_

Grout Plug Intervals: From 3 ft. to 35.21 ft., From \_\_\_\_\_ ft. to \_\_\_\_\_ ft., From \_\_\_\_\_ ft. to \_\_\_\_\_ ft.

What is the nearest source of possible contamination:

<input type="checkbox"/> Septic tank	<input type="checkbox"/> Seepage pit	<input checked="" type="checkbox"/> Fuel storage	<input type="checkbox"/> Other (specify below) _____
<input type="checkbox"/> Sewer lines	<input type="checkbox"/> Pit privy	<input type="checkbox"/> Fertilizer storage	
<input type="checkbox"/> Watertight sewer lines	<input type="checkbox"/> Sewage lagoon	<input type="checkbox"/> Insecticide storage	
<input type="checkbox"/> Lateral lines	<input type="checkbox"/> Feedyard	<input type="checkbox"/> Abandoned water well	Direction from well? Northwest
<input type="checkbox"/> Cess pool	<input type="checkbox"/> Livestock pens	<input type="checkbox"/> Oil well/Gas well	How many feet? 300

FROM	TO	PLUGGING MATERIALS	FROM	TO	PLUGGING MATERIALS
0	0.5	Asphalt			
0.5	3	Compacted silt/clay			
3	35.21	Hydrated Bentonite chips			U6-084-00597

**7 CONTRACTOR'S OR LANDOWNER'S CERTIFICATION:** This water well was plugged under my jurisdiction and was completed on (mo/day/year) 2-6-19 and this record is true to the best of my knowledge and belief. Kansas Water Well Contractor's License No. 585. This Water Well Record was completed on (mo/day/year) 2-11-19 under the business name of Associated Environmental, Inc. by (signature) *Bradley Johnson*

Send one white copy to Kansas Department of Health & Environment, Geology Section, 1000 SW Jackson Street, Ste. 420, Topeka, KS 66612-1367. Send one copy to WATER WELL OWNER and retain one for your records.  
 Visit us at <http://www.kdheks.gov/waterwell/index.html> Telephone 785-296-5524.

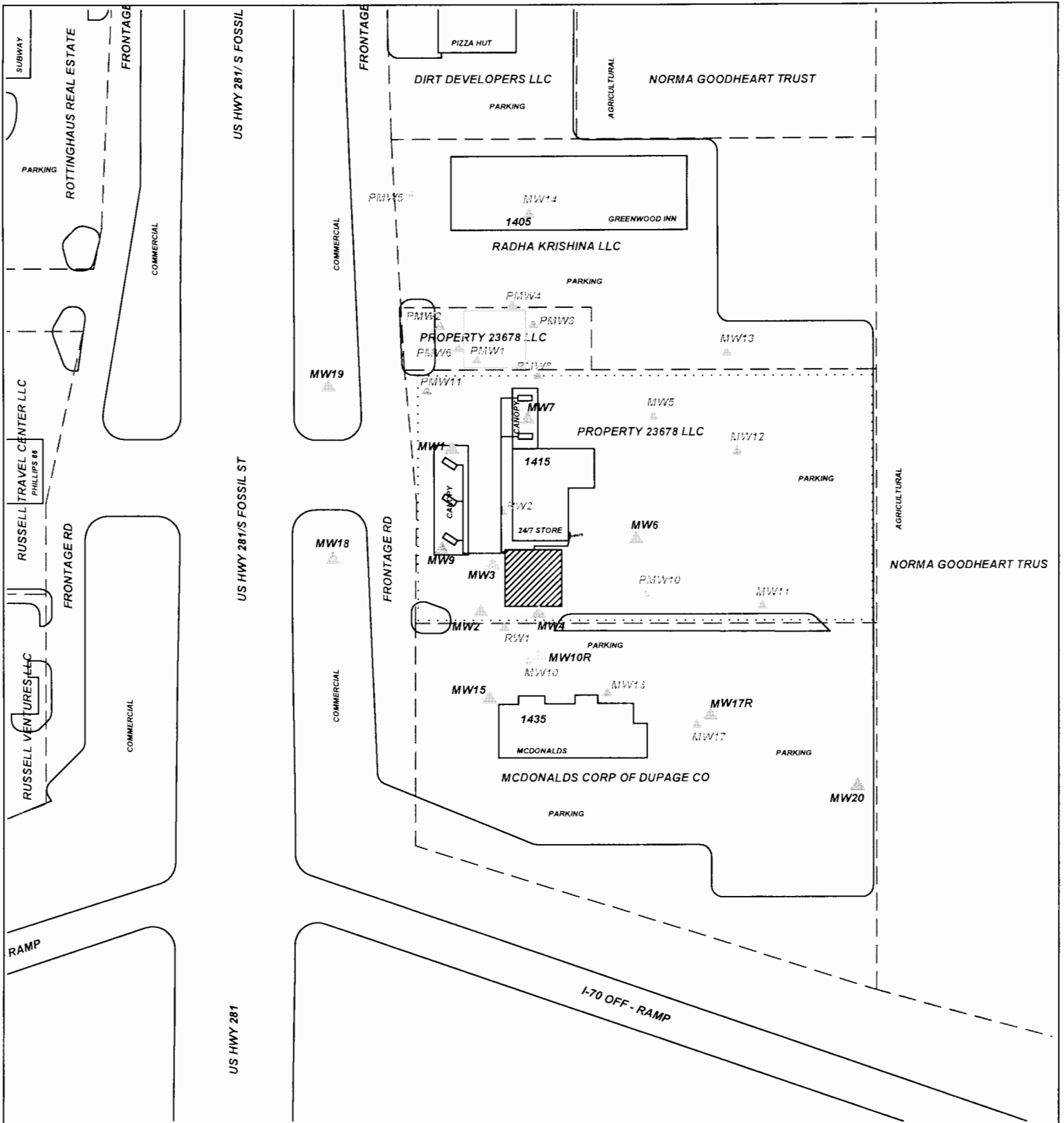

**PROJECT:** AMOCO #9689  
**ADDRESS:** HWY. 70 & 281  
**LOCATION:** RUSSELL, KS  
**DRAWN BY:** B. STALNAKER **DATE:** 10/25/17  
**REVISED BY:** C. ROE **DATE:** 10/10/18  
**AEI JOB #:** TF507 **KDHE JOB #:** U6-084-00597

**TITLE:** **FIGURE 2.1**  
**AREA BASE MAP**  
**350' RADIUS**

**ASSOCIATED ENVIRONMENTAL INC.**

**LEGEND:**

- = (1) 12,000 G., (1) 10,000 G., (1) 8,000 G. GASOLINE, (1) 12,000 G. DIESEL, PRODUCT LINES & DISPENSERS
- = MONITORING WELL
- = PLUGGED/DESTROYED WELL
- = SUBJECT PROPERTY
- = PARCEL BOUNDARY

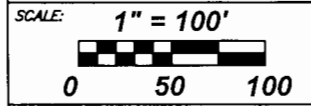

**NOTES:**  
 No basements observed within 500'.