

WATER WELL PLUGGING RECORD Form WWC-5P KSA 82a-1212 ID NO.

1 LOCATION OF WATER WELL: County: Russell	Fraction NE ¼ SW ¼ SW ¼ NW ¼	Section Number 02	Township Number T 14 S	Range Number 14 <input type="checkbox"/> E <input checked="" type="checkbox"/> W
Street/Rural Address of Well Location; if unknown, distance & direction from nearest town or intersection: If at owner's address, check here <input type="checkbox"/> 1435 S. Fossil St. Russell Kansas		Global Positioning Systems (GPS) information: Latitude: 38.86525 (in decimal degrees) Longitude: 98.85286 (in decimal degrees) Elevation: 1824.38 TOC Horizontal Datum: <input type="checkbox"/> WGS84, <input checked="" type="checkbox"/> NAD83, <input type="checkbox"/> NAD27 Collection Method:		

2 WATER WELL OWNER: Angela Dunn RR#, St. Address, Box #: 150 St. Peters Centre Blvd, Ste C City, State ZIP Code: St. Peters, MO 63376	<input type="checkbox"/> GPS unit (Make/Model: _____ <input type="checkbox"/> Digital Map/Photo, <input type="checkbox"/> Topographic Map, <input checked="" type="checkbox"/> Land Survey Est. Accuracy: <input checked="" type="checkbox"/> < 3 m, <input type="checkbox"/> 3-5 m, <input type="checkbox"/> 5-15 m, <input type="checkbox"/> > 15 m
--	---

3 MARK WELL'S LOCATION WITH AN "X" IN SECTION BOX:	4 DEPTH OF WELL 27.87 ft.
	WELL'S STATIC WATER LEVEL 18.36 ft WELL WAS USED AS: <input type="checkbox"/> Domestic Irrigation <input type="checkbox"/> Public Water Supply <input type="checkbox"/> Dewatering <input type="checkbox"/> Feedlot <input type="checkbox"/> Oil Field Water Supply <input checked="" type="checkbox"/> Monitoring <input type="checkbox"/> Industrial <input type="checkbox"/> Air Conditioning <input type="checkbox"/> Injection Well <input type="checkbox"/> Other _____ Was a chemical/bacteriological sample submitted to Department? Yes <input type="checkbox"/> No <input checked="" type="checkbox"/>

5 TYPE OF BLANK CASING USED:

Steel RMP (SR) Wrought Fiberglass Other (Specify below) _____
 PVC ABS Asbestos-Cement Concrete Tile

Blank casing diameter 2 in. Was casing pulled? Yes No If yes, how much 3 ft
 Casing height above or below land surface 36 in.

6 GROUT PLUG MATERIAL: Neat cement Cement grout Bentonite Other _____

Grout Plug Intervals: From 3 ft. to 27.87 ft., From _____ ft. to _____ ft., From _____ ft. to _____ ft.

What is the nearest source of possible contamination:

<input type="checkbox"/> Septic tank	<input type="checkbox"/> Seepage pit	<input checked="" type="checkbox"/> Fuel storage	<input type="checkbox"/> Other (specify below) _____
<input type="checkbox"/> Sewer lines	<input type="checkbox"/> Pit privy	<input type="checkbox"/> Fertilizer storage	
<input type="checkbox"/> Watertight sewer lines	<input type="checkbox"/> Sewage lagoon	<input type="checkbox"/> Insecticide storage	
<input type="checkbox"/> Lateral lines	<input type="checkbox"/> Feedyard	<input type="checkbox"/> Abandoned water well	Direction from well? Northwest
<input type="checkbox"/> Cess pool	<input type="checkbox"/> Livestock pens	<input type="checkbox"/> Oil well/Gas well	How many feet? 350

FROM	TO	PLUGGING MATERIALS	FROM	TO	PLUGGING MATERIALS
0	0.5	Asphalt			
0.5	3	Compacted silt/clay			
3	27.87	Hydrated Bentonite chips			U6-084-00597

7 CONTRACTOR'S OR LANDOWNER'S CERTIFICATION: This water well was plugged under my jurisdiction and was completed on (mo/day/year) 2-6-19 and this record is true to the best of my knowledge and belief. Kansas Water Well Contractor's License No. 585. This Water Well Record was completed on (mo/day/year) 2-11-19 under the business name of Associated Environmental, Inc. by (signature) *Andrew Johnson*

Send one white copy to Kansas Department of Health & Environment, Geology Section, 1000 SW Jackson Street, Ste. 420, Topeka, KS 66612-1367. Send one copy to WATER WELL OWNER and retain one for your records.
 Visit us at <http://www.kdheks.gov/waterwell/index.html> Telephone 785-296-5524.

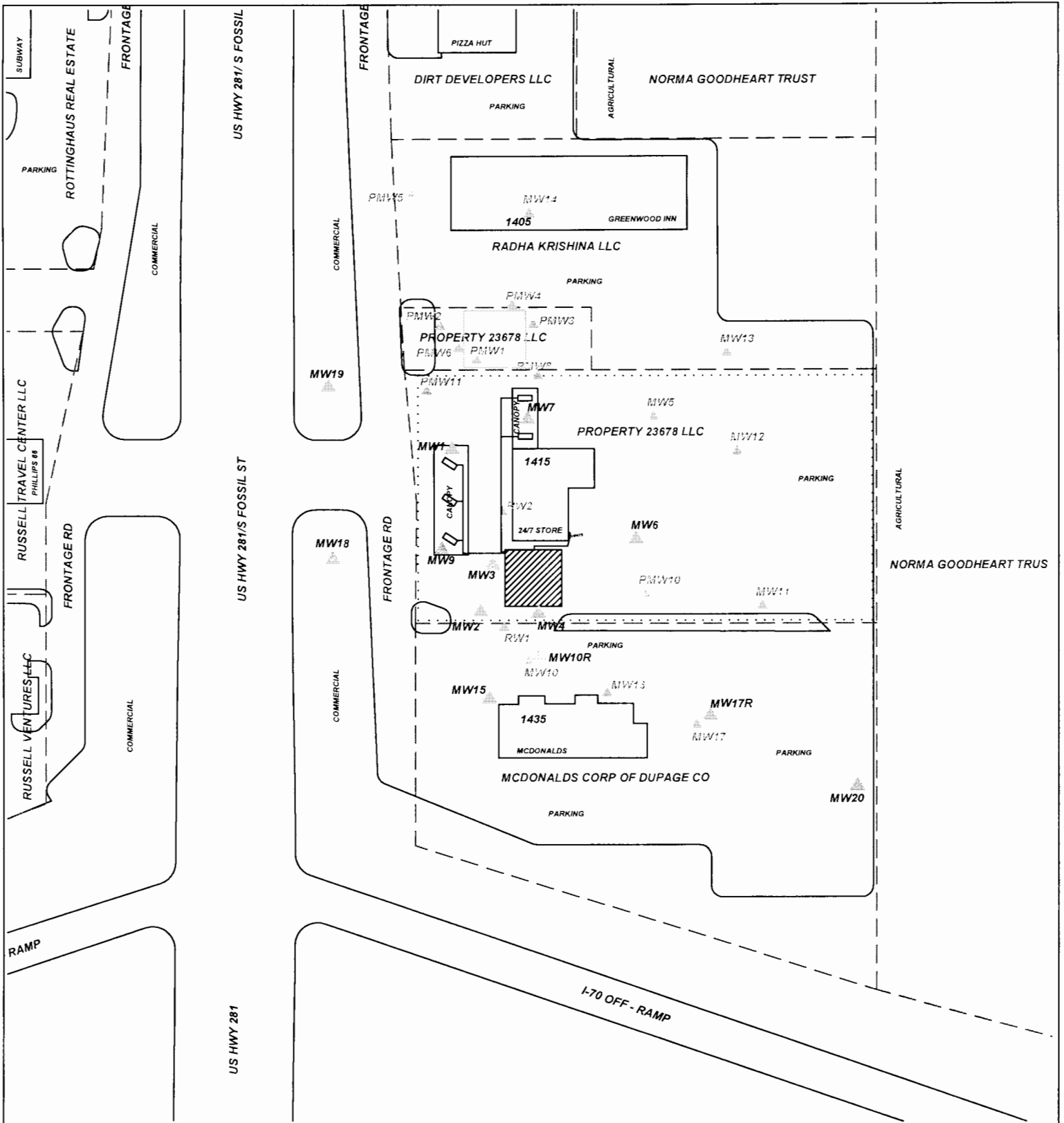

PROJECT: AMOCO #9689
ADDRESS: HWY. 70 & 281
LOCATION: RUSSELL, KS

DRAWN BY: B. STALNAKER **DATE:** 10/25/17
REVISED BY: C. ROE **DATE:** 10/10/18

AEI JOB #: TF507 **KDHE JOB #:** U6-084-00597

TITLE: **FIGURE 2.1**
AREA BASE MAP
350' RADIUS

ASSOCIATED ENVIRONMENTAL INC.

LEGEND:

- = (1) 12,000 G., (1) 10,000 G., (1) 8,000 G. GASOLINE, (1) 12,000 G. DIESEL, PRODUCT LINES & DISPENSERS
- = MONITORING WELL
- = PLUGGED/DESTROYED WELL
- = SUBJECT PROPERTY
- = PARCEL BOUNDARY

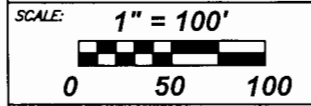

NOTES:
 No basements observed within 500'.