

**WATER WELL PLUGGING RECORD Form WWC-5P**

KSA 82a-1212 ID NO.

MW-19

**1 LOCATION OF WATER WELL:** County: Russell Fraction: SW 1/4 NW 1/4 SW 1/4 NW 1/4 Section Number: 02 Township Number: T 14 S Range Number: 14  E  W

Street/Rural Address of Well Location; if unknown, distance & direction from nearest town or intersection: If at owner's address, check here  1415 S. Fossil St. Russell Kansas

**Global Positioning Systems (GPS) information:**  
 Latitude: 38.86609 (in decimal degrees)  
 Longitude: 98.85423 (in decimal degrees)  
 Elevation: 1821.94 TOC  
 Horizontal Datum:  WGS84,  NAD83,  NAD27  
 Collection Method:

**2 WATER WELL OWNER:** Angela Dunn  
 RR#, St. Address, Box #: 150 St. Peters Centre Blvd, Ste C  
 City, State ZIP Code: St. Peters, MO 63376

GPS unit (Make/Model: \_\_\_\_\_)  
 Digital Map/Photo,  Topographic Map,  Land Survey  
 Est. Accuracy:  < 3 m,  3-5 m,  5-15 m,  > 15 m

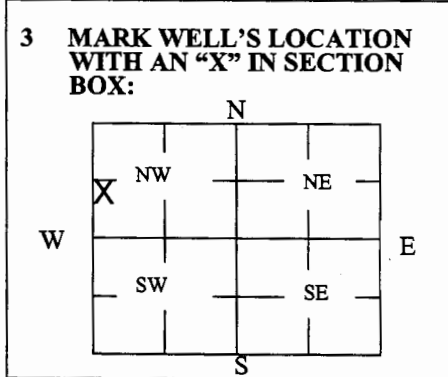

**4 DEPTH OF WELL** 28.94 ft.  
 WELL'S STATIC WATER LEVEL 14.05 ft.  
 WELL WAS USED AS:  
 Domestic  Public Water Supply  Dewatering  
 Irrigation  Oil Field Water Supply  Monitoring  
 Feedlot  Domestic (Lawn & Garden)  Injection Well  
 Industrial  Air Conditioning  Other \_\_\_\_\_  
 Was a chemical/bacteriological sample submitted to Department? Yes  No

**5 TYPE OF BLANK CASING USED:**

Steel  RMP (SR)  Wrought  Fiberglass  Other (Specify below)  
 PVC  ABS  Asbestos-Cement  Concrete Tile

Blank casing diameter 2 in. Was casing pulled? Yes  No  If yes, how much 3 ft  
 Casing height above or below land surface 36 in.

**6 GROUT PLUG MATERIAL:**  Neat cement  Cement grout  Bentonite  Other \_\_\_\_\_

Grout Plug Intervals: From 3 ft. to 28.94 ft., From \_\_\_\_\_ ft. to \_\_\_\_\_ ft., From \_\_\_\_\_ ft. to \_\_\_\_\_ ft.

What is the nearest source of possible contamination:

Septic tank  Seepage pit  Fuel storage  Other (specify below)  
 Sewer lines  Pit privy  Fertilizer storage  
 Watertight sewer lines  Sewage lagoon  Insecticide storage  
 Lateral lines  Feedyard  Abandoned water well Direction from well? Southeast  
 Cess pool  Livestock pens  Oil well/Gas well How many feet? 300

FROM	TO	PLUGGING MATERIALS	FROM	TO	PLUGGING MATERIALS
0	3	Compacted silt/clay			
3	28.94	Hydrated Bentonite chips			
					U6-084-00597

**7 CONTRACTOR'S OR LANDOWNER'S CERTIFICATION:** This water well was plugged under my jurisdiction and was completed on (mo/day/year) 2-6-19 and this record is true to the best of my knowledge and belief. Kansas Water Well Contractor's License No. 585. This Water Well Record was completed on (mo/day/year) 2-11-19 under the business name of Associated Environmental, Inc. by (signature) [Signature]

Send one white copy to Kansas Department of Health & Environment, Geology Section, 1000 SW Jackson Street, Ste. 420, Topeka, KS 66612-1367. Send one copy to WATER WELL OWNER and retain one for your records.  
 Visit us at <http://www.kdheks.gov/waterwell/index.html> Telephone 785-296-5524.

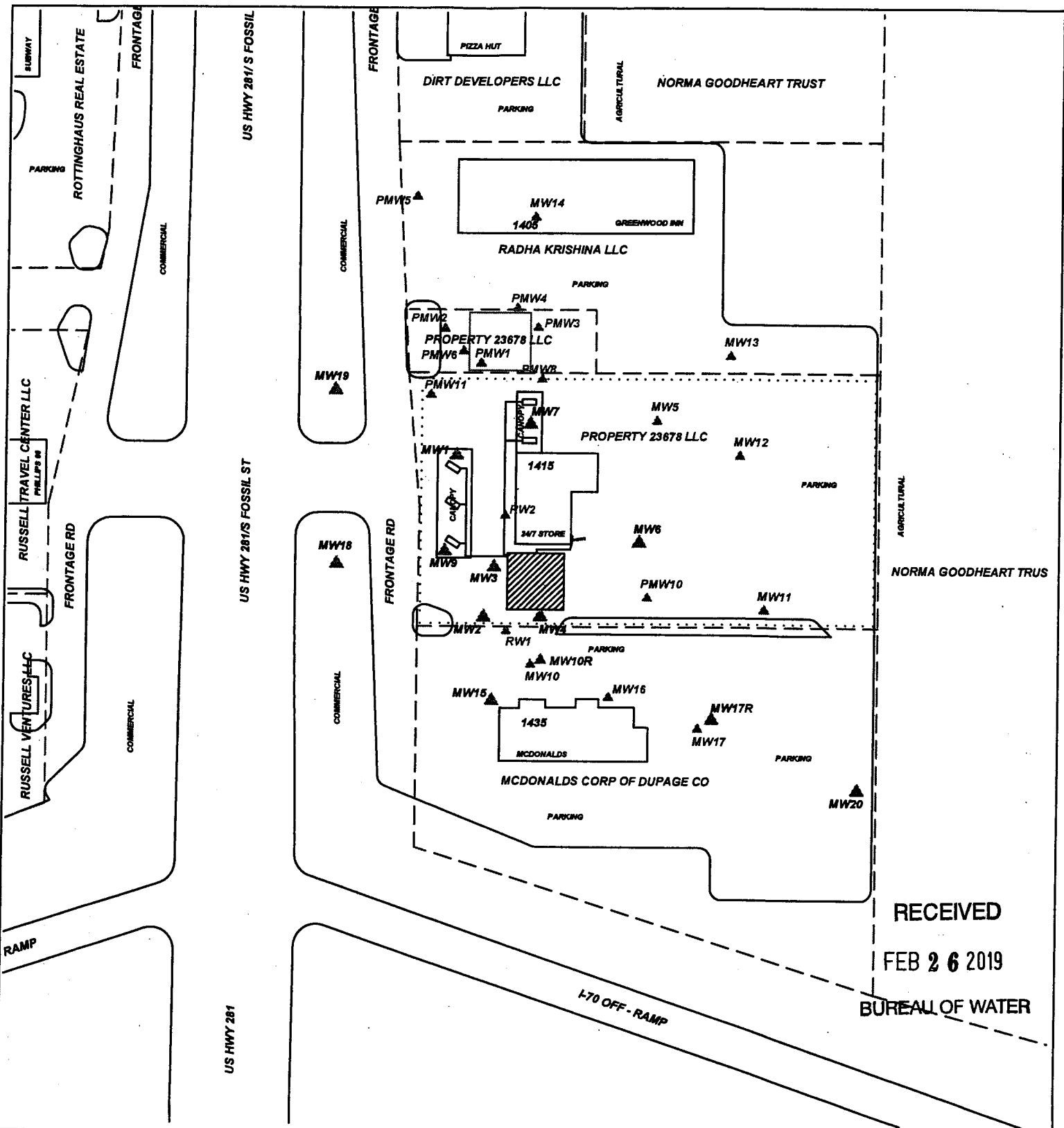

PROJECT: **AMOCO #9689**

ADDRESS: **HWY. 70 & 281**

LOCATION: **RUSSELL, KS**

DRAWN BY: **B. STALNAKER** DATE: **10/25/17**

REVISED BY: **C. ROE** DATE: **10/10/18**

AEI JOB #: **TF507** KDHE JOB #: **U6-084-00597**

SCALE: **1" = 100'**

TITLE: **FIGURE 2.1  
AREA BASE MAP  
350' RADIUS**

**AEI** ASSOCIATED ENVIRONMENTAL INC.

LEGEND:

- = (1) 12,000 G., (1) 10,000 G., (1) 8,000 G. GASOLINE, (1) 12,000 G. DIESEL, PRODUCT LINES & DISPENSERS
- = MONITORING WELL
- = PLUGGED/DESTROYED WELL
- = SUBJECT PROPERTY
- = PARCEL BOUNDARY

NOTES: No basements observed within 500'.