

CORRECTED

WATER WELL PLUGGING RECORD Form WWC-5P KSA 82a-1212 ID NO.

[Empty box for ID number]

1 LOCATION OF WATER WELL: County: Ellis Fraction 1/4 NW 1/4 SW 1/4 NW 1/4 Section Number 3 Township Number T 14 S Range Number 18 [] E [X] W

Street/Rural Address of Well Location; if unknown, distance & direction from nearest town or intersection: If at owner's address, check here [] E of US Hwy 183 & N of Vine St., Hays

Global Positioning Systems (GPS) information: Latitude: (in decimal degrees) Longitude: (in decimal degrees) Elevation: Datum: [] WGS84, [] NAD83, [] NAD27 Collection Method: [] GPS unit (Make/Model): [] Digital Map/Photo, [] Topographic Map, [] Land Survey Est. Accuracy: [] < 3 m, [] 3-5 m, [] 5-15 m, [] > 15 m

2 WATER WELL OWNER: Dowell RR#, St. Address, Box #: 300 Schlumberger Drive City, State ZIP Code: Sugar Land, TX 77478

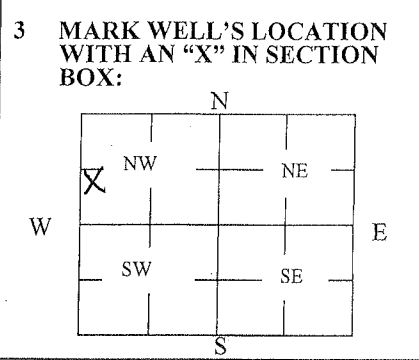

3 MARK WELL'S LOCATION WITH AN "X" IN SECTION BOX: 4 DEPTH OF WELL 45.54 ft. WELL'S STATIC WATER LEVEL ~25.5 ft. WELL WAS USED AS: [] Domestic, [] Irrigation, [] Feedlot, [] Industrial, [] Public Water Supply, [] Oil Field Water Supply, [] Domestic (Lawn & Garden), [] Air Conditioning, [] Dewatering, [X] Monitoring, [] Injection Well, [] Other. Was a chemical/bacteriological sample submitted to Department? Yes [] No [X]

5 TYPE OF BLANK CASING USED: [X] Steel, [] RMP (SR), [] Wrought, [] Fiberglass, [] Other (Specify below), [] PVC, [] ABS, [] Asbestos-Cement, [] Concrete Tile. Blank casing diameter 2 in. Was casing pulled? Yes [X] No [] If yes, how much to 3' bgs. Casing height above or below land surface ~30 in.

6 GROUT PLUG MATERIAL: [] Neat cement, [] Cement grout, [X] Bentonite, [] Other. Grout Plug Intervals: From 3 ft. to 43.04 ft., From ft. to ft., From to ft. What is the nearest source of possible contamination: [] Septic tank, [] Sewer lines, [] Watertight sewer lines, [] Lateral lines, [] Cess pool, [] Seepage pit, [] Pit privy, [] Sewage lagoon, [] Feedyard, [] Livestock pens, [] Fuel Storage, [] Fertilizer storage, [] Insecticide storage, [] Abandoned water well, [] Oil well/Gas well, [] Other (specify below). Direction from well? How many feet?

Table with columns: FROM, TO, PLUGGING MATERIALS. Row 1: 0, 3, Native soil. Row 2: 3, 43.04, Bentonite. Row 3: P4. Large 'CORRECTED' stamp is present.

7 CONTRACTOR'S OR LANDOWNER'S CERTIFICATION: This water well was plugged under my jurisdiction and was completed on (mo/day/year) 10/5/2011 and this record is true to the best of my knowledge and belief. Kansas Water Well Contractor's License No. 527. This Water Well Record was completed on (mo/day/year) 10/28/2011 under the business name of GeoCore Inc. by (signature) [Signature]

INSTRUCTIONS: Use typewriter or ballpoint pen. Please press firmly and print clearly. Please fill in blanks, underline or circle the correct answers. Send top three copies to Kansas Department of Health and Environment, Bureau of Water, Geology Section, 1000 SW Jackson St., Ste. 420, Topeka, Kansas 66612-1367. Telephone: 785/296-5524. Send one to Water Well Owner and retain one for your records. Visit us at http://www.kdheks.gov/waterwell/index.html.

Check one: [] White Copy [] Blue Copy [] Pink Copy