

WATER WELL RECORD

Form WWC-5

Division of Water Resources App. No.

1 LOCATION OF WATER WELL: County: Ellis	Fraction ¼ se ¼ se ¼ se ¼	Section Number 3	Township No. T 14 S	Range Number R 18 <input type="checkbox"/> E <input checked="" type="checkbox"/> W
---	------------------------------	---------------------	------------------------	---

Street/Rural Address of Well Location; if unknown, distance & direction from nearest town or intersection: If at owner's address, check here .

Global Positioning System (GPS) information:
 Latitude: (in decimal degrees)
 Longitude: (in decimal degrees)
 Elevation:
 Datum: WGS 84, NAD 83, NAD 27
 Collection Method:
 GPS unit (Make/Model:)
 Digital Map/Photo, Topographic Map, Land Survey
 Est. Accuracy: <3 m, 3-5 m, 5-15 m, >15 m

2 WATER WELL OWNER: Defiance Brewery
 RR#, Street Address, Box #: 2050 Hwy 40
 City, State, ZIP Code : Hays, KS 67601

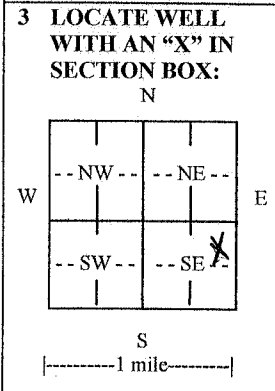

4 DEPTH OF COMPLETED WELL 70 ft.
 Depth(s) Groundwater Encountered (1) 40 ft. (2) ft. (3) ft.
 WELL'S STATIC WATER LEVEL 45 ft. below land surface measured on mo/day/yr. 09/25/13
 Pump test data: Well water was 47 ft. after 2 hours pumping 50 gpm
 EST. YIELD 50 gpm. Well water was ft. after hours pumping gpm
 Bore Hole Diameter 10 in. to 70 ft., and in. to ft.
 WELL WATER TO BE USED AS: Public water supply Geothermal Injection well
 Domestic Feedlot Oil field water supply Dewatering Other (Specify below)
 Irrigation Industrial Domestic-lawn & garden Monitoring well
 Was a chemical/bacteriological sample submitted to Department? Yes No
 If yes, mo/day/yr sample was submitted
 Water well disinfected? Yes No

5 TYPE OF CASING USED: Steel PVC Other
 CASING JOINTS: Glued Clamped Welded Threaded
 Casing diameter 5 in. to 70 ft., Diameter in. to ft., Diameter in. to ft.
 Casing height above land surface 24 in., Weight 2.91 lbs./ft., Wall thickness or gauge No. 21
 TYPE OF SCREEN OR PERFORATION MATERIAL:
 Steel Stainless Steel PVC Other (Specify)
 Brass Galvanized Steel None used (open hole)
 SCREEN OR PERFORATION OPENINGS ARE:
 Continuous slot Mill slot Gauze wrapped Torch cut Drilled holes None (open hole)
 Louvered shutter Key punched Wire wrapped Saw cut Other (specify)
 SCREEN-PERFORATED INTERVALS: From 70 ft. to 50 ft., From ft. to ft.
 GRAVEL PACK INTERVALS: From 70 ft. to 46 ft., From ft. to ft.
 From ft. to ft., From ft. to ft.

6 GROUT MATERIAL: Neat cement Cement grout Bentonite Other
 Grout Intervals: From 46 ft. to 34 ft., From ft. to ft., From ft. to ft.
 What is the nearest source of possible contamination:
 Septic tank Lateral lines Pit privy Livestock pens Insecticide storage Other (specify below)
 Sewer lines Cesspool Sewage lagoon Fuel storage Abandoned water well
 Watertight sewer lines Seepage pit Feedyard Fertilizer storage Oil well/gas well
 Direction from well Distance from well

FROM	TO	LITHOLOGIC LOG	FROM	TO	LITHO. LOG (cont.) or PLUGGING INTERVALS
0	2	Top Soil			
2	20	Gumbo clay			
20	25	Loose rock, gumbo clay			
25	38	Gumbo clay			
38	46	Fine Sand river mud			
46	61	Sand			
61	70	shale			

7 CONTRACTOR'S OR LANDOWNER'S CERTIFICATION: This water well was constructed, reconstructed, or plugged under my jurisdiction and was completed on (mo/day/year) 10/01/13 and this record is true to the best of my knowledge and belief. Kansas Water Well Contractor's License No. 0199 This Water Well Record was completed on (mo/day/year) 10/11/13 under the business name of Karst Water Well Drilling & Service, Inc. by (signature)

INSTRUCTIONS: Use typewriter or ball point pen. PLEASE PRESS FIRMLY and PRINT clearly. Please fill in blanks and check the correct answers. Send one copy to Kansas Department of Health and Environment, Bureau of Water, Geology Section, 1000 SW Jackson St., Suite 420, Topeka, Kansas 66612-1367. Telephone 785-296-5524. Send one copy to WATER WELL OWNER and retain one for your records. Include fee of \$5.00 for each constructed well. Visit us at <http://www.kdheks.gov/waterwell/index.html>