

County: Ellis Fraction NE SW SW NW Sec. 3 T 14 S R 18 E/W

CORRECTION(S) TO WATER WELL COMPLETION RECORD (WWC-5)

(to rectify lacking or incorrect information)

Owner: Dow Environmental

Location was listed as:

Section-Township-Range: 3-145

Fraction (1/4 1/4 1/4): SW SW NW

Location changed to:

3-145-18W

NE SW SW NW

Other changes: Initial statements: _____

Changed to: _____

Comments: _____

Verification method: Latitude & Longitude, KGS' "LEO" conversion tool, wellsite address & city street map, and mapping tool & aerial photos on KGS website initials: DRJ date: 12/24/2013

Submitted by: Kansas Geological Survey, Data Resources Library, 1930 Constant Ave., Lawrence, KS 66047-3726/
to: Kansas Dept of Health & Environment, Bureau of Water, 1000 SW Jackson, Suite 420, Topeka, KS 66612-1367.

1 LOCATION OF WATER WELL: County: <u>Ellis</u>	Fraction <u>SW 1/4 SW 1/4 NW 1/4</u> 1/4	Section Number <u>3</u>	Township Number <u>T 19 S</u>	Range Number <input type="checkbox"/> E <input checked="" type="checkbox"/> W
--	---	----------------------------	----------------------------------	--

Street/Rural Address of Well Location; if unknown, distance & direction from nearest town or intersection: If at owner's address, check here

1004 Vine St. Hays, KS

Global Positioning Systems (GPS) information:
 Latitude: 38.064889 (in decimal degrees)
 Longitude: 99.315972 (in decimal degrees)
 Elevation: _____
 Datum: WGS84, NAD83, NAD27
 Collection Method:
 GPS unit (Make/Model: _____)
 Digital Map/Photo, Topographic Map, Land Survey
 Est. Accuracy: < 3 m, 3-5 m, 5-15 m, > 15 m

2 WATER WELL OWNER: Dow Environmental
 RR#, St. Address, Box #: 2301 No. Brazosport Blvd.
 City, State ZIP Code: Freeport, Texas 77541

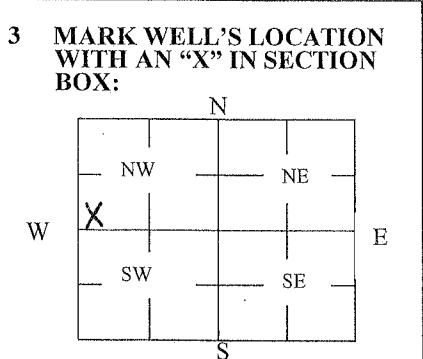

4 DEPTH OF WELL 42 ft.
 WELL'S STATIC WATER LEVEL _____ ft.
 WELL WAS USED AS:
 Domestic Public Water Supply Dewatering
 Irrigation Oil Field Water Supply Monitoring
 Feedlot Domestic (Lawn & Garden) Injection Well
 Industrial Air Conditioning Other _____
 Was a chemical/bacteriological sample submitted to Department? Yes No

5 TYPE OF BLANK CASING USED:

<input type="checkbox"/> Steel	<input type="checkbox"/> RMP (SR)	<input type="checkbox"/> Wrought	<input type="checkbox"/> Fiberglass	<input type="checkbox"/> Other (Specify below) _____
<input checked="" type="checkbox"/> PVC	<input type="checkbox"/> ABS	<input type="checkbox"/> Asbestos-Cement	<input type="checkbox"/> Concrete Tile	

Blank casing diameter 2 in. Was casing pulled? Yes No If yes, how much _____
 Casing height above or below land surface 3' in.

6 GROUT PLUG MATERIAL: Neat cement Cement grout Bentonite Other _____

Grout Plug Intervals: From 3 ft. to 42 ft., From _____ ft. to _____ ft., From _____ ft. to _____ ft.

What is the nearest source of possible contamination:

<input type="checkbox"/> Septic tank	<input type="checkbox"/> Seepage pit	<input checked="" type="checkbox"/> Fuel storage	<input type="checkbox"/> Other (specify below) _____
<input type="checkbox"/> Sewer lines	<input type="checkbox"/> Pit privy	<input type="checkbox"/> Fertilizer storage	
<input type="checkbox"/> Watertight sewer lines	<input type="checkbox"/> Sewage lagoon	<input type="checkbox"/> Insecticide storage	
<input type="checkbox"/> Lateral lines	<input type="checkbox"/> Feedyard	<input type="checkbox"/> Abandoned water well	Direction from well? _____
<input type="checkbox"/> Cess pool	<input type="checkbox"/> Livestock pens	<input type="checkbox"/> Oil well/Gas well	How many feet? _____

FROM	TO	PLUGGING MATERIALS	FROM	TO	PLUGGING MATERIALS
<u>0</u>	<u>3'</u>	<u>Native Soils</u>			
<u>3'</u>	<u>42'</u>	<u>Cement Grout</u>			
					<u>MW-16</u>

7 CONTRACTOR'S OR LANDOWNER'S CERTIFICATION: This water well was plugged under my jurisdiction and was completed on (mo/day/year) 8/1/13 and this record is true to the best of my knowledge and belief. Kansas Water Well Contractor's License No. 051. This Water Well Record was completed on (mo/day/year) 11/22/13 under the business name of Canestoga-Rovers & Associates by (signature) [Signature]

INSTRUCTIONS: Use typewriter or ballpoint pen. Please press firmly and print clearly. Please fill in blanks, underline or circle the correct answers. Send top three copies to Kansas Department of Health and Environment, Bureau of Water, Geology Section, 1000 SW Jackson St., Ste. 420, Topeka, Kansas 66612-1367. Telephone: 785/296-5524. Send one to Water Well Owner and retain one for your records. Visit us at <http://www.kdheks.gov/waterwell/index.html>.