

WATER WELL PLUGGING RECORD Form WWC-5P KSA 82a-1212 ID NO.

MW2

1 LOCATION OF WATER WELL: County: ELLIS	Fraction NW ¼ SE ¼ SW ¼ NW ¼	Section Number 3	Township Number T 14 S	Range Number 18 <input type="checkbox"/> E <input checked="" type="checkbox"/> W
---	---------------------------------	---------------------	---------------------------	---

Street/Rural Address of Well Location; if unknown, distance & direction from nearest town or intersection: If at owner's address, check here <input checked="" type="checkbox"/>	Global Positioning Systems (GPS) information: Latitude: 38.86527 (in decimal degrees) Longitude: -99.31584 (in decimal degrees) Elevation: 1985.30 Horizontal Datum: <input checked="" type="checkbox"/> WGS84, <input type="checkbox"/> NAD83, <input type="checkbox"/> NAD27 Collection Method: <input type="checkbox"/> GPS unit (Make/Model: _____) <input checked="" type="checkbox"/> Digital Map/Photo, <input type="checkbox"/> Topographic Map, <input type="checkbox"/> Land Survey Est. Accuracy: <input checked="" type="checkbox"/> < 3 m, <input type="checkbox"/> 3-5 m, <input type="checkbox"/> 5-15 m, <input type="checkbox"/> > 15 m
--	---

2 WATER WELL OWNER: JANZEN OIL RR#, St. Address, Box #: E 10TH & VINE City, State ZIP Code: HAYS, KS 67601	
---	--

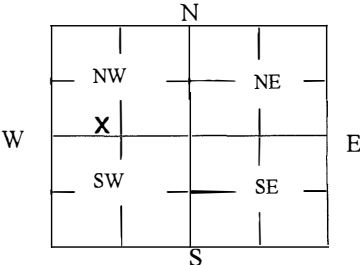
3 MARK WELL'S LOCATION WITH AN "X" IN SECTION BOX: 	4 DEPTH OF WELL 26.97 ft. WELL'S STATIC WATER LEVEL 17.03 ft WELL WAS USED AS: <input type="checkbox"/> Domestic <input type="checkbox"/> Public Water Supply <input type="checkbox"/> Dewatering <input type="checkbox"/> Irrigation <input type="checkbox"/> Oil Field Water Supply <input checked="" type="checkbox"/> Monitoring <input type="checkbox"/> Feedlot <input type="checkbox"/> Domestic (Lawn & Garden) <input type="checkbox"/> Injection Well <input type="checkbox"/> Industrial <input type="checkbox"/> Air Conditioning <input type="checkbox"/> Other _____ Was a chemical/bacteriological sample submitted to Department? Yes <input type="checkbox"/> No <input checked="" type="checkbox"/>
--	---

5 TYPE OF BLANK CASING USED:	
<input type="checkbox"/> Steel <input type="checkbox"/> RMP (SR) <input type="checkbox"/> Wrought <input type="checkbox"/> Fiberglass <input type="checkbox"/> Other (Specify below) _____ <input checked="" type="checkbox"/> PVC <input type="checkbox"/> ABS <input type="checkbox"/> Asbestos-Cement <input type="checkbox"/> Concrete Tile	
Blank casing diameter 2 in. Was casing pulled? Yes <input checked="" type="checkbox"/> No <input type="checkbox"/> If yes, how much 3' Casing height above or below land surface 36 in.	

6 GROUT PLUG MATERIAL: <input type="checkbox"/> Neat cement <input type="checkbox"/> Cement grout <input checked="" type="checkbox"/> Bentonite <input checked="" type="checkbox"/> Other GRASS 0-0.5	
Grout Plug Intervals: From 0.5 ft. to 26.97 ft., From _____ ft. to _____ ft., From _____ ft. to _____ ft.	
What is the nearest source of possible contamination: <input type="checkbox"/> Septic tank <input type="checkbox"/> Seepage pit <input checked="" type="checkbox"/> Fuel storage <input type="checkbox"/> Other (specify below) _____ <input type="checkbox"/> Sewer lines <input type="checkbox"/> Pit privy <input checked="" type="checkbox"/> Fertilizer storage _____ <input type="checkbox"/> Watertight sewer lines <input type="checkbox"/> Sewage lagoon <input type="checkbox"/> Insecticide storage _____ <input type="checkbox"/> Lateral lines <input type="checkbox"/> Feedyard <input type="checkbox"/> Abandoned water well Direction from well? _____ <input type="checkbox"/> Cess pool <input type="checkbox"/> Livestock pens <input type="checkbox"/> Oil well/Gas well How many feet? _____	

FROM	TO	PLUGGING MATERIALS	FROM	TO	PLUGGING MATERIALS
0	0.5	GRASS			
0.5	26.97	BENTONITE			

7 CONTRACTOR'S OR LANDOWNER'S CERTIFICATION: This water well was plugged under my jurisdiction and was completed on (mo/day/year) 6/12/23 and this record is true to the best of my knowledge and belief. Kansas Water Well Contractor's License No. 585. This Water Well Record was completed on (mo/day/year) 7/6/23 under the business name of ASSOCIATED ENVIRONMENTAL INC. by (signature) _____

Send one white copy to Kansas Department of Health & Environment, Geology Section, 1000 SW Jackson Street, Ste. 420, Topeka, KS 66612-1367. Send one copy to WATER WELL OWNER and retain one for your records.
 Visit us at <http://www.kdheks.gov/waterwell/index.html> Telephone 785-296-5524.

KSA82a-1212 Revised 1/20/2015

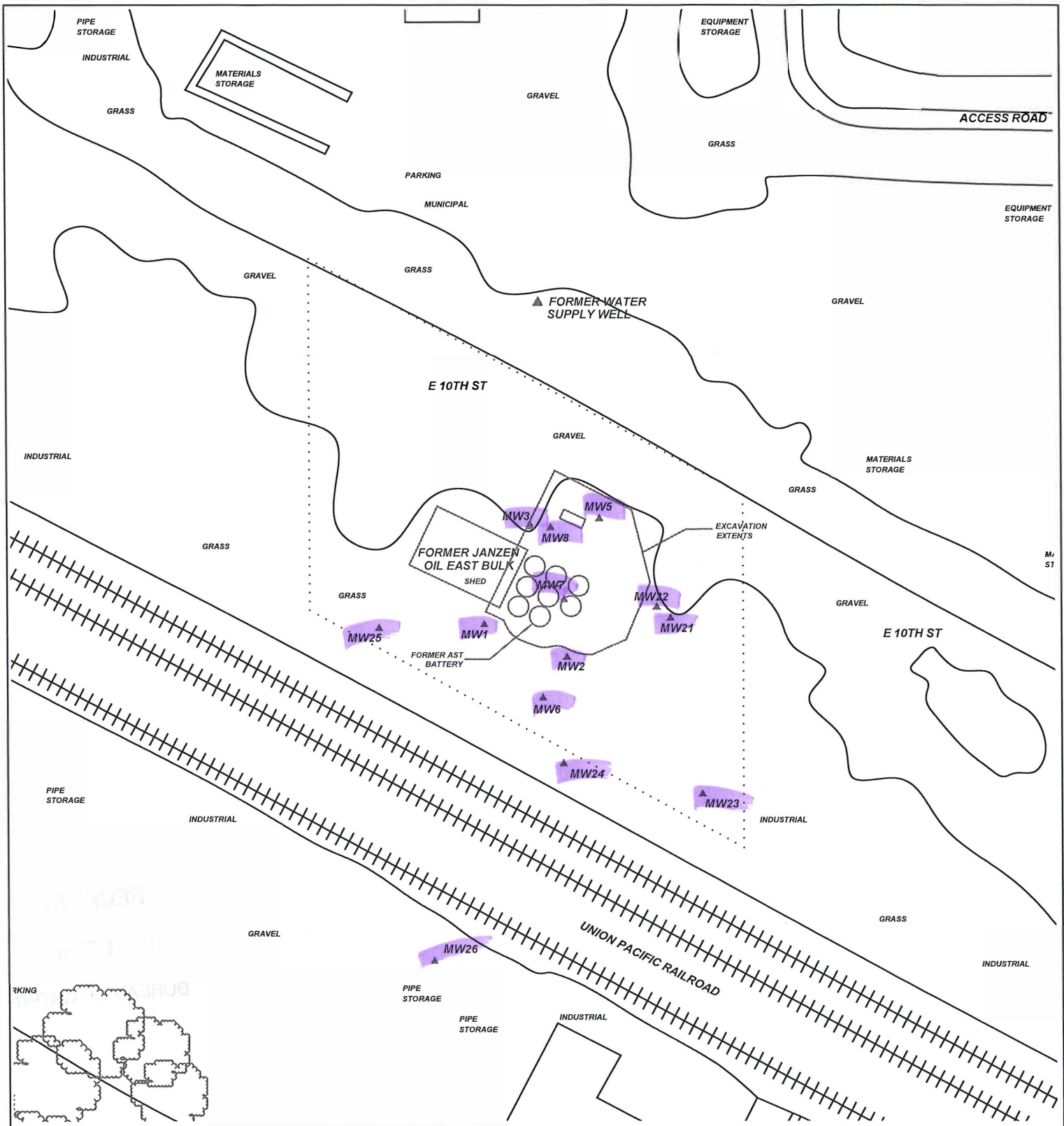

PROJECT: **JANZEN OIL - EAST BULK**

ADDRESS: **E 10TH & VINE**

LOCATION: **HAYS, KS**

DRAWN BY: **C. ROE** DATE: **9/8/21**

REVISED BY: **B. STALNAKER** DATE: **7/6/23**

AEI JOB #: **TF542** KDHE JOB #: **A6-026-40103**

TITLE:

ASSOCIATED ENVIRONMENTAL INC.

- LEGEND:
- = FORMER JANZEN OIL - EAST BULK AST BATTERY & TRUCK LOAD OUT
 - = EXCAVATION EXTENTS
 - = MONITORING WELL
 - = PLUGGED/DESTROYED WELL
 - = SUBJECT PROPERTY

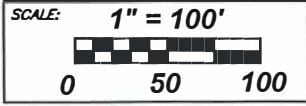

NOTES: T.14 R.18W Sec.3
Ellis County

RECEIVED
JUL 17 2023
BUREAU OF WATER