

WATER WELL PLUGGING RECORD Form WWC-5P KSA 82a-1212 ID NO.

MW6

1 LOCATION OF WATER WELL: County: ELLIS	Fraction NW ¼ SE ¼ SW ¼ NW ¼	Section Number 3	Township Number T 14 S	Range Number 18 <input type="checkbox"/> E <input checked="" type="checkbox"/> W
---	---------------------------------	---------------------	---------------------------	---

Street/Rural Address of Well Location; if unknown, distance & direction from nearest town or intersection: If at owner's address, check here

Global Positioning Systems (GPS) information:
 Latitude: 38.86521 (in decimal degrees)
 Longitude: -99.31588 (in decimal degrees)
 Elevation: 1984.86
 Horizontal Datum: WGS84, NAD83, NAD27
 Collection Method:
 GPS unit (Make/Model: _____)
 Digital Map/Photo, Topographic Map, Land Survey
 Est. Accuracy: < 3 m, 3-5 m, 5-15 m, > 15 m

2 WATER WELL OWNER: JANZEN OIL
 RR#, St. Address, Box #: E 10TH & VINE
 City, State ZIP Code: HAYS, KS 67601

<p>3 MARK WELL'S LOCATION WITH AN "X" IN SECTION BOX:</p> <div style="text-align: center;"> <p>N</p> <table border="1" style="margin: auto; border-collapse: collapse;"> <tr> <td style="width: 20px;">NW</td> <td style="width: 20px;">NE</td> </tr> <tr> <td style="text-align: center;">X</td> <td></td> </tr> <tr> <td style="width: 20px;">SW</td> <td style="width: 20px;">SE</td> </tr> </table> <p>W E</p> <p>S</p> </div>	NW	NE	X		SW	SE	<p>4 DEPTH OF WELL <u>27.00</u> ft. WELL'S STATIC WATER LEVEL <u>16.65</u> ft</p> <p>WELL WAS USED AS:</p> <table style="width:100%;"> <tr> <td><input type="checkbox"/> Domestic</td> <td><input type="checkbox"/> Public Water Supply</td> <td><input type="checkbox"/> Dewatering</td> </tr> <tr> <td><input type="checkbox"/> Irrigation</td> <td><input type="checkbox"/> Oil Field Water Supply</td> <td><input checked="" type="checkbox"/> Monitoring</td> </tr> <tr> <td><input type="checkbox"/> Feedlot</td> <td><input type="checkbox"/> Domestic (Lawn & Garden)</td> <td><input type="checkbox"/> Injection Well</td> </tr> <tr> <td><input type="checkbox"/> Industrial</td> <td><input type="checkbox"/> Air Conditioning</td> <td><input type="checkbox"/> Other _____</td> </tr> </table> <p>Was a chemical/bacteriological sample submitted to Department? Yes <input type="checkbox"/> No <input checked="" type="checkbox"/></p>	<input type="checkbox"/> Domestic	<input type="checkbox"/> Public Water Supply	<input type="checkbox"/> Dewatering	<input type="checkbox"/> Irrigation	<input type="checkbox"/> Oil Field Water Supply	<input checked="" type="checkbox"/> Monitoring	<input type="checkbox"/> Feedlot	<input type="checkbox"/> Domestic (Lawn & Garden)	<input type="checkbox"/> Injection Well	<input type="checkbox"/> Industrial	<input type="checkbox"/> Air Conditioning	<input type="checkbox"/> Other _____
NW	NE																		
X																			
SW	SE																		
<input type="checkbox"/> Domestic	<input type="checkbox"/> Public Water Supply	<input type="checkbox"/> Dewatering																	
<input type="checkbox"/> Irrigation	<input type="checkbox"/> Oil Field Water Supply	<input checked="" type="checkbox"/> Monitoring																	
<input type="checkbox"/> Feedlot	<input type="checkbox"/> Domestic (Lawn & Garden)	<input type="checkbox"/> Injection Well																	
<input type="checkbox"/> Industrial	<input type="checkbox"/> Air Conditioning	<input type="checkbox"/> Other _____																	

5 TYPE OF BLANK CASING USED:

<input checked="" type="checkbox"/> Steel	<input type="checkbox"/> RMP (SR)	<input type="checkbox"/> Wrought	<input type="checkbox"/> Fiberglass	<input type="checkbox"/> Other (Specify below)
<input checked="" type="checkbox"/> PVC	<input type="checkbox"/> ABS	<input type="checkbox"/> Asbestos-Cement	<input type="checkbox"/> Concrete Tile	

Blank casing diameter 2 in. Was casing pulled? Yes No If yes, how much 3'
 Casing height above or below land surface 36 in.

6 GROUT PLUG MATERIAL: Neat cement Cement grout Bentonite Other GRASS 0-0.5

Grout Plug Intervals: From 0.5 ft. to 27.00 ft., From _____ ft. to _____ ft., From _____ ft. to _____ ft.

What is the nearest source of possible contamination:

<input type="checkbox"/> Septic tank	<input type="checkbox"/> Seepage pit	<input checked="" type="checkbox"/> Fuel storage	<input type="checkbox"/> Other (specify below)
<input type="checkbox"/> Sewer lines	<input type="checkbox"/> Pit privy	<input type="checkbox"/> Fertilizer storage	
<input type="checkbox"/> Watertight sewer lines	<input type="checkbox"/> Sewage lagoon	<input type="checkbox"/> Insecticide storage	
<input type="checkbox"/> Lateral lines	<input type="checkbox"/> Feedyard	<input type="checkbox"/> Abandoned water well	Direction from well? _____
<input type="checkbox"/> Cess pool	<input type="checkbox"/> Livestock pens	<input type="checkbox"/> Oil well/Gas well	How many feet? _____

FROM	TO	PLUGGING MATERIALS	FROM	TO	PLUGGING MATERIALS
0	0.5	GRASS			
0.5	27.00	BENTONITE			

7 CONTRACTOR'S OR LANDOWNER'S CERTIFICATION: This water well was plugged under my jurisdiction and was completed on (mo/day/year) 6/12/23 and this record is true to the best of my knowledge and belief. Kansas Water Well Contractor's License No. 585. This Water Well Record was completed on (mo/day/year) 7/6/23 under the business name of ASSOCIATED ENVIRONMENTAL INC. by (signature) _____

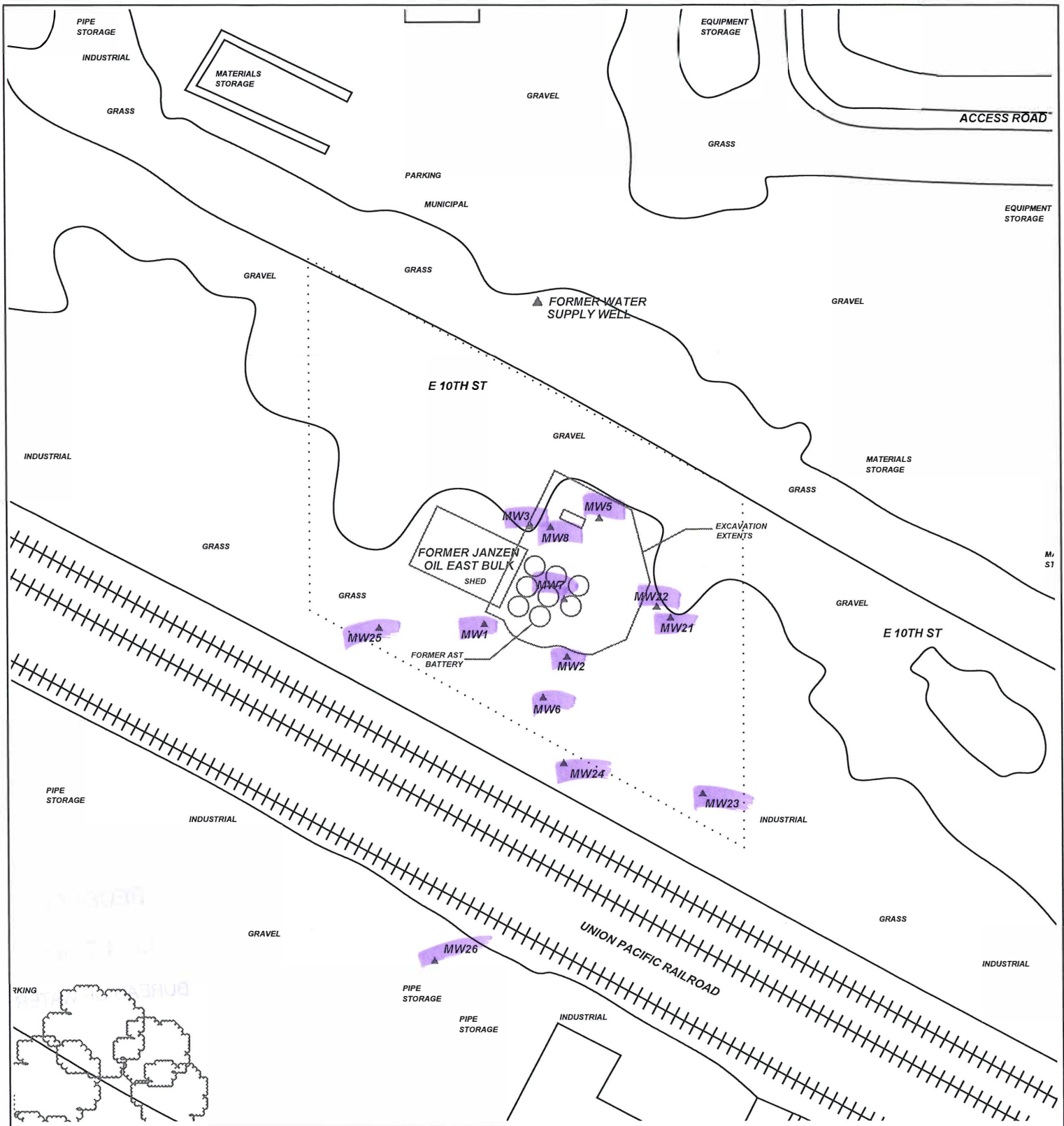

PROJECT: **JANZEN OIL - EAST BULK**

ADDRESS: **E 10TH & VINE**

LOCATION: **HAYS, KS**

DRAWN BY: **C. ROE** DATE: **9/8/21**

REVISED BY: **B. STALNAKER** DATE: **7/6/23**

AEI JOB #: **TF542** KDHE JOB #: **A6-026-40103**

TITLE:

AEI ASSOCIATED ENVIRONMENTAL INC.

LEGEND:

- = FORMER JANZEN OIL - EAST BULK AST BATTERY & TRUCK LOAD OUT
- = EXCAVATION EXTENTS
- = MONITORING WELL
- = PLUGGED/DESTROYED WELL
- = SUBJECT PROPERTY

SCALE: **1" = 100'**

NOTES: **T.14 R.18W Sec.3 Ellis County**

RECEIVED

JUL 17 2023

BUREAU OF WATER