

1 LOCATION OF WATER WELL: County: ELLIS	Fraction NW ¼ SE ¼ SW ¼ NW ¼	Section Number 3	Township Number T 14 S	Range Number 18 <input type="checkbox"/> E <input checked="" type="checkbox"/> W
---	---------------------------------	---------------------	---------------------------	---

Street/Rural Address of Well Location; if unknown, distance & direction from nearest town or intersection: If at owner's address, check here

Global Positioning Systems (GPS) information:
 Latitude: 38.86540 (in decimal degrees)
 Longitude: -99.31622 (in decimal degrees)
 Elevation: 1985.51
 Horizontal Datum: WGS84, NAD83, NAD27
 Collection Method:
 GPS unit (Make/Model: _____)
 Digital Map/Photo, Topographic Map, Land Survey
 Est. Accuracy: < 3 m, 3-5 m, 5-15 m, > 15 m

2 WATER WELL OWNER: JANZEN OIL
 RR#, St. Address, Box #: E 10TH & VINE
 City, State ZIP Code: HAYS, KS 67601

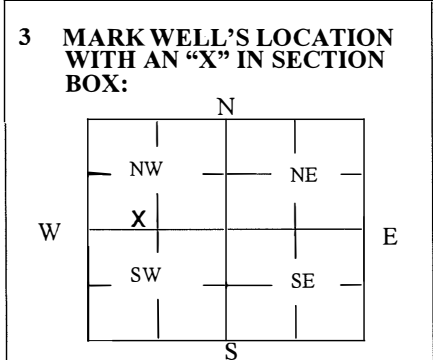

4 DEPTH OF WELL 26.45 ft.
 WELL'S STATIC WATER LEVEL 17.23 ft.
 WELL WAS USED AS:
 Domestic Public Water Supply Dewatering
 Irrigation Oil Field Water Supply Monitoring
 Feedlot Domestic (Lawn & Garden) Injection Well
 Industrial Air Conditioning Other _____
 Was a chemical/bacteriological sample submitted to Department? Yes No

5 TYPE OF BLANK CASING USED:

Steel RMP (SR) Wrought Fiberglass Other (Specify below) _____
 PVC ABS Asbestos-Cement Concrete Tile

Blank casing diameter 2 in. Was casing pulled? Yes No If yes, how much 3'
 Casing height above or below land surface 36 in.

6 GROUT PLUG MATERIAL: Neat cement Cement grout Bentonite Other GRASS 0-0.5

Grout Plug Intervals: From 0.5 ft. to 26.45 ft., From _____ ft. to _____ ft., From _____ ft. to _____ ft.

What is the nearest source of possible contamination:
 Septic tank Seepage pit Fuel storage Other (specify below) _____
 Sewer lines Pit privy Fertilizer storage _____
 Watertight sewer lines Sewage lagoon Insecticide storage _____
 Lateral lines Feedyard Abandoned water well Direction from well? _____
 Cess pool Livestock pens Oil well/Gas well How many feet? _____

FROM	TO	PLUGGING MATERIALS	FROM	TO	PLUGGING MATERIALS
0	0.5	GRASS			
0.5	26.45	BENTONITE			

7 CONTRACTOR'S OR LANDOWNER'S CERTIFICATION: This water well was plugged under my jurisdiction and was completed on (mo/day/year) 6/12/23 and this record is true to the best of my knowledge and belief. Kansas Water Well Contractor's License No. 585. This Water Well Record was completed on (mo/day/year) 7/6/23 under the business name of ASSOCIATED ENVIRONMENTAL INC. by (signature) [Signature]

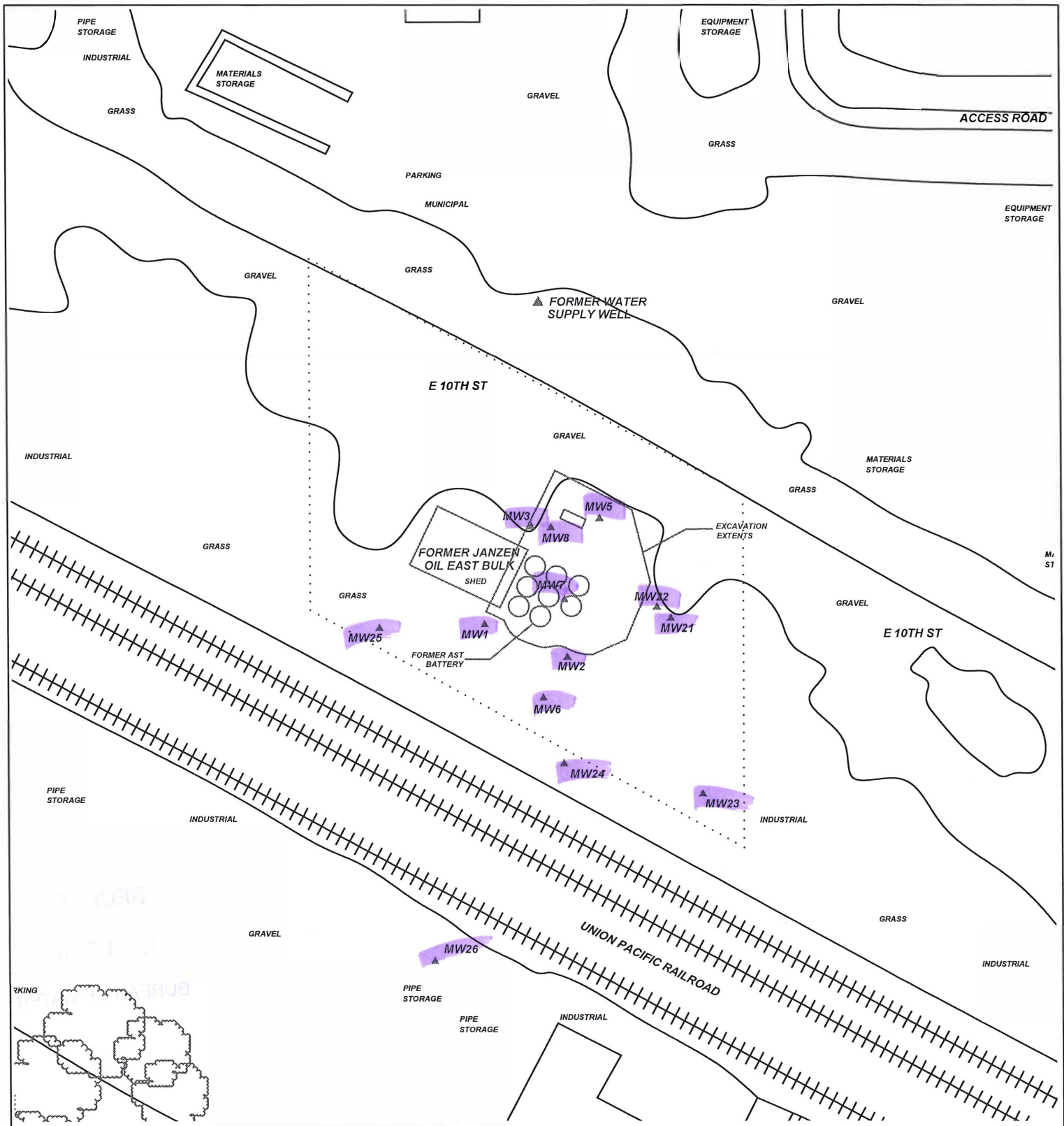

PROJECT: **JANZEN OIL - EAST BULK**

ADDRESS: **E 10TH & VINE**

LOCATION: **HAYS, KS**

DRAWN BY: **C. ROE** DATE: **9/8/21**

REVISED BY: **B. STALNAKER** DATE: **7/6/23**

AEI JOB #: **TF542** KDHE JOB #: **A6-026-40103**

TITLE:

ASSOCIATED ENVIRONMENTAL INC.

LEGEND:

- = FORMER JANZEN OIL - EAST BULK AST BATTERY & TRUCK LOAD OUT
- = EXCAVATION EXTENTS
- = MONITORING WELL
- = PLUGGED/DESTROYED WELL
- = SUBJECT PROPERTY

SCALE: **1" = 100'**

NOTES: **T.14 R.18W Sec.3 Ellis County**

RECEIVED

JUL 17 2023

BUREAU OF WATER