

1 LOCATION OF WATER WELL: County: ELLIS	Fraction NW ¼ SE ¼ SW ¼ NW ¼	Section Number 3	Township Number T 14 S	Range Number 18 <input type="checkbox"/> E <input checked="" type="checkbox"/> W
Street/Rural Address of Well Location; if unknown, distance & direction from nearest town or intersection: If at owner's address, check here <input checked="" type="checkbox"/>		Global Positioning Systems (GPS) information: Latitude: 38.86502 (in decimal degrees) Longitude: -99.31607 (in decimal degrees) Elevation: 1985.90 Horizontal Datum: <input checked="" type="checkbox"/> WGS84, <input type="checkbox"/> NAD83, <input type="checkbox"/> NAD27 Collection Method:		

2 WATER WELL OWNER: JANZEN OIL RR#, St. Address, Box #: E 10TH & VINE City, State ZIP Code: HAYS, KS 67601	<input type="checkbox"/> GPS unit (Make/Model): _____ <input checked="" type="checkbox"/> Digital Map/Photo, <input type="checkbox"/> Topographic Map, <input type="checkbox"/> Land Survey Est. Accuracy: <input checked="" type="checkbox"/> < 3 m, <input type="checkbox"/> 3-5 m, <input type="checkbox"/> 5-15 m, <input type="checkbox"/> > 15 m
---	--

3 MARK WELL'S LOCATION WITH AN "X" IN SECTION BOX:	4 DEPTH OF WELL 31.05 ft. WELL'S STATIC WATER LEVEL 17.42 ft. WELL WAS USED AS:
	<input type="checkbox"/> Domestic <input type="checkbox"/> Public Water Supply <input type="checkbox"/> Dewatering <input type="checkbox"/> Irrigation <input type="checkbox"/> Oil Field Water Supply <input checked="" type="checkbox"/> Monitoring <input type="checkbox"/> Feedlot <input type="checkbox"/> Domestic (Lawn & Garden) <input type="checkbox"/> Injection Well <input type="checkbox"/> Industrial <input type="checkbox"/> Air Conditioning <input type="checkbox"/> Other _____
Was a chemical/bacteriological sample submitted to Department? Yes <input type="checkbox"/> No <input checked="" type="checkbox"/>	

5 TYPE OF BLANK CASING USED:

Steel RMP (SR) Wrought Fiberglass Other (Specify below) _____
 PVC ABS Asbestos-Cement Concrete Tile

Blank casing diameter 2 in. Was casing pulled? Yes No If yes, how much 3'
 Casing height above or below land surface 36 in.

6 GROUT PLUG MATERIAL: Neat cement Cement grout Bentonite Other GRASS 0-0.5

Grout Plug Intervals: From 0.5 ft. to 35.05 ft., From _____ ft. to _____ ft., From _____ ft. to _____ ft.

What is the nearest source of possible contamination:

<input type="checkbox"/> Septic tank	<input type="checkbox"/> Seepage pit	<input checked="" type="checkbox"/> Fuel storage	<input type="checkbox"/> Other (specify below) _____
<input type="checkbox"/> Sewer lines	<input type="checkbox"/> Pit privy	<input type="checkbox"/> Fertilizer storage	
<input type="checkbox"/> Watertight sewer lines	<input type="checkbox"/> Sewage lagoon	<input type="checkbox"/> Insecticide storage	
<input type="checkbox"/> Lateral lines	<input type="checkbox"/> Feedyard	<input type="checkbox"/> Abandoned water well	Direction from well? _____
<input type="checkbox"/> Cess pool	<input type="checkbox"/> Livestock pens	<input type="checkbox"/> Oil well/Gas well	How many feet? _____

FROM	TO	PLUGGING MATERIALS	FROM	TO	PLUGGING MATERIALS
0	0.5	GRASS			
0.5	35.05	BENTONITE			

7 CONTRACTOR'S OR LANDOWNER'S CERTIFICATION: This water well was plugged under my jurisdiction and was completed on (mo/day/year) 6/12/23 and this record is true to the best of my knowledge and belief. Kansas Water Well Contractor's License No. 585. This Water Well Record was completed on (mo/day/year) 7/6/23 under the business name of ASSOCIATED ENVIRONMENTAL INC. by (signature) _____

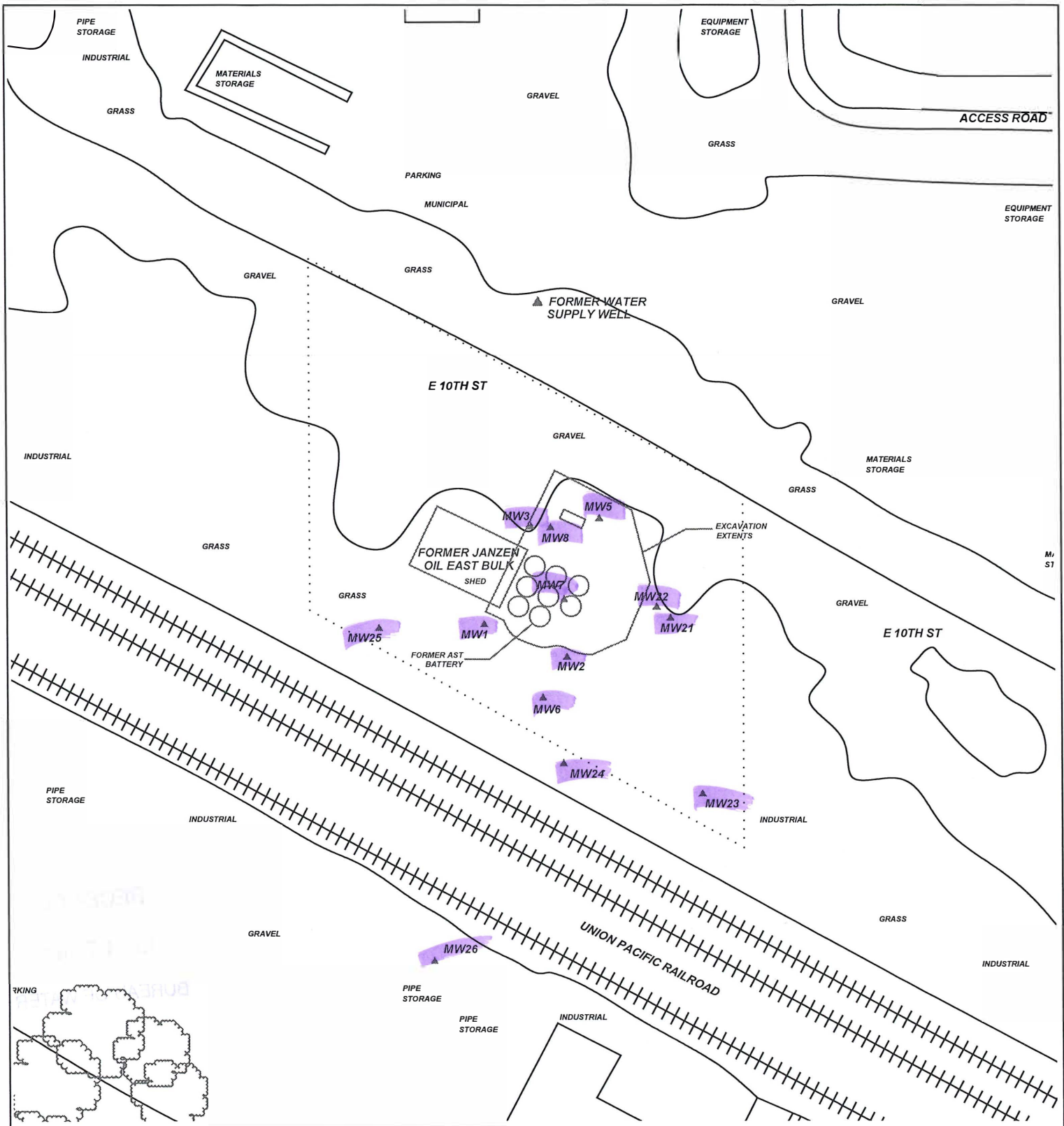

PROJECT: **JANZEN OIL - EAST BULK**

ADDRESS: **E 10TH & VINE**

LOCATION: **HAYS, KS**

DRAWN BY: **C. ROE** DATE: **9/8/21**

REVISED BY: **B. STALNAKER** DATE: **7/6/23**

AEI JOB #: **TF542** KDHE JOB #: **A6-026-40103**

TITLE:

ASSOCIATED ENVIRONMENTAL INC.

LEGEND:

- = FORMER JANZEN OIL - EAST BULK AST BATTERY & TRUCK LOAD OUT
- = EXCAVATION EXTENTS
- = MONITORING WELL
- = PLUGGED/DESTROYED WELL
- = SUBJECT PROPERTY

SCALE: **1" = 100'**

NOTES: **T.14 R.18W Sec.3**
Ellis County

RECEIVED

JUL 17 2023

BUREAU OF WATER