

**WATER WELL PLUGGING RECORD Form WWC-5P**

KSA 82a-1212

ID NO.

MW21

<b>1 LOCATION OF WATER WELL:</b> County: ELLIS	Fraction NW ¼ SE ¼ SW ¼ NW ¼	Section Number 3	Township Number T 14 S	Range Number 18 <input type="checkbox"/> E <input checked="" type="checkbox"/> W
---	---------------------------------	---------------------	---------------------------	---

Street/Rural Address of Well Location; if unknown, distance & direction from nearest town or intersection: If at owner's address, check here

**Global Positioning Systems (GPS) information:**  
 Latitude: 38.86536 (in decimal degrees)  
 Longitude: -99.31571 (in decimal degrees)  
 Elevation: 1985.37  
 Horizontal Datum:  WGS84,  NAD83,  NAD27  
 Collection Method:

**2 WATER WELL OWNER: JANZEN OIL**  
 RR#, St. Address, Box #: E 10TH & VINE  
 City, State ZIP Code: HAYS, KS 67601

GPS unit (Make/Model): \_\_\_\_\_  
 Digital Map/Photo,  Topographic Map,  Land Survey  
 Est. Accuracy:  < 3 m,  3-5 m,  5-15 m,  > 15 m

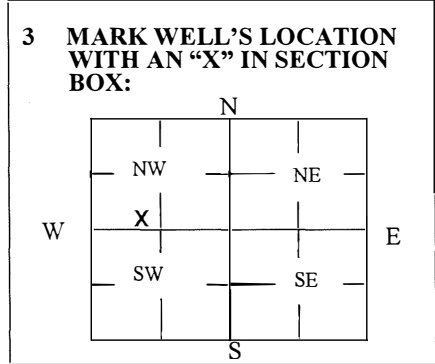

**4 DEPTH OF WELL** 29.08 ft.  
 WELL'S STATIC WATER LEVEL 16.86 ft  
 WELL WAS USED AS:

<input type="checkbox"/> Domestic	<input type="checkbox"/> Public Water Supply	<input type="checkbox"/> Dewatering
<input type="checkbox"/> Irrigation	<input type="checkbox"/> Oil Field Water Supply	<input checked="" type="checkbox"/> Monitoring
<input type="checkbox"/> Feedlot	<input type="checkbox"/> Domestic (Lawn & Garden)	<input type="checkbox"/> Injection Well
<input type="checkbox"/> Industrial	<input type="checkbox"/> Air Conditioning	<input type="checkbox"/> Other _____

Was a chemical/bacteriological sample submitted to Department? Yes  No

**5 TYPE OF BLANK CASING USED:**

<input type="checkbox"/> Steel	<input type="checkbox"/> RMP (SR)	<input type="checkbox"/> Wrought	<input type="checkbox"/> Fiberglass	<input type="checkbox"/> Other (Specify below)
<input checked="" type="checkbox"/> PVC	<input type="checkbox"/> ABS	<input type="checkbox"/> Asbestos-Cement	<input type="checkbox"/> Concrete Tile	_____

Blank casing diameter 2 in. Was casing pulled? Yes  No  If yes, how much 3'  
 Casing height above or below land surface 36 in.

**6 GROUT PLUG MATERIAL:**  Neat cement  Cement grout  Bentonite  Other GRASS 0-0.5

Grout Plug Intervals: From 0.5 ft. to 29.08 ft., From \_\_\_\_\_ ft. to \_\_\_\_\_ ft., From \_\_\_\_\_ ft. to \_\_\_\_\_ ft.

What is the nearest source of possible contamination:

<input type="checkbox"/> Septic tank	<input type="checkbox"/> Seepage pit	<input checked="" type="checkbox"/> Fuel storage	<input type="checkbox"/> Other (specify below)
<input type="checkbox"/> Sewer lines	<input type="checkbox"/> Pit privy	<input type="checkbox"/> Fertilizer storage	_____
<input type="checkbox"/> Watertight sewer lines	<input type="checkbox"/> Sewage lagoon	<input type="checkbox"/> Insecticide storage	_____
<input type="checkbox"/> Lateral lines	<input type="checkbox"/> Feedyard	<input type="checkbox"/> Abandoned water well	Direction from well? _____
<input type="checkbox"/> Cess pool	<input type="checkbox"/> Livestock pens	<input type="checkbox"/> Oil well/Gas well	How many feet? _____

FROM	TO	PLUGGING MATERIALS	FROM	TO	PLUGGING MATERIALS
0	0.5	GRASS			
0.5	29.08	BENTONITE			

**7 CONTRACTOR'S OR LANDOWNER'S CERTIFICATION:** This water well was plugged under my jurisdiction and was completed on (mo/day/year) 6/12/23 and this record is true to the best of my knowledge and belief. Kansas Water Well Contractor's License No. 585. This Water Well Record was completed on (mo/day/year) 7/6/23 under the business name of ASSOCIATED ENVIRONMENTAL INC. by (signature) \_\_\_\_\_

Send one white copy to Kansas Department of Health & Environment, Geology Section, 1000 SW Jackson Street, Ste. 420, Topeka, KS 66612-1367. Send one copy to WATER WELL OWNER and retain one for your records.  
 Visit us at <http://www.kdheks.gov/waterwell/index.html> Telephone 785-296-5524.

KSA82a-1212 Revised 1/20/2015

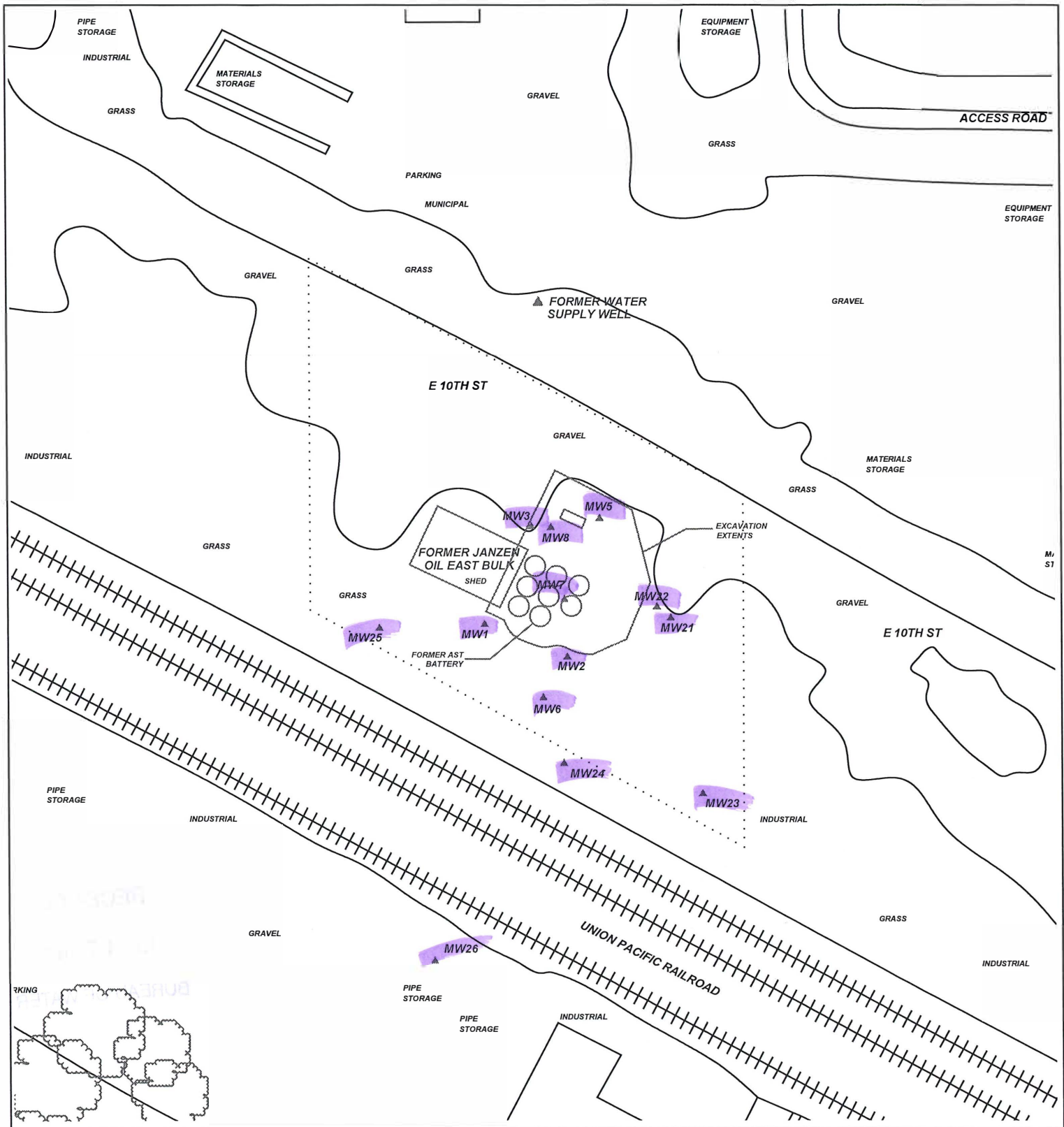





**PROJECT:** JANZEN OIL - EAST BULK  
**ADDRESS:** E 10TH & VINE  
**LOCATION:** HAYS, KS  
**DRAWN BY:** C. ROE **DATE:** 9/8/21  
**REVISED BY:** B. STALNAKER **DATE:** 7/6/23  
**AEI JOB #:** TF542 **KDHE JOB #:** A6-026-40103

**TITLE:**



**ASSOCIATED ENVIRONMENTAL INC.**

**LEGEND:**

-  = FORMER JANZEN OIL - EAST BULK AST BATTERY & TRUCK LOAD OUT
-  = EXCAVATION EXTENTS
-  = MONITORING WELL
-  = PLUGGED/DESTROYED WELL
-  = SUBJECT PROPERTY

**RECEIVED**  
**JUL 17 2023**  
**BUREAU OF WATER**

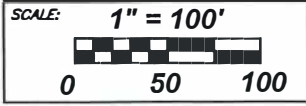

**NOTES:** T.14 R.18W Sec.3  
 Ellis County