

**WATER WELL PLUGGING RECORD**

Form WWC-5P

KSA 82a-1212

ID NO.

**MW1**

<b>1 LOCATION OF WATER WELL:</b> County: Ellis	Fraction SE ¼ NW ¼ SE ¼ NE ¼	Section Number 4	Township Number T 14 S	Range Number 24 <input type="checkbox"/> E <input checked="" type="checkbox"/> W
---	---------------------------------	---------------------	---------------------------	---

Street/Rural Address of Well Location; if unknown, distance & direction from nearest town or intersection: If at owner's address, check here

**Global Positioning Systems (GPS) information:**  
 Latitude: NA (in decimal degrees)  
 Longitude: NA (in decimal degrees)  
 Elevation: NA  
 Horizontal Datum  WGS84,  NAD83,  NAD27  
 Collection Method:

**2 WATER WELL OWNER:** Kansasland Tire  
 RR#, St. Address, Box #: 730 E 8th  
 City, State ZIP Code: Hays, KS 67601

GPS unit (Make/model): \_\_\_\_\_  
 Digital Map/Photo,  Topographic Map  Land Survey

Est. Accuracy:  <3 m,  3-5 m,  5-15 m,  >15 m

**3 MARK WELL'S LOCATION WITH AN "X" IN SECTION BOX:**

N			
NW		NE	
			X
W			E
SW		SE	
S			

**4 DEPTH OF WELL** 24.05 ft. MW1

WELL'S STATIC WATER LEVEL NA ft

WELL WAS USED AS:

<input type="checkbox"/> Domestic	<input type="checkbox"/> Public Water Supply	<input type="checkbox"/> Dewatering
<input type="checkbox"/> Irrigation	<input type="checkbox"/> Oil Field Water Supply	<input checked="" type="checkbox"/> Monitoring
<input type="checkbox"/> Feedlot	<input type="checkbox"/> Domestic (Lawn & Garden)	<input type="checkbox"/> Injection Well
<input type="checkbox"/> Industrial	<input type="checkbox"/> Air Conditioning	<input type="checkbox"/> Other _____

Was a chemical/bacteriological sample submitted to Department? Yes  No

**5 TYPE OF BLANK CASING USED:**

<input checked="" type="checkbox"/> Steel	<input type="checkbox"/> RMP (SR)	<input type="checkbox"/> Wrought	<input type="checkbox"/> Fiberglass	<input type="checkbox"/> Other (Specific below)
<input checked="" type="checkbox"/> PVC	<input type="checkbox"/> ABS	<input type="checkbox"/> Asbestos-Cement	<input type="checkbox"/> Concrete Tile	_____

Blank casing diameter 2 in. Was casing pulled? Yes  No  If yes, how much 3'

Casing height above or below land surface NA in.

**6 GROUT PLUG MATERIAL:**  Neat cement  Cement grout  Bentonite  Other Concrete: 0-0.3'; Soil/gravel: 0.3-3'

Grout Plug Intervals: From 3 ft to 24.05 ft, From \_\_\_\_\_ ft to \_\_\_\_\_ ft, From \_\_\_\_\_ ft to \_\_\_\_\_ ft,

What is the nearest source of possible contamination:

<input type="checkbox"/> Septic tank	<input type="checkbox"/> Seepage pit	<input type="checkbox"/> Fuel storage	<input type="checkbox"/> Other (specify below)
<input type="checkbox"/> Sewer lines	<input type="checkbox"/> Pit privy	<input type="checkbox"/> Fertilizer storage	_____
<input type="checkbox"/> Watertight sewer lines	<input type="checkbox"/> Sewage lagoon	<input type="checkbox"/> Insecticide storage	_____
<input type="checkbox"/> Lateral lines	<input type="checkbox"/> Feed yard	<input type="checkbox"/> Abandoned water well	Direction from well? _____
<input type="checkbox"/> Cess pool	<input type="checkbox"/> Livestock pens	<input type="checkbox"/> Oil well/Gas well	How many feet? _____

FROM	TO	PLUGGING MATERIALS	FROM	TO	PLUGGING MATERIALS
0	0.3	Concrete			
0.3	3	Soil/gravel			
3	24.05	Bentonite			

Notes: KDHE ID: Kansasland Tire Co., Inc; U6-026-00773

**7 CONTRACTOR'S OR LANDOWNER'S CERTIFICATION:** This water well was plugged under my jurisdiction and was completed on (mo/day/year) 10/5-6/20 and this record is true to the best of my knowledge and belief. Kansas Water Contractor's License No. 757. This Water Well Record was completed on (mo/day/year) 10/11/2020 under the business name of Larsen & Associates, Inc. By (signature) \_\_\_\_\_

Send one white copy to Kansas Department of Health & Environment, Geology Section, 1066 SW Jackson Street, Ste. 420, Topeka, KS 66612-1367. Send one copy to WATER WELL OWNER and retain one for your records  
 Visit us at <http://www.kdheks.gov/waterwell/index.html> Telephone 785-296-5524.

NOTE: Figures exhibited within this report are only to be used within the context of this report. Placement of property lines, wells, structures, and roads is based on the available information from county appraiser maps, surveys, site visits, and/or previous vendor reports and should be considered approximate.

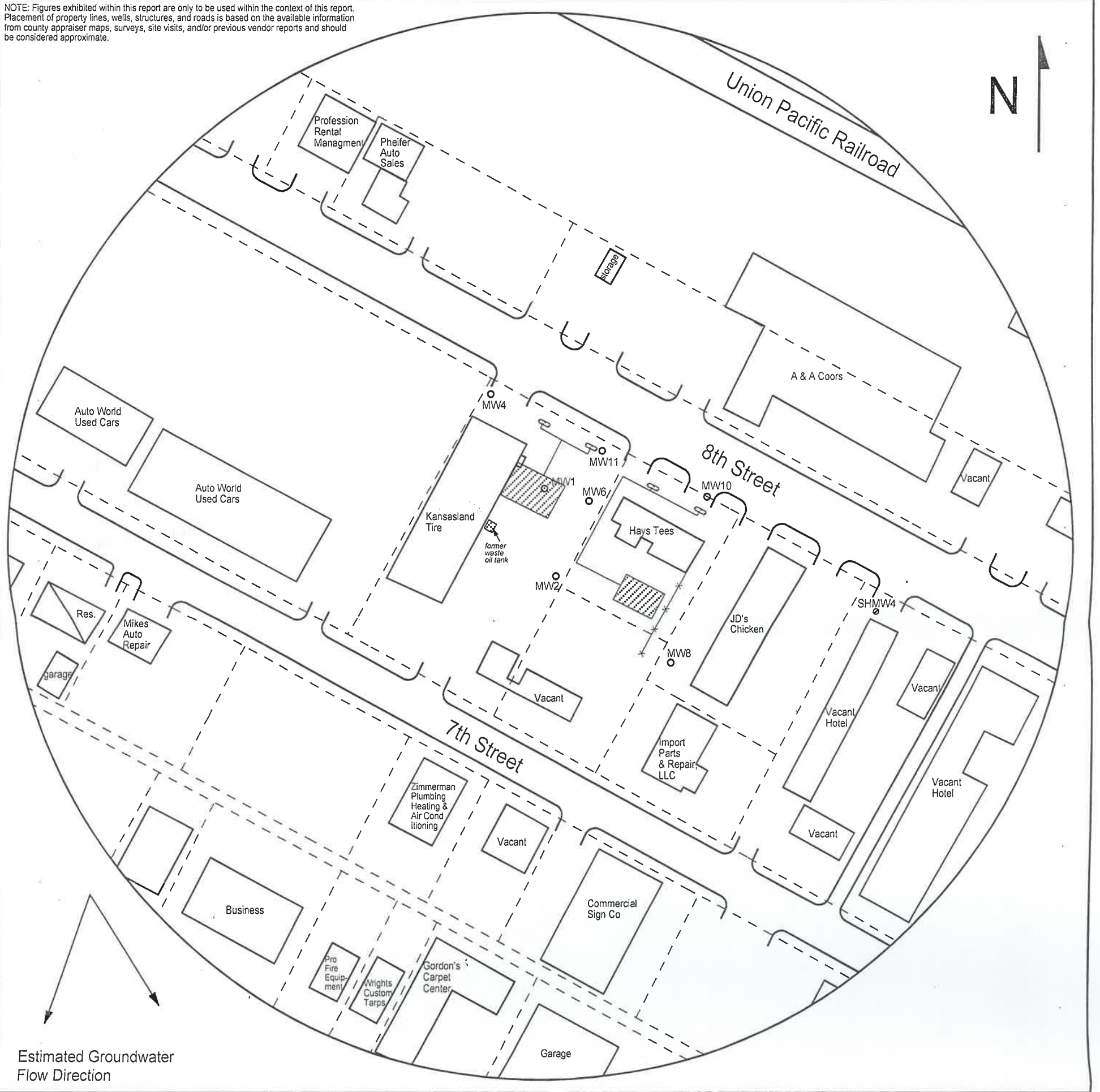

FIGURE 1 - 500 FT RADIUS AREA BASE MAP

**LEGEND**

- Approximate Location of Former UST Basin, Product Lines & Pump Islands
- Building with Basement
- Approximate Location of Property Line
- Plugged Well
- Destroyed Well

NOTE: Utility depths, heights and locations are approximate.



**PROJECT:**

Kansasland Tire Co., Inc.  
 730 E 8th  
 Hays, KS  
 KDHE ID: U6-026-00773  
 Date: 10/5-6/20



1311 E 25th St., Suite B    785-841-8707 office  
 Lawrence, KS 66046        785-865-4282 fax