

<b>1 LOCATION OF WATER WELL:</b> County: <u>SALINE</u>	Fraction: <u>SW 1/4 SW 1/4 NW 1/4</u>	Section Number: <u>12</u>	Township Number: <u>14</u>	Range Number: <u>3</u> E/W
---	---------------------------------------	---------------------------	----------------------------	----------------------------

Distance and direction from nearest town or city street address of well if located within city?

525 N. 8<sup>th</sup> MW - CAS9

<b>2 WATER WELL OWNER:</b> <u>CONTINENTAL ANALYTICAL SERVICE</u> RR#, St. Address, Box #: <u>525 N. 8<sup>th</sup></u> City, State ZIP Code: <u>SALINA, KS 67401</u>	<b>Global Positioning Systems (decimal degrees, min. of 4 digits)</b> Latitude: _____ Longitude: _____ Elevation: _____ Datum: _____ Data Collection Method: _____
---	---

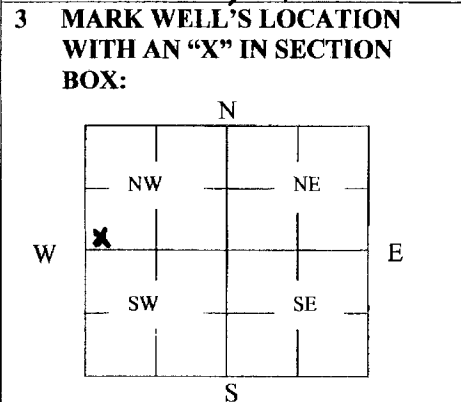

**4 DEPTH OF WELL** 40 ft.

WELL'S STATIC WATER LEVEL 30 ft.

WELL WAS USED AS:

1 Domestic	5 Public Water Supply	9 Dewatering
2 Irrigation	6 Oil Field Water Supply	<u>10 Monitoring</u>
3 Feedlot	7 Domestic (Lawn & Garden)	11 Injection Well
4 Industrial	8 Air Conditioning	12 Other _____

Was a chemical/bacteriological sample submitted to Department? Yes \_\_\_\_\_ No \_\_\_\_\_

**5 TYPE OF BLANK CASING USED:**

1 Steel	3 RMP (SR)	5 Wrought	7 Fiberglass	9 Other (Specify below)
<u>2 PVC</u>	4 ABS	6 Asbestos-Cement	8 Concrete Tile	_____

Blank casing diameter 2 in. Was casing pulled? Yes X No \_\_\_\_\_ If yes, how much ALL

Casing height above or below land surface \_\_\_\_\_ in.

**6 GROUT PLUG MATERIAL:** 1 Neat cement 2 Cement grout 3 Bentonite 4 Other \_\_\_\_\_

Grout Plug Intervals: From 0 ft. to 40 ft., From \_\_\_\_\_ ft. to \_\_\_\_\_ ft., From \_\_\_\_\_ to \_\_\_\_\_ ft.

What is the nearest source of possible contamination:

1 Septic tank	6 Seepage pit	11 Fuel Storage	16 Other (specify below)
2 Sewer lines	7 Pit privy	12 Fertilizer storage	_____
3 Watertight sewer lines	8 Sewage lagoon	13 Insecticide storage	_____
4 Lateral lines	9 Feedyard	14 Abandoned water well	Direction from well? _____
5 Cess pool	10 Livestock pens	15 Oil well/Gas well	How many feet? _____

FROM	TO	PLUGGING MATERIALS	FROM	TO	PLUGGING MATERIALS
<u>0</u>	<u>40</u>	<u>BENTONITE HOLE PLUG</u>			

**7 CONTRACTOR'S OR LANDOWNER'S CERTIFICATION:** This water well was plugged under my jurisdiction and was completed on (mo/day/year) 02-16-16 and this record is true to the best of my knowledge and belief. Kansas Water Well Contractor's License No. 388. This Water Well Record was completed on (mo/day/year) 02-19-16 under the business name of \_\_\_\_\_ by (signature) Paul P. [Signature]

**INSTRUCTIONS:** Use typewriter or ballpoint pen. Please press firmly and print clearly. Please fill in blanks, underline or circle the correct answers. Send top three copies to Kansas Department of Health and Environment, Bureau of Water, Geology Section, 1000 SW Jackson St., Ste. 420, Topeka, Kansas 66612-1367. Telephone: 785/296-5522. Send one to Water Well Owner and retain one for your records. Visit us at <http://www.kdheks.gov/geo/waterwells>.

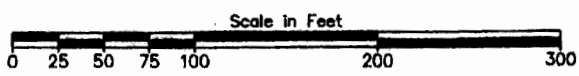
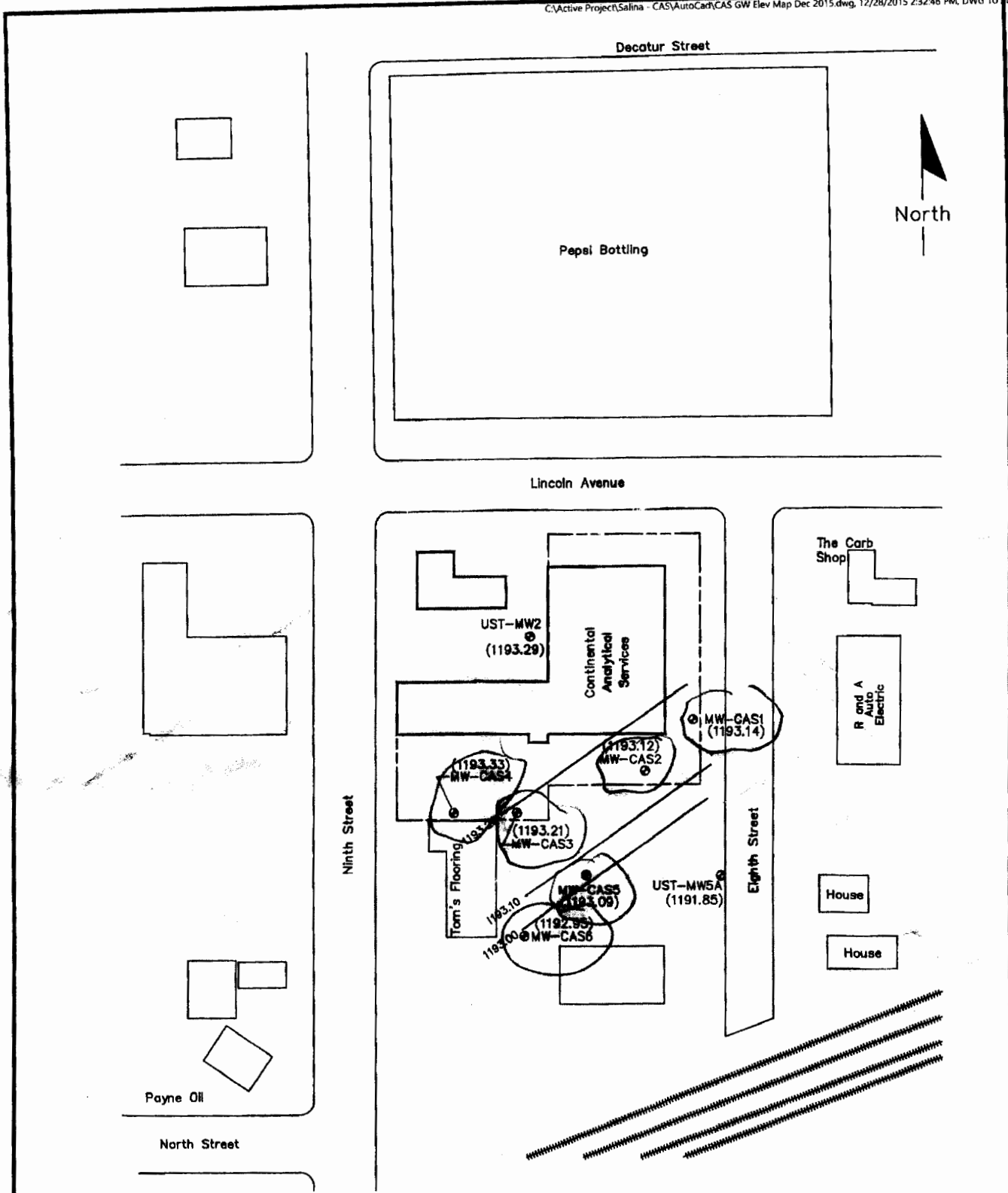

LEGEND  
 ⊕ Monitor Well  
 (1198.44) Groundwater Elevation (ft. a.s.l.) - 10 December 2015

Groundwater Elevations - 10 December 2015

ENVIRO TECH SERVICES, INC.		
Continental Analytical Services Inc. Salina, Kansas		
Project Number: 01-015	Date: Dec. 2015	Drawn By: Jack Eslick