

WATER WELL PLUGGING RECORD Form WWC-5P

KSA 82a-1212

ID NO.

MW-1

1 LOCATION OF WATER WELL:
 Salina, KS
 Fraction: NW ¼ NE ¼ NW ¼
 Section Number: 23
 Township Number: T14 S
 Range Number: R3 W
 Distance and direction from nearest town or city street address of well if located within city?
 700 S. Broadway, Salina, KS

2 WATER WELL OWNER:
 Payne Oil Company
 Box 671
 Salina, KS 67402
Global Positioning Systems (decimal degrees, min. of 4 digits
 Latitude: 38.8266667
 Longitude: -97.6252778
 Elevation: 1230.01
 Datum: NAD27
 Data Collection Method: Survey

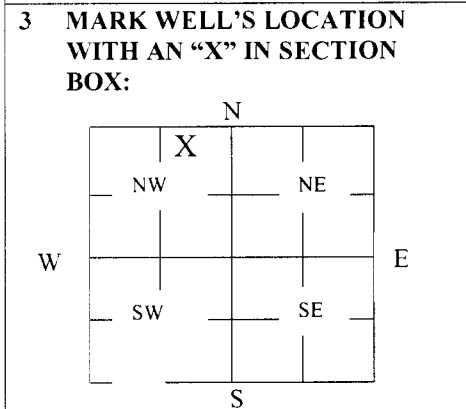

4 DEPTH OF WELL 38.20 ft.
 WELL'S STATIC WATER LEVEL 26.33 ft
 WELL WAS USED AS: X
 1 Domestic 5 Public Water Supply 9 Dewatering
 2 Irrigation 6 Oil Field Water Supply 10 Monitoring
 3 Feedlot 7 Domestic (Lawn & Garden) 11 Injection Well
 4 Industrial 8 Air Conditioning 12 Other _____
 Was a chemical/bacteriological sample submitted to Department? Yes _____ No x

5 TYPE OF BLANK CASING USED:
 1 Steel 3 RMP (SR) 5 Wrought 7 Fiberglass 9 Other (Specify below)
 2 PVC 4 ABS 6 Asbestos-Cement 8 Concrete Tile
 Blank casing diameter 2 in. Was casing pulled? Yes x No _____ If yes, how much 3'
 Casing height above or below land surface 36 in.

6 GROUT PLUG MATERIAL: 1 Neat cement 2 Cement grout 3 Bentonite 4 Other Soil _____
 Grout Plug Intervals: 3 From 3 ft. to 38.20 ft., 4 From 0 ft. to 3 ft., From _____ to _____ ft.
 What is the nearest source of possible contamination:
 1 Septic tank 6 Seepage pit 11 Fuel Storage 16 Other (specify below)
 2 Sewer lines 7 Pit privy 12 Fertilizer storage Contaminated Site U5-085-11371
 3 Watertight sewer lines 8 Sewage lagoon 13 Insecticide storage
 4 Lateral lines 9 Feedyard 14 Abandoned water well Direction from well? East
 5 Cess pool 10 Livestock pens 15 Oil well/Gas well How many feet? 100 ft

FROM	TO	PLUGGING MATERIALS	FROM	TO	PLUGGING MATERIALS
0	0.5	Asphalt			
0.5	3	Compacted Silt/Clays			
3	38.20	Hydrated Bentonite chips			

7 CONTRACTOR'S OR LANDOWNER'S CERTIFICATION: This water well was plugged under my jurisdiction and was completed on (mo/day/year) 8/24/2016 and this record is true to the best of my knowledge and belief. Kansas Water Well Contractor's License No. 585. This Water Well Record was completed on (mo/day/year) 8/30/2016 under the business name of Associated Environmental, Inc. by (signature) *Bradley Johnson*

INSTRUCTIONS: Use typewriter or ballpoint pen. Please press firmly and print clearly. Please fill in blanks, underline or circle the correct answers. Send top three copies to Kansas Department of Health and Environment, Bureau of Water, Geology Section, 1000 SW Jackson St., Ste. 420, Topeka, Kansas 66612-1367. Telephone: 785/296-5522. Send one to Water Well Owner and retain one for your records. Visit us at <http://www.kdheks.gov/waterwell/index.html>.

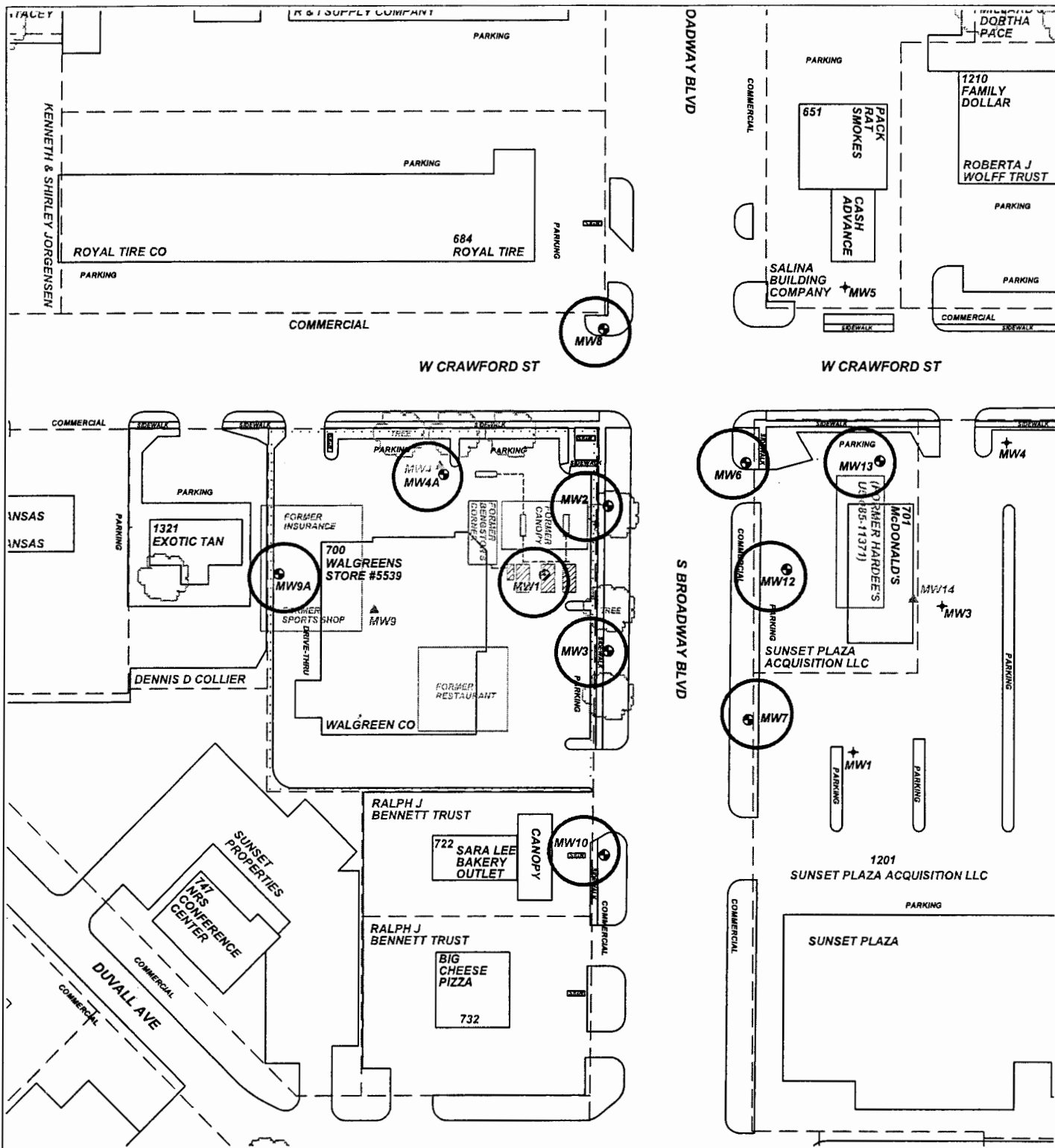

PROJECT:	Bengston's Corner	
ADDRESS:	700 S. Broadway	
LOCATION:	Salina, KS	
DRAWN BY:	B. Scott	DATE: 02/18/15
REVISED BY:	C. Roe	DATE: 05/04/16
AEI JOB #:	TF480	KDHE JOB #: U5-085-00567

TITLE: **Figure 2.1
Site Map
350' Radius**

ASSOCIATED ENVIRONMENTAL INC.

LEGEND:

- = Former Bengston's Corner Fueling Station & Assoc. System
- = Monitor Well Location (Bengston's Corner U5-085-00567)
- = Plugged/Destroyed Well Location
- = Monitor Well Location (Salina Gas & Food, LLC U5-085-14472)
- = T&M Monitor Well Location (Hardee's U5-085-11371)
- = Site Property Boundary
- = Parcel Boundary Lines

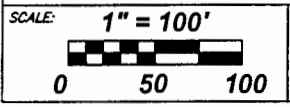

NOTES: