

1 LOCATION OF WATER WELL: Salina, KS	Fraction NW¼ NE¼ NW¼	Section Number 23	Township Number T14 S	Range Number R3 W
--	-------------------------	----------------------	--------------------------	----------------------

Distance and direction from nearest town or city street address of well if located within city?
700 S. Broadway, Salina, KS

2 WATER WELL OWNER: Payne Oil Company Box 671 Salina, KS 67402	Global Positioning Systems (decimal degrees, min. of 4 digits) Latitude: <u>38.82667</u> Longitude: <u>-97.625834</u> Elevation: _____ Datum: _____ Data Collection Method: GPS
---	---

3 MARK WELL'S LOCATION WITH AN "X" IN SECTION BOX: <div style="text-align: center;"> <table border="1" style="margin: auto; border-collapse: collapse;"> <tr><td colspan="2" style="text-align: center;">N</td></tr> <tr><td style="text-align: center;">X</td><td style="text-align: center;"> </td></tr> <tr><td style="text-align: center;">NW</td><td style="text-align: center;">NE</td></tr> <tr><td style="text-align: center;"> </td><td style="text-align: center;"> </td></tr> <tr><td style="text-align: center;">SW</td><td style="text-align: center;">SE</td></tr> <tr><td colspan="2" style="text-align: center;">S</td></tr> </table> </div>	N		X		NW	NE			SW	SE	S		4 DEPTH OF WELL <u>27.78</u> ft. WELL'S STATIC WATER LEVEL <u>27.32</u> ft. WELL WAS USED AS: X <table style="width: 100%;"> <tr> <td>1 Domestic</td> <td>5 Public Water Supply</td> <td>9 Dewatering</td> </tr> <tr> <td>2 Irrigation</td> <td>6 Oil Field Water Supply</td> <td>10 Monitoring</td> </tr> <tr> <td>3 Feedlot</td> <td>7 Domestic (Lawn & Garden)</td> <td>11 Injection Well</td> </tr> <tr> <td>4 Industrial</td> <td>8 Air Conditioning</td> <td>12 Other _____</td> </tr> </table> <p>Was a chemical/bacteriological sample submitted to Department? Yes _____ No <u>x</u> _____</p>	1 Domestic	5 Public Water Supply	9 Dewatering	2 Irrigation	6 Oil Field Water Supply	10 Monitoring	3 Feedlot	7 Domestic (Lawn & Garden)	11 Injection Well	4 Industrial	8 Air Conditioning	12 Other _____
N																									
X																									
NW	NE																								
SW	SE																								
S																									
1 Domestic	5 Public Water Supply	9 Dewatering																							
2 Irrigation	6 Oil Field Water Supply	10 Monitoring																							
3 Feedlot	7 Domestic (Lawn & Garden)	11 Injection Well																							
4 Industrial	8 Air Conditioning	12 Other _____																							

5 TYPE OF BLANK CASING USED:

1 Steel	3 RMP (SR)	5 Wrought	7 Fiberglass	9 Other (Specify below)
2 PVC	4 ABS	6 Asbestos-Cement	8 Concrete Tile	_____

Blank casing diameter 2 in. Was casing pulled? Yes x No _____ If yes, how much 3'
 Casing height above or below land surface 36 in.

6 GROUT PLUG MATERIAL: 1 Neat cement 2 Cement grout 3 Bentonite 4 Other Soil

Grout Plug Intervals: 3 From 3 ft. to 24 ft., 4 From 0.5 ft. to 3 ft., From _____ to _____ ft.

What is the nearest source of possible contamination:

1 Septic tank	6 Seepage pit	11 Fuel Storage	16 Other (specify below)
2 Sewer lines	7 Pit privy	12 Fertilizer storage	<u>Contaminated Site U5-085-11371</u>
3 Watertight sewer lines	8 Sewage lagoon	13 Insecticide storage	
4 Lateral lines	9 Feedyard	14 Abandoned water well	Direction from well? <u>East</u>
5 Cess pool	10 Livestock pens	15 Oil well/Gas well	How many feet? <u>300 ft</u>

FROM	TO	PLUGGING MATERIALS	FROM	TO	PLUGGING MATERIALS
0'	0.5	Asphalt			
0.5	3	Compacted Silt/Clays			
3	27.78	Hydrated Bentonite chips			

7 CONTRACTOR'S OR LANDOWNER'S CERTIFICATION: This water well was plugged under my jurisdiction and was completed on (mo/day/year) 8/24/2016 and this record is true to the best of my knowledge and belief. Kansas Water Well Contractor's License No. 585. This Water Well Record was completed on (mo/day/year) 8/30/2016 under the business name of Associated Environmental, Inc. by (signature)

INSTRUCTIONS: Use typewriter or ballpoint pen. Please press firmly and print clearly. Please fill in blanks, underline or circle the correct answers. Send top three copies to Kansas Department of Health and Environment, Bureau of Water, Geology Section, 1000 SW Jackson St., Ste. 420, Topeka, Kansas 66612-1367. Telephone: 785/296-5522. Send one to Water Well Owner and retain one for your records. Visit us at <http://www.kdheks.gov/waterwell/index.html>.

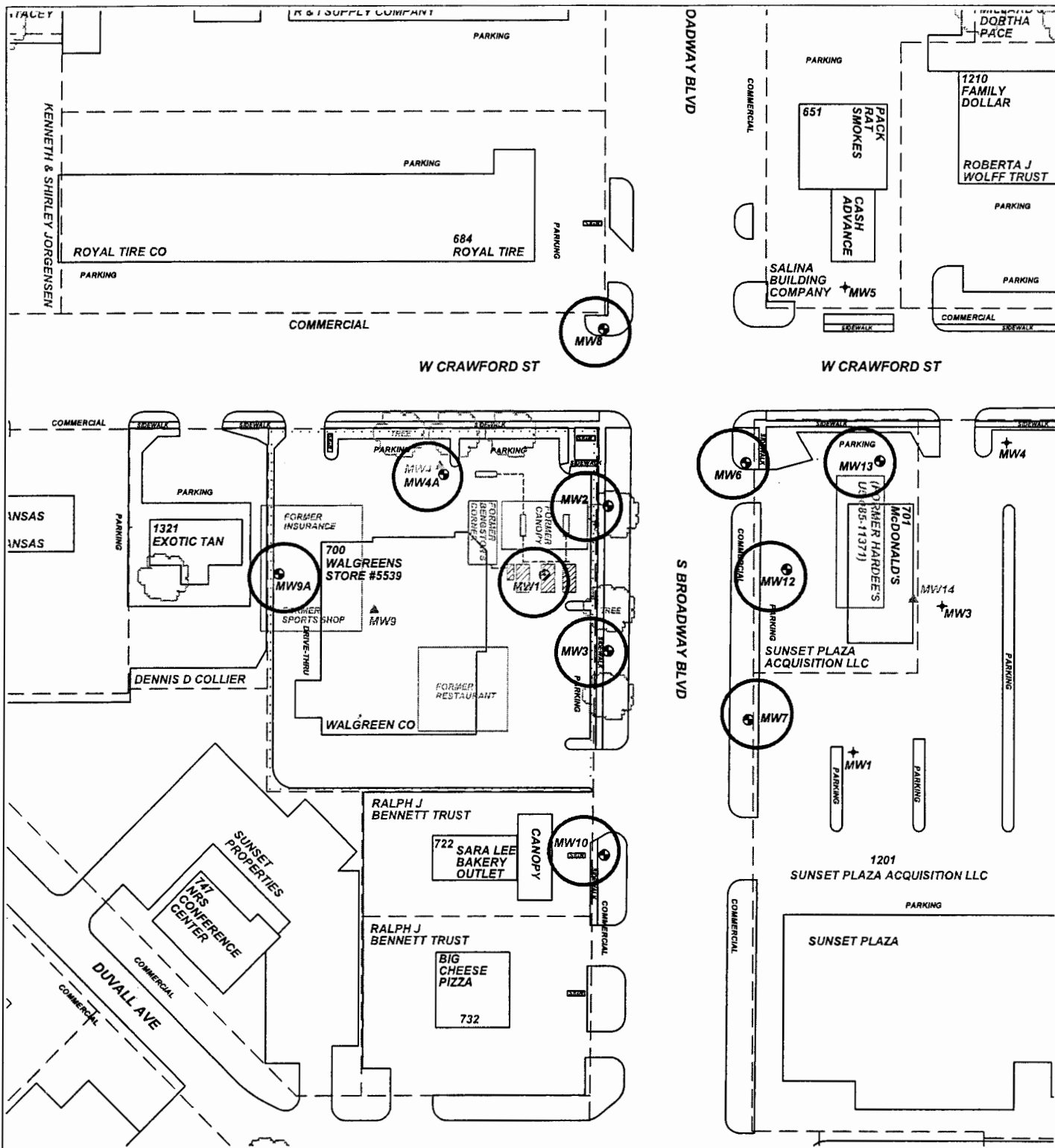

PROJECT:	Bengston's Corner	
ADDRESS:	700 S. Broadway	
LOCATION:	Salina, KS	
DRAWN BY:	B. Scott	DATE: 02/18/15
REVISED BY:	C. Roe	DATE: 05/04/16
AEI JOB #:	TF480	KDHE JOB #: U5-085-00567

TITLE: **Figure 2.1
Site Map
350' Radius**

ASSOCIATED ENVIRONMENTAL INC.

LEGEND:

- = Former Bengston's Corner Fueling Station & Assoc. System
- = Monitor Well Location (Bengston's Corner U5-085-00567)
- = Plugged/Destroyed Well Location
- = Monitor Well Location (Salina Gas & Food, LLC U5-085-14472)
- = T&M Monitor Well Location (Hardee's U5-085-11371)
- = Site Property Boundary
- = Parcel Boundary Lines

SCALE: **1" = 100'**

NOTES: