

WATER WELL PLUGGING RECORD Form WWC-5P KSA 82a-1212 ID NO. MW8

1 LOCATION OF WATER WELL: County: SALINE Fraction NE 1/4 NW 1/4 NW 1/4 1/4 Section Number 23 Township Number T 14 S Range Number 3 E W

Street/Rural Address of Well Location; if unknown, distance & direction from nearest town or intersection: If at owner's address, check here

Global Positioning Systems (GPS) information:
 Latitude: 38.826884 (in decimal degrees)
 Longitude: -97.629026 (in decimal degrees)
 Elevation: 1229.18
 Horizontal Datum: WGS84, NAD83, NAD27
 Collection Method:

2 WATER WELL OWNER: SALINA GAS AND FOOD LLC
 RR#, St. Address, Box #: 1501 W. CRAWFORD ST.
 City, State ZIP Code: SALINA, KS 67401

GPS unit (Make/Model: _____)
 Digital Map/Photo, Topographic Map, Land Survey
 Est. Accuracy: < 3 m, 3-5 m, 5-15 m, > 15 m

3 MARK WELL'S LOCATION WITH AN "X" IN SECTION BOX:

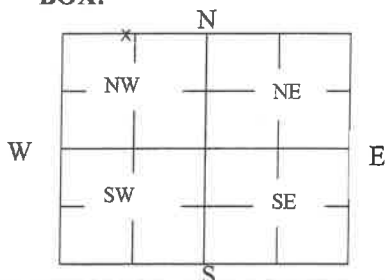

4 DEPTH OF WELL 30.05 ft.

WELL'S STATIC WATER LEVEL 14.24 ft

WELL WAS USED AS:

- Domestic
- Public Water Supply
- Dewatering
- Irrigation
- Oil Field Water Supply
- Monitoring
- Feedlot
- Domestic (Lawn & Garden)
- Injection Well
- Industrial
- Air Conditioning
- Other _____

Was a chemical/bacteriological sample submitted to Department? Yes No

5 TYPE OF BLANK CASING USED:

- Steel
- RMP (SR)
- Wrought
- Fiberglass
- Other (Specify below) _____
- PVC
- ABS
- Asbestos-Cement
- Concrete Tile

Blank casing diameter 2 in. Was casing pulled? Yes No If yes, how much 3'
 Casing height above or below land surface 0 in.

6 GROUT PLUG MATERIAL: Neat cement Cement grout Bentonite Other _____

Grout Plug Intervals: From 3 ft. to 30.05 ft., From _____ ft. to _____ ft., From _____ ft. to _____ ft.

What is the nearest source of possible contamination:

- Septic tank
 - Seepage pit
 - Fuel storage
 - Other (specify below) _____
 - Sewer lines
 - Pit privy
 - Fertilizer storage
 - Watertight sewer lines
 - Sewage lagoon
 - Insecticide storage
 - Lateral lines
 - Feedyard
 - Abandoned water well
 - Oil well/Gas well
 - Cess pool
 - Livestock pens
- Direction from well? NORTHEAST
 How many feet? 80

FROM	TO	PLUGGING MATERIALS	FROM	TO	PLUGGING MATERIALS
0	3	SOIL			
3	30.05	BENTONITE			

7 CONTRACTOR'S OR LANDOWNER'S CERTIFICATION: This water well was plugged under my jurisdiction and was completed on (mo/day/year) 10/17/19 _____ and this record is true to the best of my knowledge and belief. Kansas Water Well Contractor's License No. 585. This Water Well Record was completed on (mo/day/year) 11/6/19 _____ under the business name of ASSOCIATED ENVIRONMENTAL INC by (signature) _____

Send one white copy to Kansas Department of Health & Environment, Geology Section, 1000 SW Jackson Street, Ste. 420, Topeka, KS 66612-1367. Send one copy to WATER WELL OWNER and retain one for your records.
 Visit us at <http://www.kdheks.gov/waterwell/index.html> Telephone 785-296-5524.

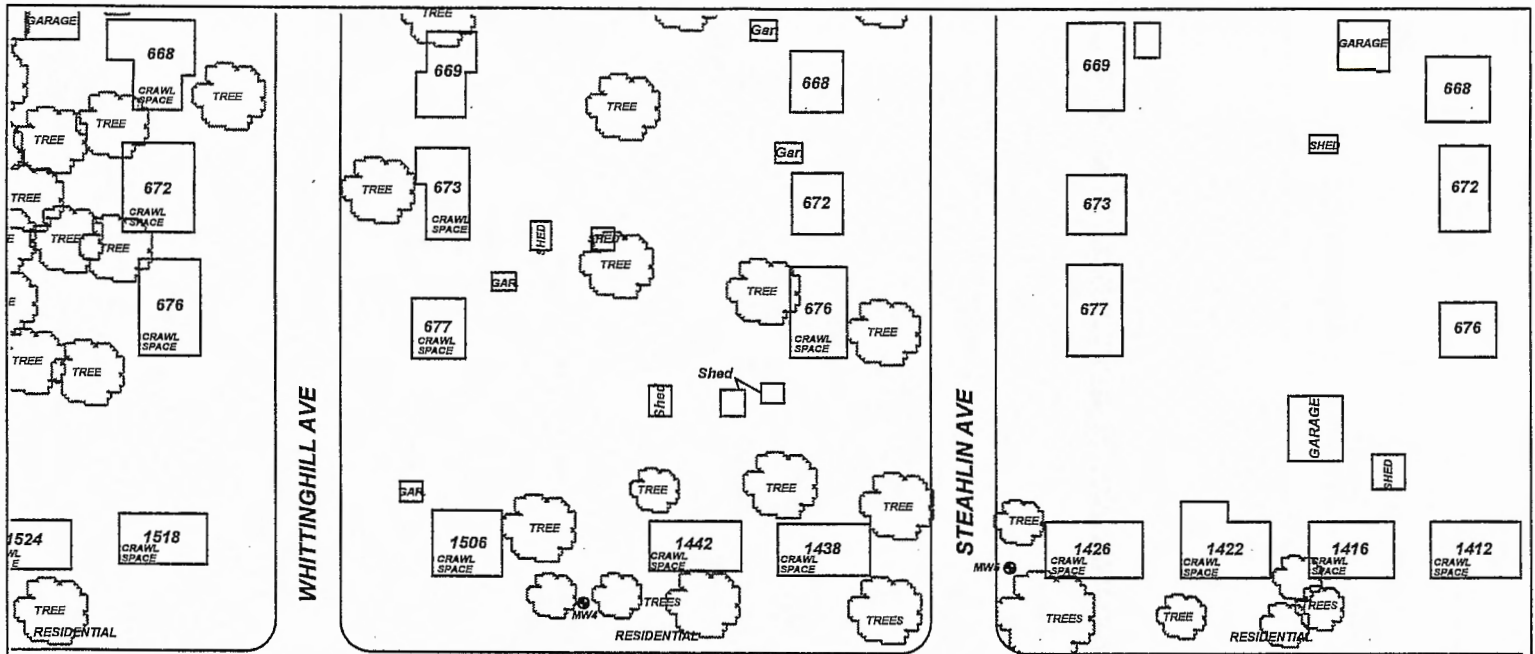

W CRAWFORD ST

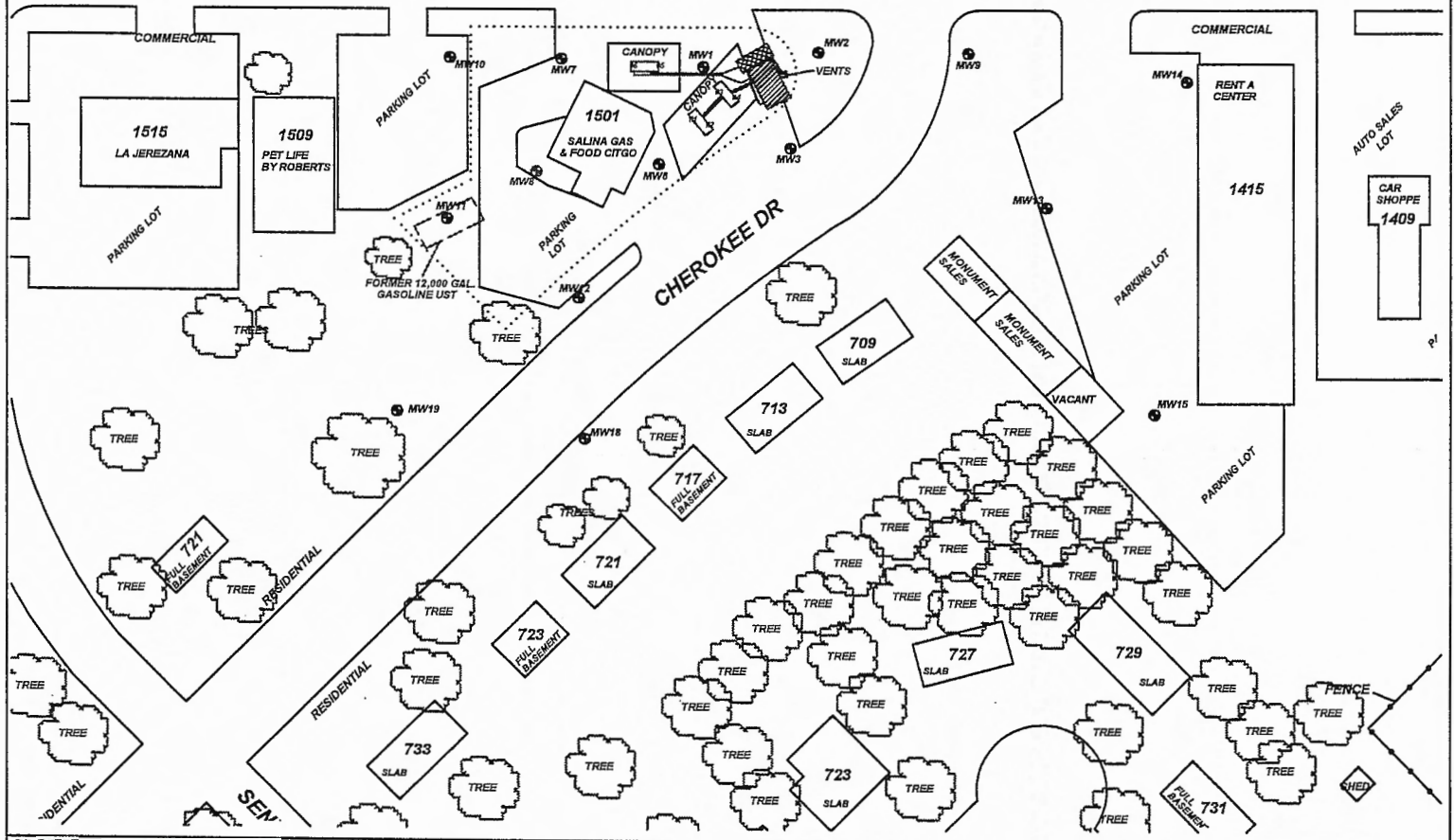

PROJECT: Salina Gas and Food LLC

ADDRESS: 1501 W. Crawford Ave.

LOCATION: Salina, KS

DRAWN BY: B. Scott **DATE:** 02/27/13

REVISED BY: C. Roe **DATE:** 12/13/13

AEI JOB #: TF457 **KDHE JOB #:** U5-085-14472

SCALE: 1" = 100'

NOTES:

TITLE: Figure 2.1
Site Map
350' Radius

ASSOCIATED ENVIRONMENTAL INC.

LEGEND:

- = (3) 8,000 GAL. GASOLINE USTs
- = 4,000 GAL. DIESEL UST
- = PUMPS AND PRODUCT LINES
- = MONITOR WELL
- = PLUGGED MONITOR WELL
- = SUBJECT PROPERTY