

WATER WELL PLUGGING RECORD Form WWC-5P

KSA 82a-1212

ID NO.

MW-3

1 LOCATION OF WATER WELL: County: Saline	Fraction NW ¼ SE ¼ SW ¼ NW ¼	Section Number 13	Township Number T 14 S	Range Number 3 <input type="checkbox"/> E <input checked="" type="checkbox"/> W																																																
Street/Rural Address of Well Location; if unknown, distance & direction from nearest town or intersection: If at owner's address, check here <input type="checkbox"/> 303 S. Santa Fe Salina, KS		Global Positioning Systems (GPS) information: Latitude: 38.83581 (in decimal degrees) Longitude: 97.60945 (in decimal degrees) Elevation: 1226.49 TOC Horizontal Datum: <input type="checkbox"/> WGS84, <input checked="" type="checkbox"/> NAD83, <input type="checkbox"/> NAD27 Collection Method:																																																		
2 WATER WELL OWNER: KDHE-BER RR#, St. Address, Box #: 1000 SW Jackson City, State ZIP Code: Topeka, KS 66612		<input type="checkbox"/> GPS unit (Make/Model: _____) <input type="checkbox"/> Digital Map/Photo, <input type="checkbox"/> Topographic Map, <input checked="" type="checkbox"/> Land Survey Est. Accuracy: <input checked="" type="checkbox"/> < 3 m, <input type="checkbox"/> 3-5 m, <input type="checkbox"/> 5-15 m, <input type="checkbox"/> > 15 m																																																		
3 MARK WELL'S LOCATION WITH AN "X" IN SECTION BOX: <div style="text-align: center;"> </div>	4 DEPTH OF WELL 46.31 ft. WELL'S STATIC WATER LEVEL 33.94 ft. WELL WAS USED AS: <div style="display: flex; justify-content: space-between;"> <div> <input type="checkbox"/> Domestic <input type="checkbox"/> Irrigation <input type="checkbox"/> Feedlot <input type="checkbox"/> Industrial </div> <div> <input type="checkbox"/> Public Water Supply <input type="checkbox"/> Oil Field Water Supply <input type="checkbox"/> Domestic (Lawn & Garden) <input type="checkbox"/> Air Conditioning </div> <div> <input type="checkbox"/> Dewatering <input checked="" type="checkbox"/> Monitoring <input type="checkbox"/> Injection Well <input type="checkbox"/> Other _____ </div> </div> Was a chemical/bacteriological sample submitted to Department? Yes <input type="checkbox"/> No <input checked="" type="checkbox"/>																																																			
5 TYPE OF BLANK CASING USED: <div style="display: flex; justify-content: space-between;"> <div> <input type="checkbox"/> Steel <input checked="" type="checkbox"/> PVC </div> <div> <input type="checkbox"/> RMP (SR) <input type="checkbox"/> ABS </div> <div> <input type="checkbox"/> Wrought <input type="checkbox"/> Asbestos-Cement </div> <div> <input type="checkbox"/> Fiberglass <input type="checkbox"/> Concrete Tile </div> <div> <input type="checkbox"/> Other (Specify below) _____ </div> </div> Blank casing diameter 2 in. Was casing pulled? Yes <input checked="" type="checkbox"/> No <input type="checkbox"/> If yes, how much 3 Ft Casing height above or below land surface _____ in.																																																				
6 GROUT PLUG MATERIAL: <input type="checkbox"/> Neat cement <input type="checkbox"/> Cement grout <input checked="" type="checkbox"/> Bentonite <input type="checkbox"/> Other _____ Grout Plug Intervals: From 3 ft. to 46.31 ft., From _____ ft. to _____ ft., From _____ ft. to _____ ft. What is the nearest source of possible contamination: <div style="display: flex; justify-content: space-between;"> <div> <input type="checkbox"/> Septic tank <input checked="" type="checkbox"/> Sewer lines <input type="checkbox"/> Watertight sewer lines <input type="checkbox"/> Lateral lines <input type="checkbox"/> Cess pool </div> <div> <input type="checkbox"/> Seepage pit <input type="checkbox"/> Pit privy <input type="checkbox"/> Sewage lagoon <input type="checkbox"/> Feedyard <input type="checkbox"/> Livestock pens </div> <div> <input type="checkbox"/> Fuel storage <input type="checkbox"/> Fertilizer storage <input type="checkbox"/> Insecticide storage <input type="checkbox"/> Abandoned water well <input type="checkbox"/> Oil well/Gas well </div> <div> <input type="checkbox"/> Other (specify below) _____ Direction from well? North How many feet? 30 </div> </div> <table border="1" style="width:100%; border-collapse: collapse; margin-top: 10px;"> <thead> <tr> <th>FROM</th> <th>TO</th> <th>PLUGGING MATERIALS</th> <th>FROM</th> <th>TO</th> <th>PLUGGING MATERIALS</th> </tr> </thead> <tbody> <tr> <td>0</td> <td>0.5</td> <td>Asphalt</td> <td></td> <td></td> <td></td> </tr> <tr> <td>0.5</td> <td>3</td> <td>Compacted silt/clay</td> <td></td> <td></td> <td></td> </tr> <tr> <td>3</td> <td>46.31</td> <td>Hydrated Bentonite chips</td> <td></td> <td></td> <td>U5-085-14485; Taco Johns</td> </tr> <tr><td> </td><td> </td><td> </td><td> </td><td> </td><td> </td></tr> <tr><td> </td><td> </td><td> </td><td> </td><td> </td><td> </td></tr> <tr><td> </td><td> </td><td> </td><td> </td><td> </td><td> </td></tr> <tr><td> </td><td> </td><td> </td><td> </td><td> </td><td> </td></tr> </tbody> </table>					FROM	TO	PLUGGING MATERIALS	FROM	TO	PLUGGING MATERIALS	0	0.5	Asphalt				0.5	3	Compacted silt/clay				3	46.31	Hydrated Bentonite chips			U5-085-14485; Taco Johns																								
FROM	TO	PLUGGING MATERIALS	FROM	TO	PLUGGING MATERIALS																																															
0	0.5	Asphalt																																																		
0.5	3	Compacted silt/clay																																																		
3	46.31	Hydrated Bentonite chips			U5-085-14485; Taco Johns																																															
7 CONTRACTOR'S OR LANDOWNER'S CERTIFICATION: This water well was plugged under my jurisdiction and was completed on (mo/day/year) 8/13/19 and this record is true to the best of my knowledge and belief. Kansas Water Well Contractor's License No. 585. This Water Well Record was completed on (mo/day/year) 9/9/19 under the business name of Associated Environmental, Inc. by (signature)																																																				

Send one white copy to Kansas Department of Health & Environment, Geology Section, 1000 SW Jackson Street, Ste. 420, Topeka, KS 66612-1367. Send one copy to WATER WELL OWNER and retain one for your records.
 Visit us at <http://www.kdheks.gov/waterwell/index.html> Telephone 785-296-5524.

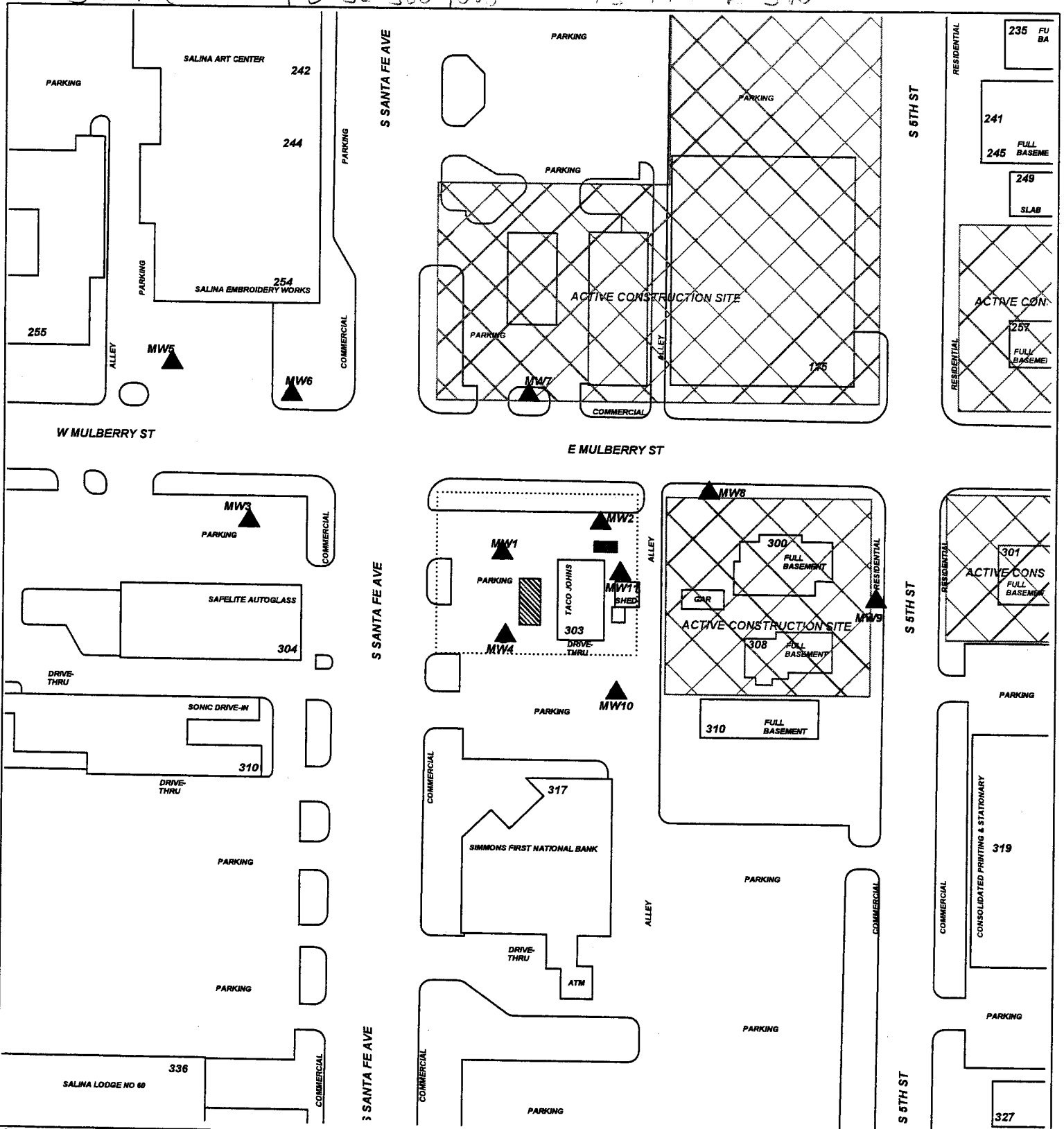

PROJECT: **TACO JOHNS**

ADDRESS: **303 S. SANTA FE**

LOCATION: **SALINA, KS**

DRAWN BY: **B. STALNAKER** DATE: **1/31/19**

REVISED BY: **B. STALNAKER** DATE: **3/26/19**

AE JOB #: **TM244** KDHE JOB #: **U5-085-14485**

TITLE:

ASSOCIATED ENVIRONMENTAL INC.

LEGEND:

- = FORMER UST BASIN
- = MONITORING WELL
- = PLUGGED/DESTROYED WELL
- = SUBJECT PROPERTY

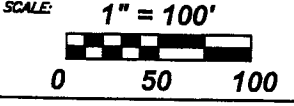

NOTES: