

WATER WELL PLUGGING RECORD Form WWC-5P

KSA 82a-1212

ID NO.

MW-5

1 LOCATION OF WATER WELL: County: Saline	Fraction NW ¼ SE ¼ SW ¼ NW ¼	Section Number 13	Township Number T 14 S	Range Number 3 <input type="checkbox"/> E <input checked="" type="checkbox"/> W
--	---------------------------------	----------------------	---------------------------	--

Street/Rural Address of Well Location; if unknown, distance & direction from nearest town or intersection: If at owner's address, check here ☐ 303 S. Santa Fe Salina, KS

Global Positioning Systems (GPS) information:

Latitude: 38.83606 (in decimal degrees)
 Longitude: 97.60965 (in decimal degrees)
 Elevation: 1226.44 TOC
 Horizontal Datum: ☐ WGS84, ☒ NAD83, ☐ NAD27
 Collection Method:

2 WATER WELL OWNER: KDHE-BER
 RR#, St. Address, Box #: 1000 SW Jackson
 City, State ZIP Code: Topeka, KS 66612

☐ GPS unit (Make/Model: _____)
☐ Digital Map/Photo, ☐ Topographic Map, ☒ Land Survey
 Est. Accuracy: ☒ < 3 m, ☐ 3-5 m, ☐ 5-15 m, ☐ > 15 m

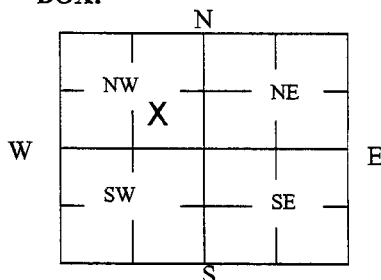
3 MARK WELL'S LOCATION WITH AN "X" IN SECTION BOX:**4 DEPTH OF WELL** 47.58 **ft.**WELL'S STATIC WATER LEVEL 33.83 **ft.**

WELL WAS USED AS:

<input type="checkbox"/> Domestic	<input type="checkbox"/> Public Water Supply	<input type="checkbox"/> Dewatering
<input type="checkbox"/> Irrigation	<input type="checkbox"/> Oil Field Water Supply	<input checked="" type="checkbox"/> Monitoring
<input type="checkbox"/> Feedlot	<input type="checkbox"/> Domestic (Lawn & Garden)	<input type="checkbox"/> Injection Well
<input type="checkbox"/> Industrial	<input type="checkbox"/> Air Conditioning	<input type="checkbox"/> Other _____

Was a chemical/bacteriological sample submitted to Department? Yes ☐ No ☒

5 TYPE OF BLANK CASING USED:

☒ Steel ☐ RMP (SR) ☐ Wrought ☐ Fiberglass ☐ Other (Specify below)
☒ PVC ☐ ABS ☐ Asbestos-Cement ☐ Concrete Tile

Blank casing diameter 2 in. Was casing pulled? Yes ☒ No ☐ If yes, how much 3 Ft
 Casing height above or below land surface in.

6 GROUT PLUG MATERIAL: ☐ Neat cement ☐ Cement grout ☒ Bentonite ☐ Other _____

Grout Plug Intervals: From 3 ft. to 47.58 ft., From _____ ft. to _____ ft., From _____ ft. to _____ ft.

What is the nearest source of possible contamination:

<input type="checkbox"/> Septic tank	<input type="checkbox"/> Seepage pit	<input type="checkbox"/> Fuel storage	<input type="checkbox"/> Other (specify below) _____
<input checked="" type="checkbox"/> Sewer lines	<input type="checkbox"/> Pit privy	<input type="checkbox"/> Fertilizer storage	
<input type="checkbox"/> Watertight sewer lines	<input type="checkbox"/> Sewage lagoon	<input type="checkbox"/> Insecticide storage	
<input type="checkbox"/> Lateral lines	<input type="checkbox"/> Feedyard	<input type="checkbox"/> Abandoned water well	
<input type="checkbox"/> Cess pool	<input type="checkbox"/> Livestock pens	<input type="checkbox"/> Oil well/Gas well	

Direction from well? South
 How many feet? 130

FROM	TO	PLUGGING MATERIALS	FROM	TO	PLUGGING MATERIALS
0	0.5	Asphalt			
0.5	3	Compacted silt/clay			
3	47.58	Hydrated Bentonite chips			U5-085-14485; Taco Johns

7 CONTRACTOR'S OR LANDOWNER'S CERTIFICATION: This water well was plugged under my jurisdiction and was completed on (mo/day/year) 8/13/19 and this record is true to the best of my knowledge and belief. Kansas Water Well Contractor's License No. 585. This Water Well Record was completed on (mo/day/year) 9/19/19 under the business name of Associated Environmental, Inc. by (signature) _____

Send one white copy to Kansas Department of Health & Environment, Geology Section, 1000 SW Jackson Street, Ste. 420, Topeka, KS 66612-1367. Send one copy to WATER WELL OWNER and retain one for your records.

Visit us at <http://www.kdheks.gov/waterwell/index.html> Telephone 785-296-5524.

KSA82a-1212

Revised 1/20/2015

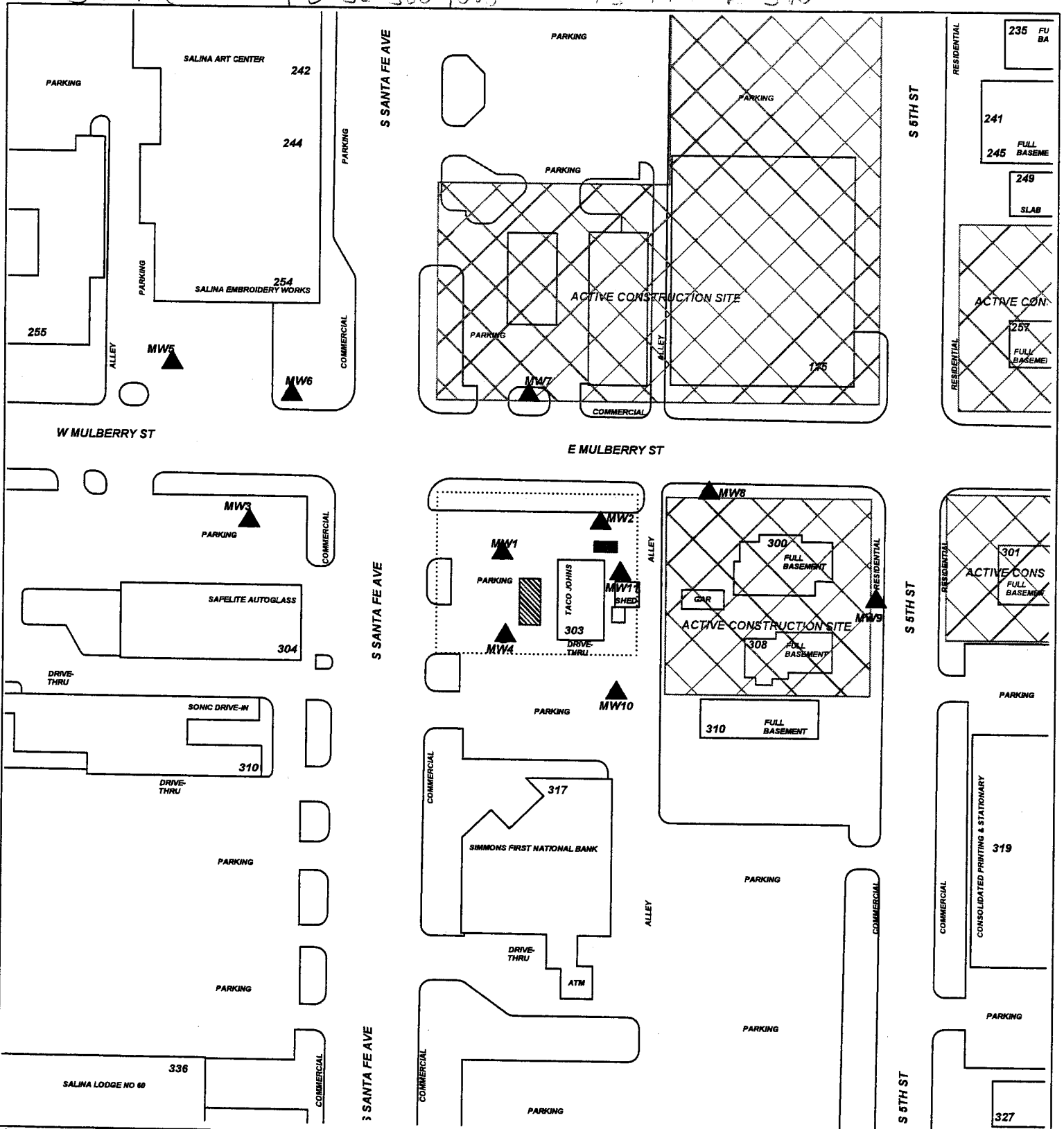

PROJECT: **TACO JOHNS**

ADDRESS: **303 S. SANTA FE**

LOCATION: **SALINA, KS**

DRAWN BY: **B. STALNAKER** DATE: **1/31/19**

REVISED BY: **B. STALNAKER** DATE: **3/26/19**

AE JOB #: **TM244** KDHE JOB #: **U5-085-14485**

TITLE:

ASSOCIATED ENVIRONMENTAL INC.

LEGEND:

- = FORMER UST BASIN
- = MONITORING WELL
- = PLUGGED/DESTROYED WELL
- = SUBJECT PROPERTY

SCALE: **1" = 100'**

NOTES: